

TRAFFIC SIGNALS LEGEND

EX. TRAFFIC SIGNAL CONTROLLER CABINET	PROP. 3 SEC. SIGNAL HEAD W/BACKPLATE	EX. 1/C NO. 6 CABLE
EX. ELECTRIC SERVICE	PROP. 4 SEC. SIGNAL HEAD W/BACKPLATE	EX. NO. 18 3-PR DETECTOR LOOP CABLE
PROP. LED LUMINARE	PROP. PEDESTRIAN SIGNAL HEAD	PROP. 5/C NO. 14 SIGNAL CABLE
EX. QUADRAPOLE DETECTOR LOOP	PROP. PEDESTRIAN PUSHBUTTON	PROP. 7/C NO. 14 SIGNAL CABLE
EX. DETECTOR LOOP	PROP. GROUND/SAFETY BOND	PROP. 1/C NO. 6 CABLE X 2
	EX. GROUND/SAFETY BOND	

NOTES:
 1. THE CONTRACTOR SHALL FURNISH ONE 20A 1-POLE CIRCUIT BREAKER, BUTTON PHOTOCELL, TERMINAL BLOCK WIRING, AND ALL OTHER ITEMS REQUIRED TO PROVIDE PHOTOCELL-CONTROLLER POWER TO THE PROPOSED LUMINAIRES AT FARMINGTON RD. & MAXWELL RD. THESE ITEMS SHALL BE INSTALLED IN THE EXISTING TRAFFIC SIGNAL CABINET. THE COST OF THIS WORK SHALL BE INCLUDED IN THE COST OF THE PROPOSED DUAL MAST ARM ASSEMBLY.

NOT TO SCALE

**STATE OF ILLINOIS
DEPARTMENT OF TRANSPORTATION**

**PROPOSED CABLE & PHASE DIAGRAMS
FARMINGTON RD. & MAXWELL RD. - PEORIA**

F.A. RTE.	SECTION	COUNTY	TOTAL SHEETS	SHEET NO.
VAR.	MA-1 MAST ARM REPLACEMENT 2021	PEORIA	40	12
CONTRACT NO. 68G54			ILLINOIS FED. AID PROJECT	

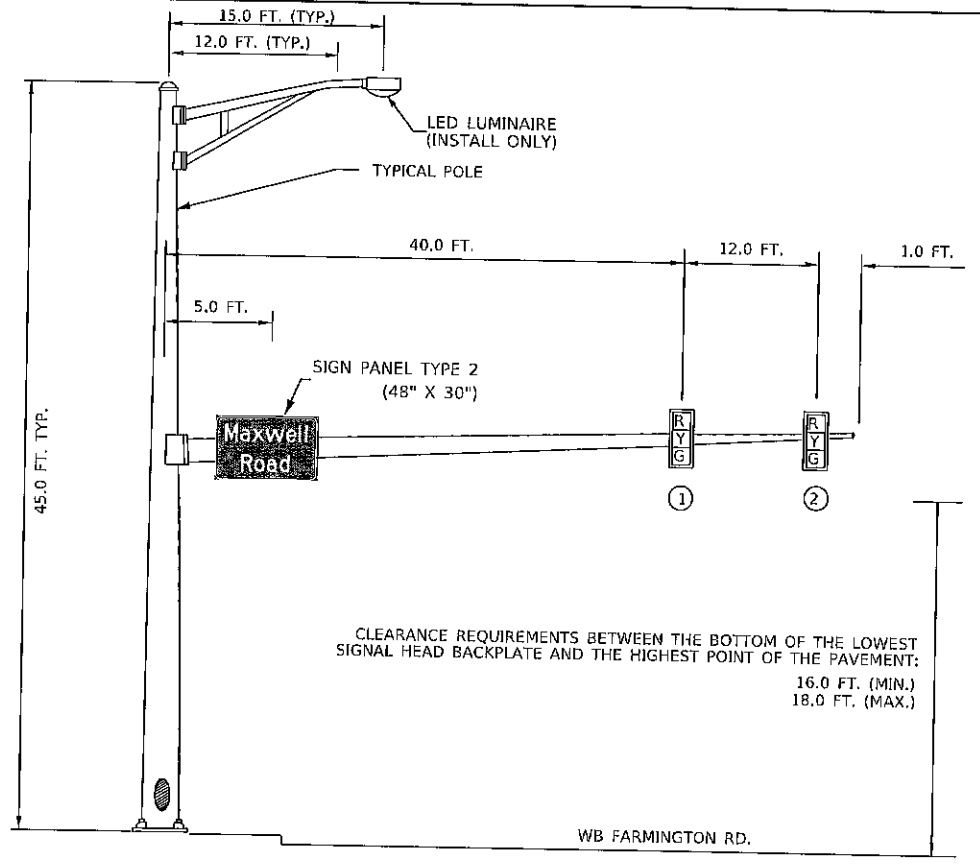

MA-1 54'

EASTBOUND TRAFFIC SIGNAL
NORTHEAST QUADRANT

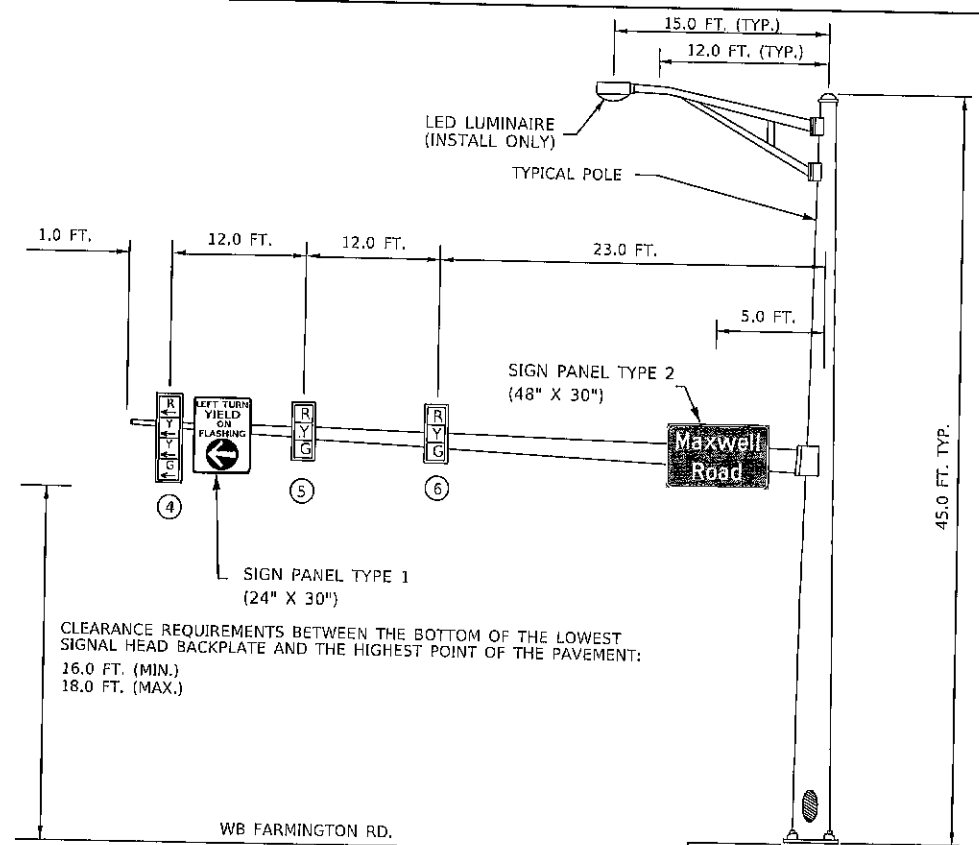

WESTBOUND TRAFFIC SIGNAL
NORTHWEST QUADRANT

MA-2 48'
(DUAL MAST ARM STRUCTURE)

- NOTES:
1. THE CONTRACTOR SHALL RELOCATE ALL OTHER EXISTING SIGNS FROM THE REMOVED MAST ARMS AND TRAFFIC SIGNAL POSTS TO THE PROPOSED MAST ARMS AND TRAFFIC SIGNAL POSTS. THIS WORK WILL NOT BE PAID FOR SEPARATELY BUT SHALL BE INCLUDED IN THE COST OF THE PROPOSED MAST ARMS AND TRAFFIC SIGNAL POSTS.
 2. ALL PROPOSED SIGNS SHALL INCLUDE THE BLOCK NUMBERING AT THE BOTTOM OF THE SIGN.

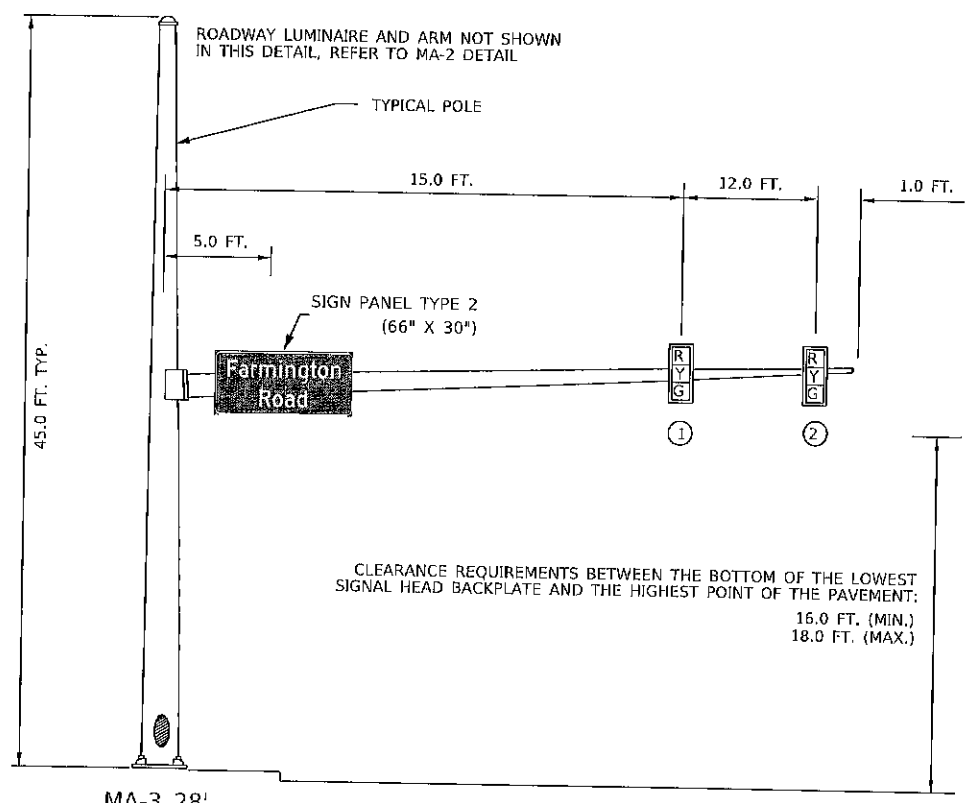

MA-3 28'
(DUAL MAST ARM STRUCTURE)

NORTHBOUND TRAFFIC SIGNAL
NORTH OF INTERSECTION

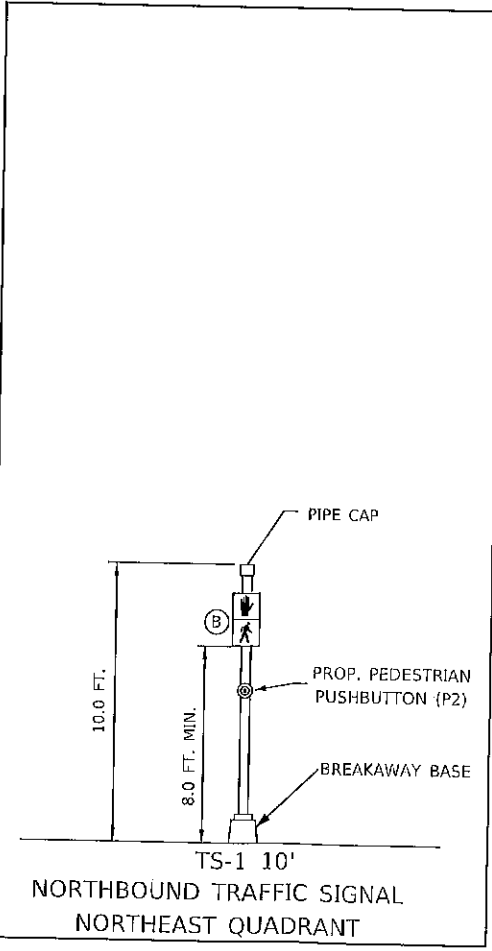

TS-1 10'
NORTHBOUND TRAFFIC SIGNAL
NORTHEAST QUADRANT

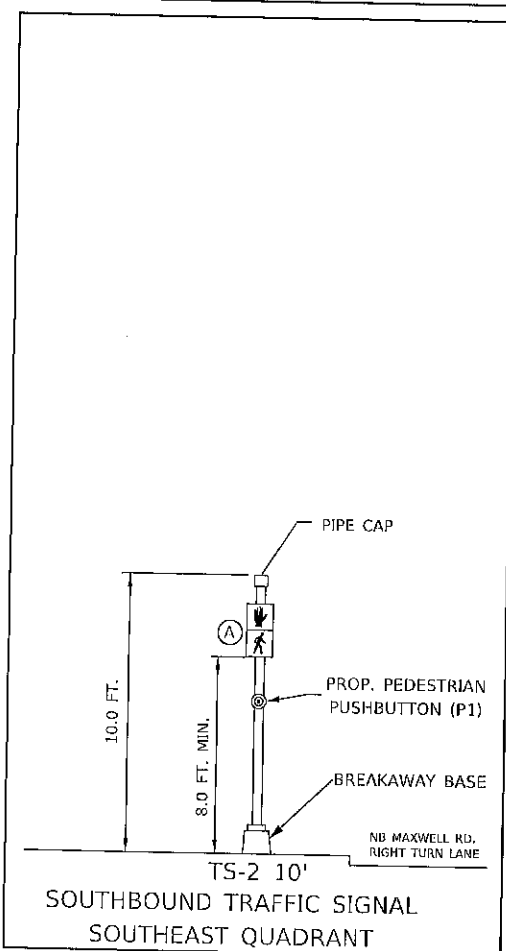

TS-2 10'
SOUTHBOUND TRAFFIC SIGNAL
SOUTHEAST QUADRANT

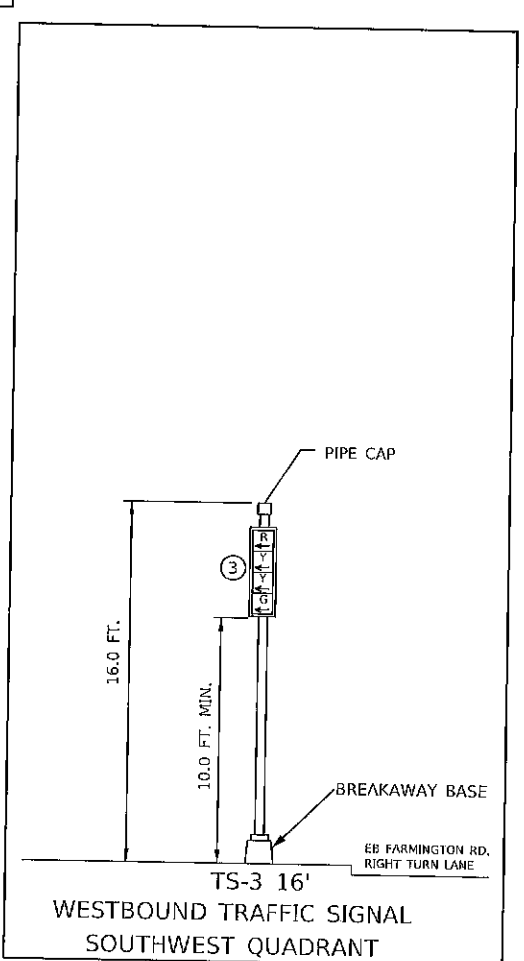

TS-3 16'
WESTBOUND TRAFFIC SIGNAL
SOUTHWEST QUADRANT

NOT TO SCALE

MODIFIED: Debut
 FILE: M:\GIS\Documents\GEN\Transfer - Bureau\68G54 - Farmington Arm Replacement 2021_FINAL (03-18-21).dgn

USER NAME = hansonj	DESIGNED -	REVISED -
PLOT SCALE = 23.8272" = 1" in.	DRAWN -	REVISED -
PLOT DATE = 3/19/2021	CHECKED -	REVISED -
	DATE -	REVISED -

STATE OF ILLINOIS
DEPARTMENT OF TRANSPORTATION

PROPOSED MAST ARM AND TRAFFIC SIGNAL POST DETAILS
FARMINGTON RD. & MAXWELL RD. - PEORIA

SCALE: SHEET OF SHEETS STA. TO STA.

F.A. RTE.	SECTION	COUNTY	TOTAL SHEETS	SHEET NO.
VAR.	D4 MAST ARM REPLACEMENT 2021	PEORIA	40	13
CONTRACT NO. 68G54			ILLINOIS FED. AID PROJECT	

IL 8 (FARMINGTON) & MAIN - REMOVAL	
REMOVE EXISTING TRAFFIC SIGNAL EQUIPMENT - QTY. 1 EACH (INCLUDES ALL ITEMS LISTED BELOW)	
THE FOLLOWING ITEMS SHALL BE REMOVED AND DISPOSED OF BY THE CONTRACTOR OFF OF THE RIGHT-OF-WAY. THE SALVAGE VALUE OF THIS EQUIPMENT SHALL BE REFLECTED IN THE UNIT BID PRICE FOR "REMOVE EXISTING TRAFFIC SIGNAL EQUIPMENT."	
QTY.	DESCRIPTION
4.0	TRAFFIC SIGNAL POST
2.0	TRAFFIC SIGNAL MAST ARM
4.0	SIGNAL HEAD, 1-FACE, 3-SECTION, MAST ARM MOUNTED
4.0	SIGNAL HEAD, 1-FACE, 3-SECTION, BRACKET MOUNTED
1.0	SIGNAL HEAD, 1-FACE, 4-SECTION, MAST ARM MOUNTED
3.0	SIGNAL HEAD, 1-FACE, 4-SECTION, BRACKET MOUNTED
4.0	PEDESTRIAN PUSHBUTTON
2.0	PEDESTRIAN SIGNAL HEAD, LED, 1-FACE, BRACKET MOUNTED
2.0	PEDESTRIAN SIGNAL HEAD, LED, 2-FACE, BRACKET MOUNTED
ALL	TRAFFIC SIGNAL CABLING NOT USED IN PROP. INSTALLATION

IL 8 (FARMINGTON) & MAIN - REMOVAL		
BILL OF MATERIALS		
ITEM DESCRIPTION	UNIT	QTY.
REMOVE EXISTING CONCRETE FOUNDATION	EACH	1.0
REMOVE EXISTING TRAFFIC SIGNAL EQUIPMENT	EACH	1.0



NOTES:
 1. THE EXISTING LOOP LEAD-IN CABLES SHALL REMAIN INTACT AND OPERATIONAL FOR THE PROPOSED DESIGN.

MODEL: Default
 FILE NAME: C:\common\GENTransfer - burbanet\SG54 - Final Plans\SG54 04 Main Arm Replacement 2021 FINAL (03-14-21).dgn

USER NAME = hansonj	DESIGNED -	REVISED -
PLOT SCALE = 23,8272' / in.	DRAWN -	REVISED -
PLOT DATE = 3/19/2021	CHECKED -	REVISED -
	DATE -	REVISED -

STATE OF ILLINOIS
 DEPARTMENT OF TRANSPORTATION

EXISTING TRAFFIC SIGNAL PLANS & REMOVAL ITEMS
 IL 8 (FARMINGTON RD.) & MAIN ST. - PEORIA

SCALE: SHEET OF SHEETS STA. TO STA.

F.A. RTE.	SECTION	COUNTY	TOTAL SHEETS	SHEET NO.
VAR.	DIMENSIONAL BRIDGE/ROADWAY	PEORIA	40	14
CONTRACT NO. 68GS4				
ILLINOIS FED. AID PROJECT				

NOT TO SCALE

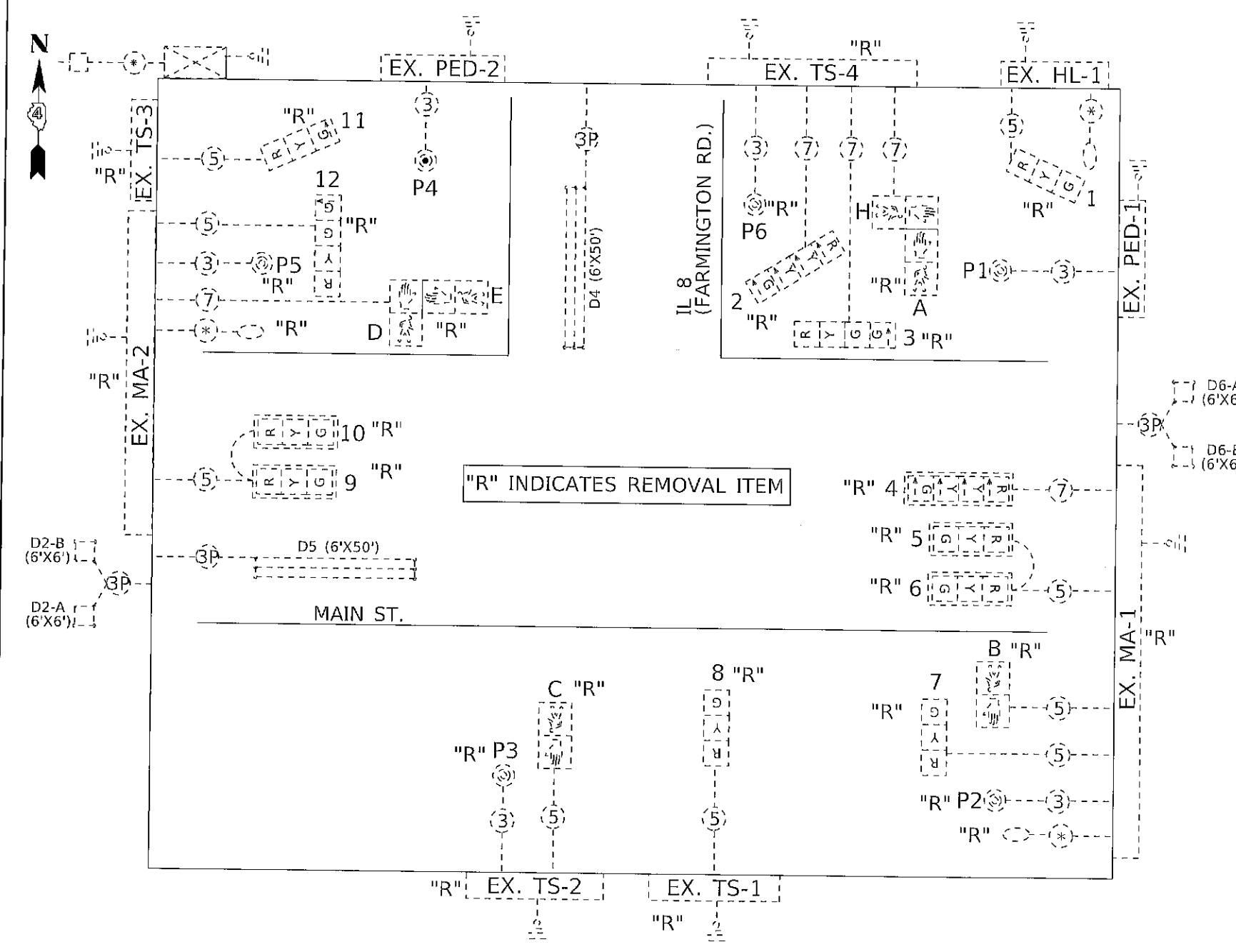
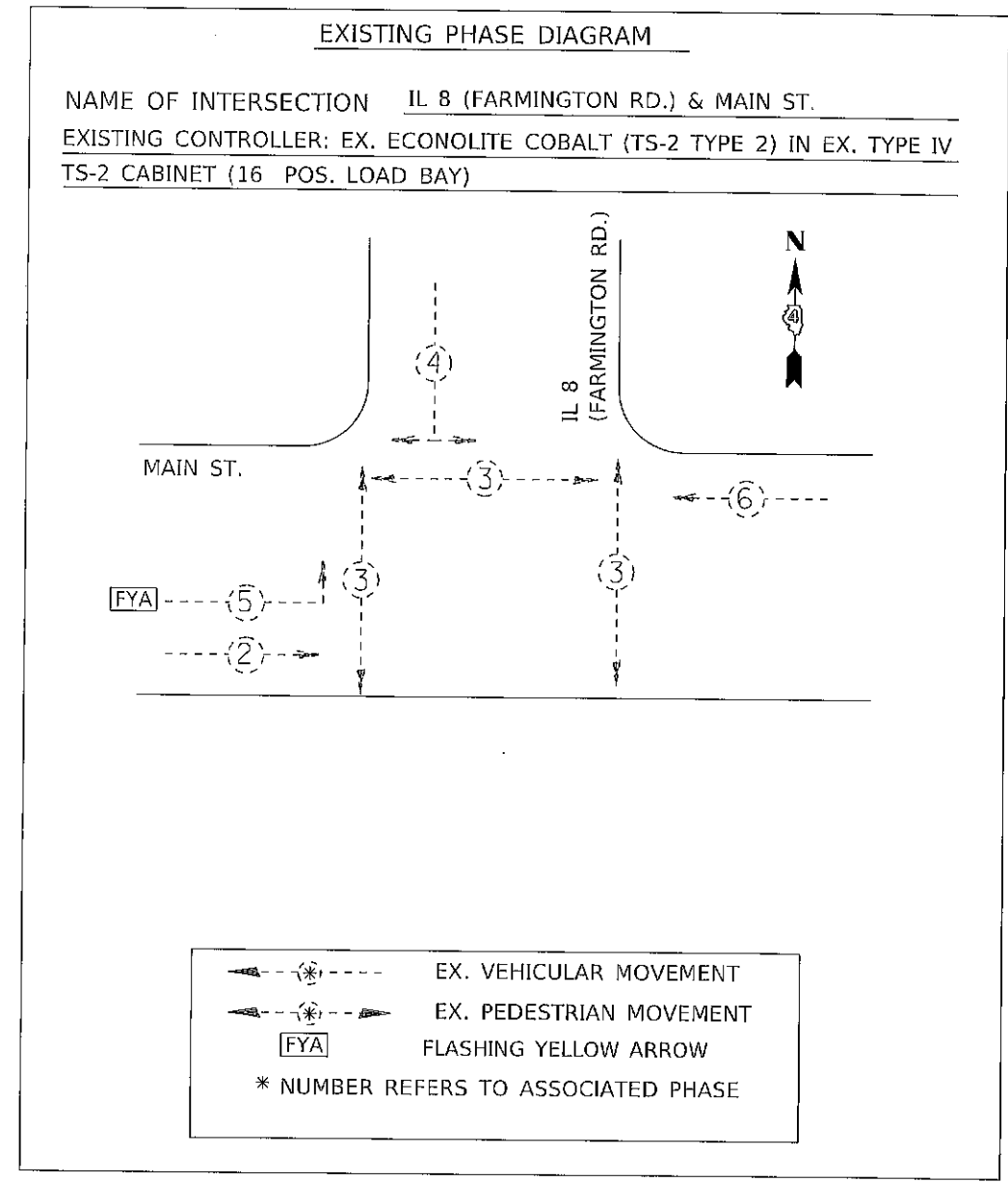

TRAFFIC SIGNALS LEGEND

<p> EX. TRAFFIC SIGNAL CONTROLLER CABINET</p> <p> EX. ELECTRIC SERVICE</p> <p> EX. HPS LUMINAIRE</p> <p> EX. QUADRAPOLE DETECTOR LOOP</p> <p> EX. DETECTOR LOOP</p> <p> EX. GROUND/SAFETY BOND</p>	<p> EX. 3 SEC. SIGNAL HEAD W/BACKPLATE</p> <p> EX. 3 SEC. SIGNAL HEAD WITHOUT BACKPLATE</p> <p> EX. 4 SEC. SIGNAL HEAD W/BACKPLATE</p> <p> EX. 4 SEC. SIGNAL HEAD WITHOUT BACKPLATE</p> <p> EX. PEDESTRIAN SIGNAL HEAD</p> <p> EX. PEDESTRIAN PUSHBUTTON</p>	<p> EX. NO. 18 3-PR DETECTOR LOOP CABLE</p> <p> EX. 3/C NO. 14 SIGNAL CABLE</p> <p> EX. 5/C NO. 14 SIGNAL CABLE</p> <p> EX. 7/C NO. 14 SIGNAL CABLE</p> <p> EX. 1/C NO. 6 CABLE</p>
--	--	---

MODEL: default
 FILE NAME: D:\comm\gen\trans\trans - bureau\68G54 - Final Plans\68G54 - D4 Mast Arm Replacement 2021_FINAL (03-19-21).dgn

USER NAME = hansonf	DESIGNED -	REVISED -	
	DRAWN -	REVISED -	
PLOT SCALE = 23.8272" / in.	CHECKED -	REVISED -	
PLOT DATE = 3/19/2021	DATE -	REVISED -	

**STATE OF ILLINOIS
DEPARTMENT OF TRANSPORTATION**

**EXISTING CABLE & PHASE DIAGRAMS
IL 8 (FARMINGTON RD.) & MAIN ST. - PEORIA**

SCALE: SHEET OF SHEETS STA. TO STA.

F.A. RTE.	SECTION	COUNTY	TOTAL SHEETS	SHEET NO.
VAR.	D4 MAST ARM REPLACEMENT 2021	PEORIA	40	15
CONTRACT NO. 68G54				
ILLINOIS FED. AID PROJECT				

NOT TO SCALE

IL 8 (FARMINGTON) & MAIN - PROPOSED		
BILL OF MATERIALS		
ITEM DESCRIPTION	UNIT	QTY.
PORTLAND CEMENT CONCRETE SIDEWALK 4 INCH	SQ FT	15.0
SIDEWALK REMOVAL	SQ FT	15.0
SIGN PANEL - TYPE 1	SQ FT	13.8
SIGN PANEL - TYPE 2	SQ FT	27.6
UNDERGROUND CONDUIT, PVC, 1" DIA.	FOOT	15.0
UNDERGROUND CONDUIT, PVC, 3" DIA.	FOOT	129.0
HANDHOLE, PORTLAND CEMENT CONCRETE	EACH	1.0
ELECTRIC CABLE IN CONDUIT, 600V (XLP-TYPE USE) 1/C NO. 6	FOOT	655.0
LIGHT POLE, GALVANIZED STEEL, 45 FT. M.H., 12 FT. MAST ARM	EACH	1.0
ELECTRIC CABLE IN CONDUIT, SIGNAL NO. 14 3C	FOOT	626.5
ELECTRIC CABLE IN CONDUIT, SIGNAL NO. 14 5C	FOOT	1970.5
ELECTRIC CABLE IN CONDUIT, SIGNAL NO. 14 7C	FOOT	461.0
ELECTRIC CABLE IN CONDUIT, EQUIPMENT GROUNDING CONDUCTOR, NO. 6 1C	FOOT	179.5
TRAFFIC SIGNAL POST, GALVANIZED STEEL 10 FT.	EACH	2.0
TRAFFIC SIGNAL POST, GALVANIZED STEEL 16 FT.	EACH	2.0
PEDESTRIAN PUSH-BUTTON POST, GALVANIZED STEEL, TYPE I	EACH	1.0
STEEL MAST ARM ASSEMBLY AND POLE, 70 FT.	EACH	1.0
STEEL COMBINATION MAST ARM ASSEMBLY AND POLE 38 FT.	EACH	1.0
CONCRETE FOUNDATION, TYPE E 36-INCH DIAMETER	FOOT	11.0
CONCRETE FOUNDATION, TYPE E 42-INCH DIAMETER	FOOT	25.0
DRILL EXISTING FOUNDATION	EACH	1.0
DRILL EXISTING HANDHOLE	EACH	2.0
SIGNAL HEAD, POLYCARBONATE, LED, 1-FACE, 3-SECTION, BRACKET MOUNTED	EACH	4.0
SIGNAL HEAD, POLYCARBONATE, LED, 1-FACE, 3-SECTION, MAST ARM MOUNTED	EACH	4.0
SIGNAL HEAD, POLYCARBONATE, LED, 1-FACE, 4-SECTION, BRACKET MOUNTED	EACH	3.0
SIGNAL HEAD, POLYCARBONATE, LED, 1-FACE, 4-SECTION, MAST ARM MOUNTED	EACH	1.0
PEDESTRIAN SIGNAL HEAD, LED, 1-FACE, BRACKET MOUNTED	EACH	4.0
PEDESTRIAN SIGNAL HEAD, LED, 2-FACE, BRACKET MOUNTED	EACH	1.0
TRAFFIC SIGNAL BACKPLATE, RETROREFLECTIVE	EACH	12.0
PEDESTRIAN PUSH-BUTTON	EACH	4.0
MODIFY EXISTING CONCRETE FOUNDATION	EACH	2.0
ROADWAY LUMINAIRE, SPECIAL (INSTALL ONLY)	EACH	2.0
CONCRETE MEDIAN REMOVAL	SQ FT	42.0



- NOTES:
- THE EXISTING LOOP LEAD-IN CABLES SHALL REMAIN INTACT AND OPERATIONAL FOR THE PROPOSED DESIGN.
 - REFER TO SHEET 40 FOR THE PEDESTRIAN PUSHBUTTON DETAIL.
 - THE BOLT CIRCLE OF THE PROPOSE LIGHT POLE (HL-2) SHALL MATCH THE BOLT CIRCLE OF THE EXISTING MAST ARM FOUNDATION. THE CONTRACTOR SHALL VERIFY THE BOLT CIRCLE OF THE EXISTING MAST ARM PRIOR TO RELEASING MATERIAL.

IL 8 (FARMINGTON RD.) & MAIN ST. MAST ARM SCHEDULE			
REF	LOCATION	LENGTH	DESCRIPTION
MA-1	NE QUAD	70 FT.	S MAA & P
MA-2	NW QUAD	38 FT.	STL COMB MAA&P

IL 8 (FARMINGTON RD.) & MAIN ST. TRAFFIC SIGNAL HEAD SCHEDULE			
QTY.	UNIT	ITEM	LOCATION
4.0	EACH	SH P LED 1F 3S BM	1,7,8,11
4.0	EACH	SH P LED 1F 3S MAM	5,6,9,10
3.0	EACH	SH P LED 1F 4S BM	2,3,12
1.0	EACH	SH P LED 1F 4S MAM	4
12.0	EACH	TS BACKPLATE RET-REFL	1,2,3,4,5,6,7,8,9,10,11,12
4.0	EACH	PED SH LED 1F BM	A,B,C,F
1.0	EACH	PED SH LED 2F BM	D/E

MODEL: Default
 FILE NAME: C:\document\GENTransfer - Burdette\6854 - Final\Main\6854.dwg
 04 Misc: Arm Replacement 2021 FINAL (03-18-21).dgn

USFR NAME = hansonj	DESIGNED -	REVISED -
PLOT SCALE = 23.8272' / in.	DRAWN -	REVISED -
PLOT DATE = 3/19/2021	CHECKED -	REVISED -
	DATE -	REVISED -

STATE OF ILLINOIS
DEPARTMENT OF TRANSPORTATION

PROPOSED TRAFFIC SIGNAL PLANS
IL 8 (FARMINGTON RD.) & MAIN ST. - PEORIA

F.A. RTE.	SECTION	COUNTY	TOTAL SHEETS	SHEET NO.
VAR.	04 MAST ARM REPLACEMENT 2021	PEORIA	40	16
CONTRACT NO. 68G54				
ILLINOIS FED. AID PROJECT				

MODIFY: Default
 FILE NAME: CHCommentGENTraffic - Bureau\68654 - Final Plans\68654 D4 Mast Arm Replacement 2021_FINAL (03-19-21).dgn

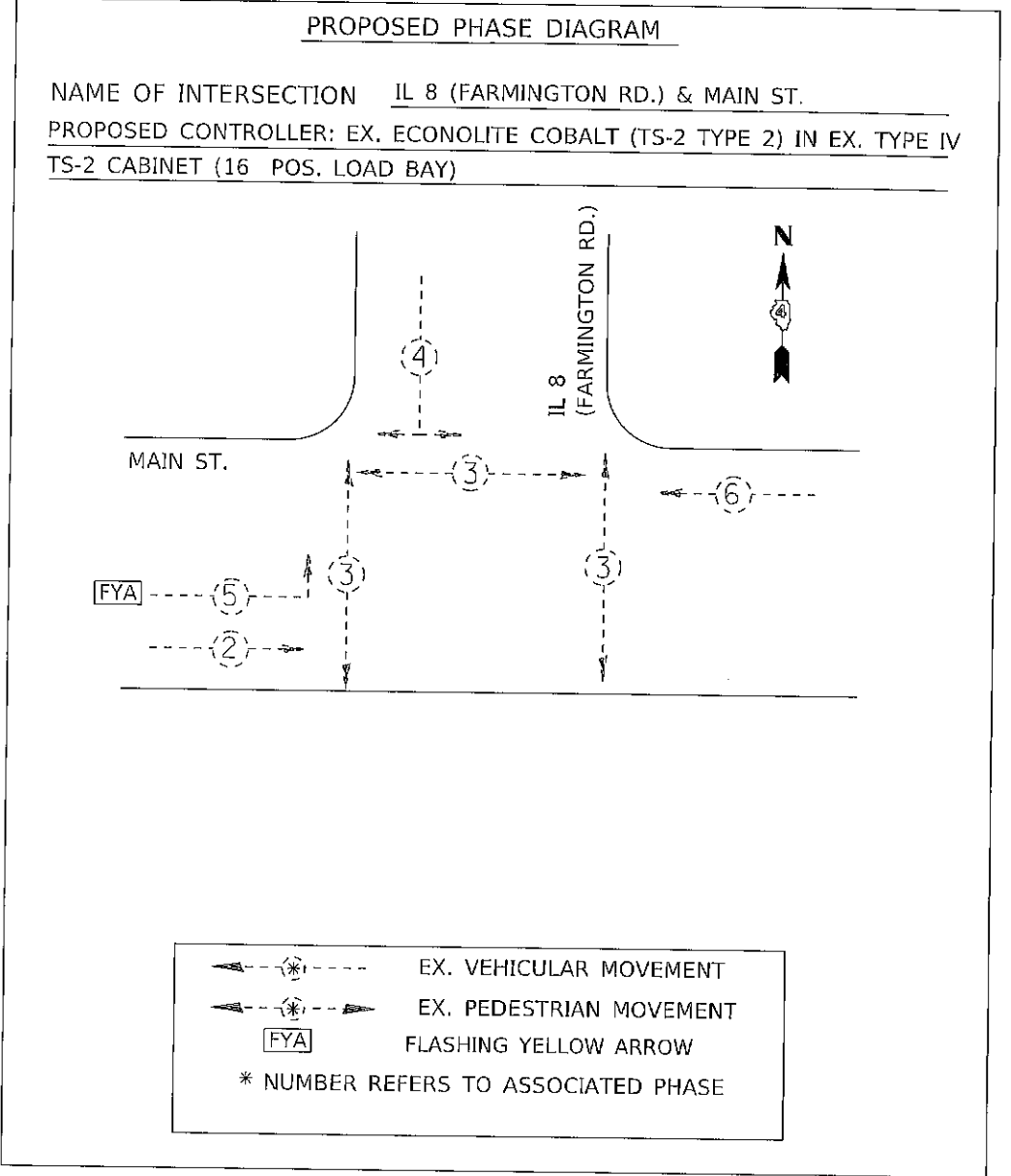
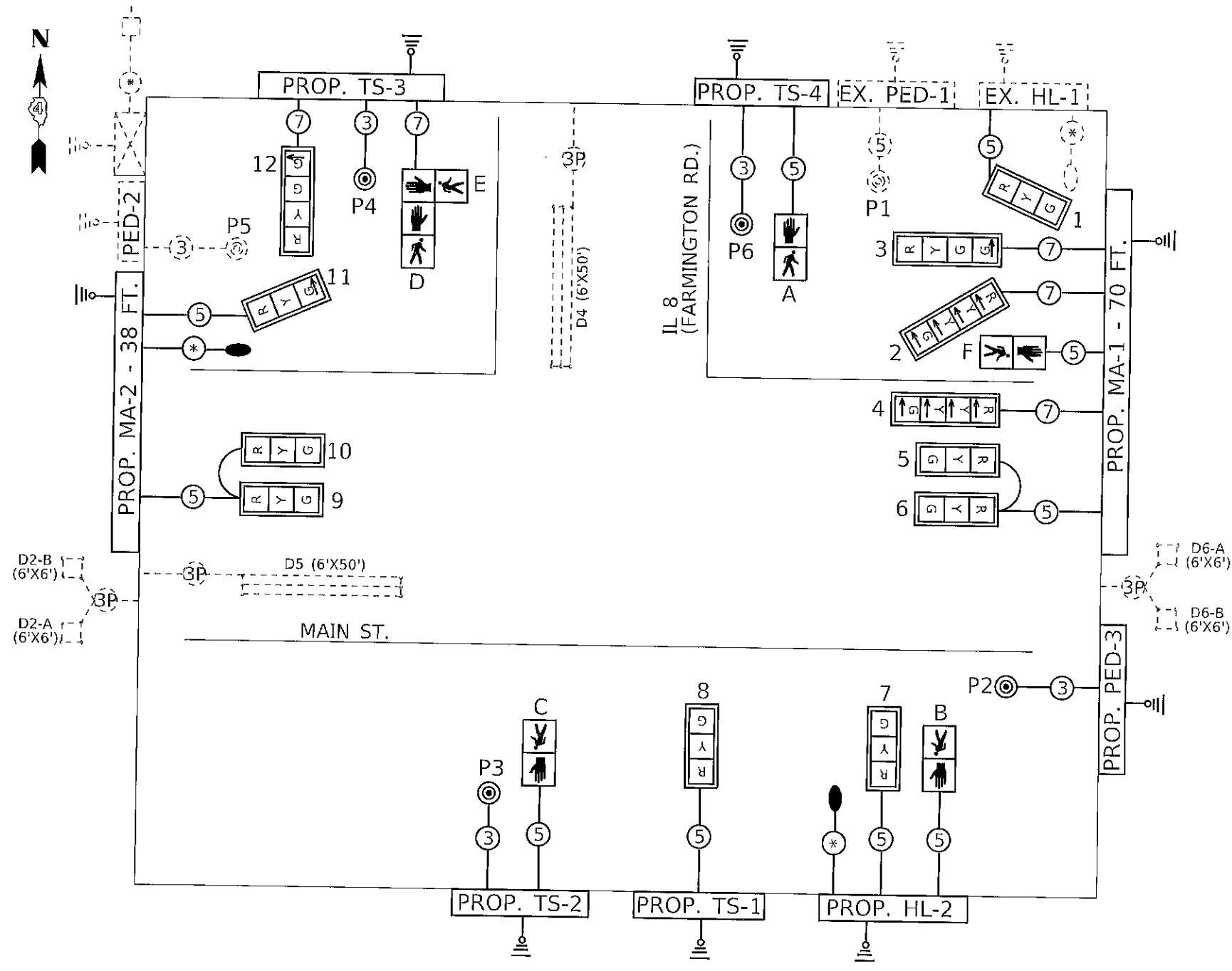

TRAFFIC SIGNALS LEGEND

- | | | |
|---|--|---|
| <ul style="list-style-type: none"> EX. TRAFFIC SIGNAL CONTROLLER CABINET EX. ELECTRIC SERVICE EX. HPS LUMINIARE PROP. LED LUMINIARE EX. QUADRAPOLE DETECTOR LOOP EX. DETECTOR LOOP | <ul style="list-style-type: none"> R Y G PROP. 3 SEC. SIGNAL HEAD W/BACKPLATE R Y G PROP. 4 SEC. SIGNAL HEAD W/BACKPLATE PROP. PEDESTRIAN SIGNAL HEAD EX. PEDESTRIAN PUSHBUTTON PROP. GROUND/SAFETY BOND EX. GROUND/SAFETY BOND | <ul style="list-style-type: none"> EX. 3/C NO. 14 SIGNAL CABLE EX. NO. 18 3-PR DETECTOR LOOP CABLE PROP. 3/C NO. 14 SIGNAL CABLE PROP. 5/C NO. 14 SIGNAL CABLE PROP. 7/C NO. 14 SIGNAL CABLE EX. 1/C NO. 6 CABLE EX. 1/C NO. 6 CABLE |
|---|--|---|

NOT TO SCALE

USER NAME = hansonj PLOT SCALE = 23,8272' / in. PLOT DATE = 3/19/2021	DESIGNED - DRAWN - CHECKED - DATE -	REVISED - REVISED - REVISED - REVISED -	STATE OF ILLINOIS DEPARTMENT OF TRANSPORTATION	PROPOSED CABLE & PHASE DIAGRAMS IL 8 (FARMINGTON RD.) & MAIN ST. - PEORIA	F.A. RTE. VAR.	SECTION COUNTY PEORIA	TOTAL SHEETS 40	SHEET NO. 17
SCALE: SHEET OF SHEETS STA. TO STA.				CONTRACT NO. 68G54		ILLINOIS FED. AID PROJECT		

INSTALLATION NOTE:
 SIGNAL HEAD 2 LOCATED FACING EASTBOUND TRAFFIC
 SIGNAL HEAD 3 LOCATED FACING WESTBOUND TRAFFIC

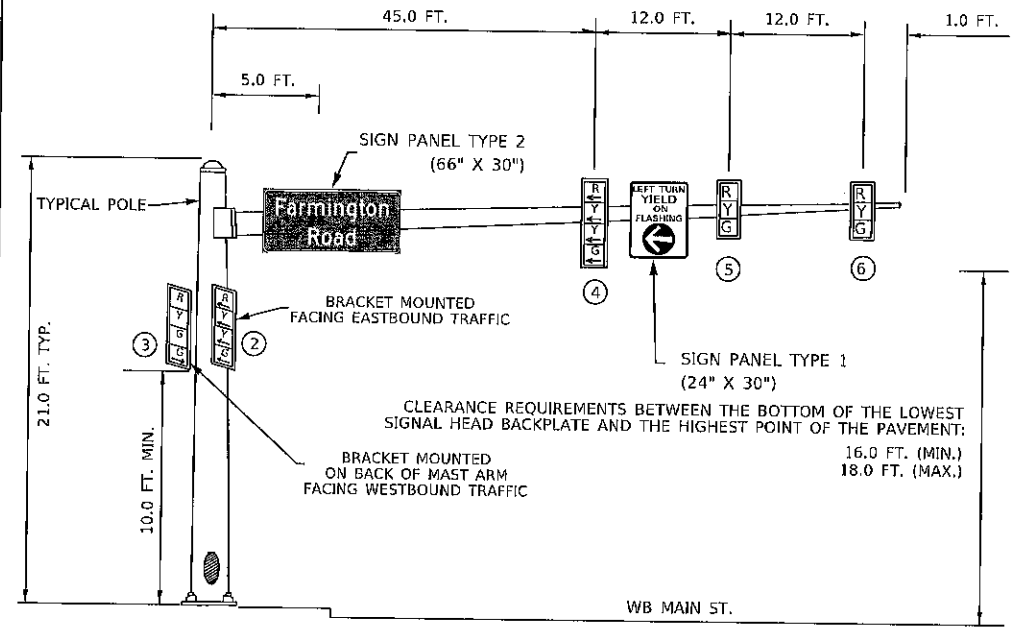

MA-1 70'
 EASTBOUND TRAFFIC SIGNAL
 NORTHEAST CORNER ISLAND

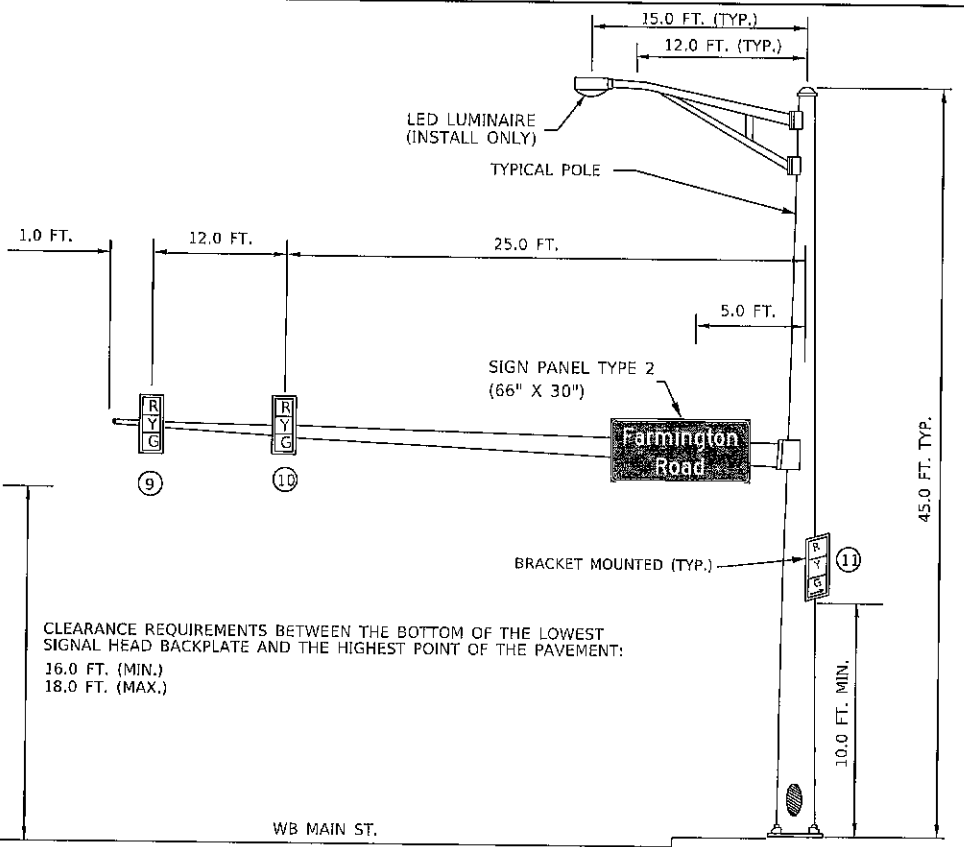

MA-2 38'
 WESTBOUND TRAFFIC SIGNAL
 NORTHWEST QUADRANT

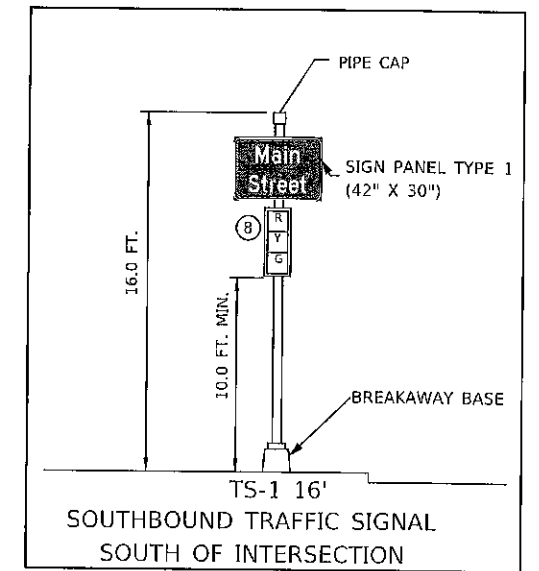

TS-1 16'
 SOUTHBOUND TRAFFIC SIGNAL
 SOUTH OF INTERSECTION

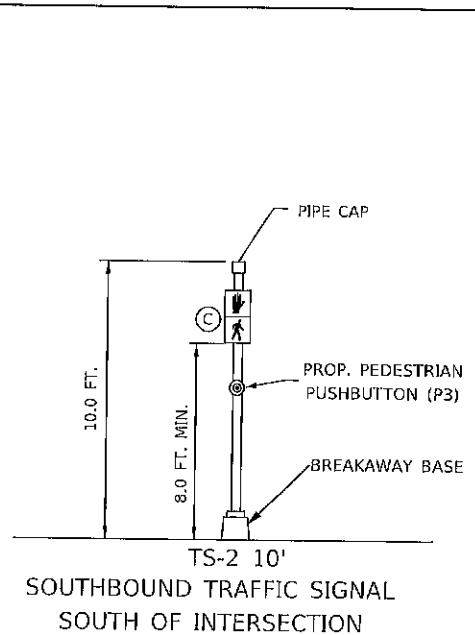

TS-2 10'
 SOUTHBOUND TRAFFIC SIGNAL
 SOUTH OF INTERSECTION

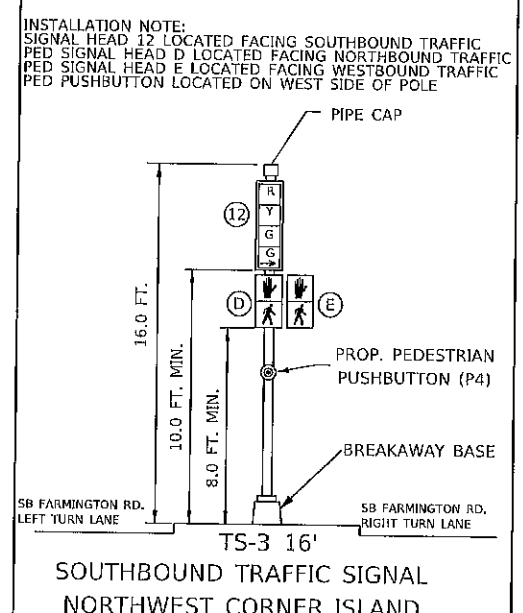

TS-3 16'
 SOUTHBOUND TRAFFIC SIGNAL
 NORTHWEST CORNER ISLAND

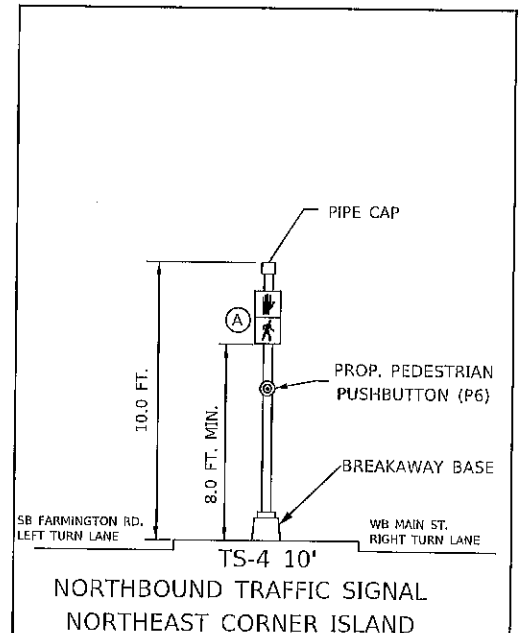

TS-4 10'
 NORTHBOUND TRAFFIC SIGNAL
 NORTHEAST CORNER ISLAND

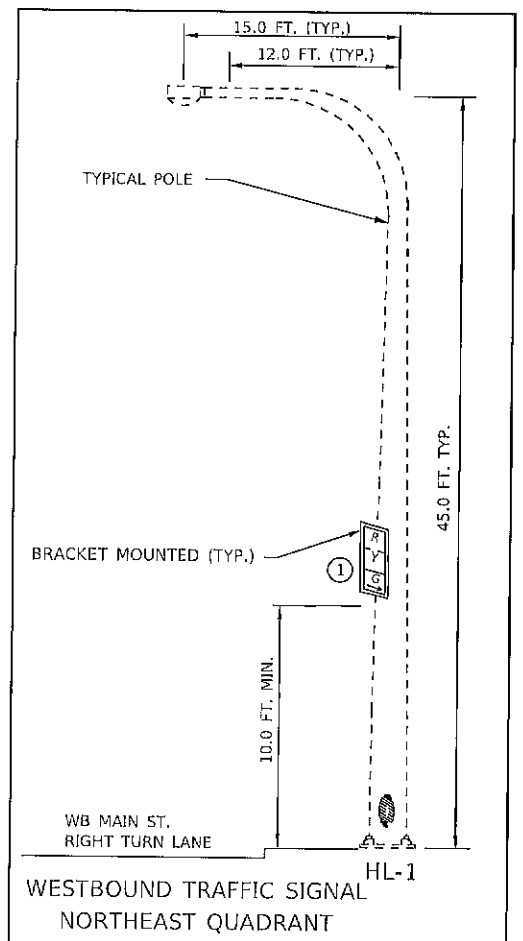

HL-1
 WESTBOUND TRAFFIC SIGNAL
 NORTHEAST QUADRANT

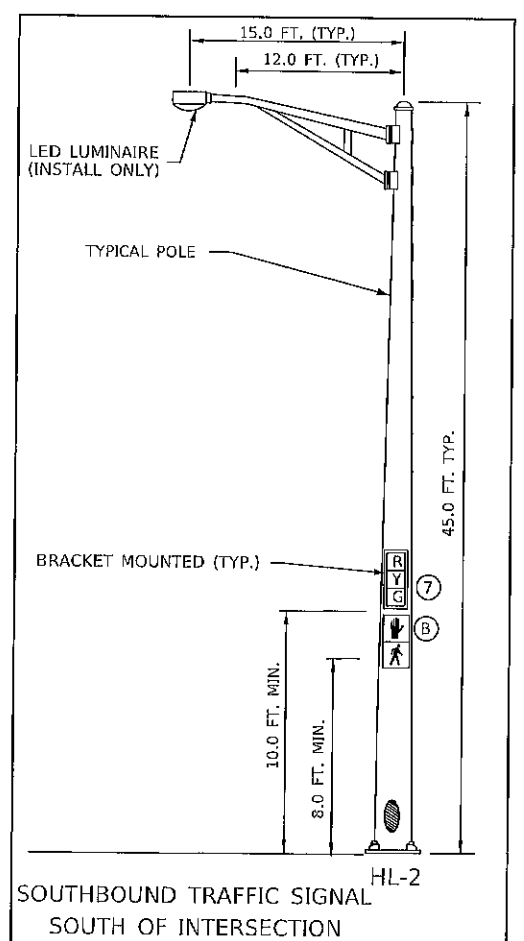

HL-2
 SOUTHBOUND TRAFFIC SIGNAL
 SOUTH OF INTERSECTION

- NOTES:
1. THE CONTRACTOR SHALL RELOCATE ALL OTHER EXISTING SIGNS FROM THE REMOVED MAST ARMS AND TRAFFIC SIGNAL POSTS TO THE PROPOSED MAST ARMS AND TRAFFIC SIGNAL POSTS. THIS WORK WILL NOT BE PAID FOR SEPARATELY BUT SHALL BE INCLUDED IN THE COST OF THE PROPOSED MAST ARMS AND TRAFFIC SIGNAL POSTS.
 2. ALL PROPOSED SIGNS SHALL INCLUDE THE BLOCK NUMBERING AT THE BOTTOM OF THE SIGN.
 3. THE BOLT CIRCLE OF THE PROPOSE LIGHT POLE (HL-2) SHALL MATCH THE BOLT CIRCLE OF THE EXISTING MAST ARM FOUNDATION. THE CONTRACTOR SHALL VERIFY THE BOLT CIRCLE OF THE EXISTING MAST ARM PRIOR TO RELEASING MATERIAL.

MODEL: Detail
 FILE NAME: C:\common\GEN\Transfer - Bureau\86G54 - Final Plans\86G54.d4 Mast Arm Replacement 2021 Final_03-19-21.dgn

USER NAME = hansonlj	DESIGNED -	REVISED -
PLOT SCALE = 23.8272' / in.	DRAWN -	REVISED -
PLOT DATE = 3/19/2021	CHECKED -	REVISED -
	DATE -	REVISED -

STATE OF ILLINOIS
 DEPARTMENT OF TRANSPORTATION

PROPOSED MAST ARM AND TRAFFIC SIGNAL POST DETAILS
 IL 8 (FARMINGTON RD.) & MAIN ST. - PEORIA

SCALE: SHEET OF SHEETS STA. TO STA.

F.A. RTE.	SECTION	COUNTY	TOTAL SHEETS	SHEET NO.
VAR.	ILLINOIS DEPARTMENT OF TRANSPORTATION REPLACEMENT 2021	PEORIA	40	18
CONTRACT NO. 68G54			ILLINOIS FED. AID PROJECT	

NOT TO SCALE

IL 8/ IL 116 (MACARTHUR) & JEFFERSON - REMOVAL		
BILL OF MATERIALS		
ITEM DESCRIPTION	UNIT	QTY.
REMOVE EXISTING CONCRETE FOUNDATION	EACH	3.0
REMOVE EXISTING TRAFFIC SIGNAL EQUIPMENT	EACH	1.0

IL 8/ IL 116 (MACARTHUR) & JEFFERSON - REMOVAL	
REMOVE EXISTING TRAFFIC SIGNAL EQUIPMENT - QTY. 1 EACH (INCLUDES ALL ITEMS LISTED BELOW)	
THE FOLLOWING ITEMS SHALL BE REMOVED AND DISPOSED OF BY THE CONTRACTOR OFF OF THE RIGHT-OF-WAY. THE SALVAGE VALUE OF THIS EQUIPMENT SHALL BE REFLECTED IN THE UNIT BID PRICE FOR "REMOVE EXISTING TRAFFIC SIGNAL EQUIPMENT."	
QTY.	DESCRIPTION
2.0	TRAFFIC SIGNAL POST
1.0	TRAFFIC SIGNAL MAST ARM
2.0	SIGNAL HEAD, 1-FACE, 3-SECTION, MAST ARM MOUNTED
3.0	SIGNAL HEAD, 1-FACE, 3-SECTION, SPAN WIRE MOUNTED
2.0	PEDESTRIAN SIGNAL HEAD, LED, 1-FACE, BRACKET MOUNTED
ALL	SPAN WIRE COMPONENTS
ALL	TRAFFIC SIGNAL CABLING NOT USED IN PROP. INSTALLATION



"R" INDICATES REMOVAL ITEM

NOT TO SCALE

MDPFL Default
 FILE NAME: C:\commen\GENTransfer - bureau\68G54 - Final Plans\68G54 - D4 Mast Arm Replacement 2021.FINAL (03-19-21).dgn

USER NAME = haisori	DESIGNED -	REVISED -
PLOT SCALE = 23.8272' / in.	DRAWN -	REVISED -
PLOT DATE = 3/19/2021	CHECKED -	REVISED -
	DATE -	REVISED -

STATE OF ILLINOIS
DEPARTMENT OF TRANSPORTATION

EXISTING TRAFFIC SIGNAL PLANS & REMOVAL ITEMS
IL 8/IL 116 (MACARTHUR HWY.) & SW JEFFERSON ST. - PEORIA

F.A. RTE.	SECTION	COUNTY	TOTAL SHEETS	SHEET NO.
VAR.	D4 MAST ARM REPLACEMENT 2021	PEORIA	40	19
CONTRACT NO. 68G54			ILLINOIS FED. AID PROJECT	

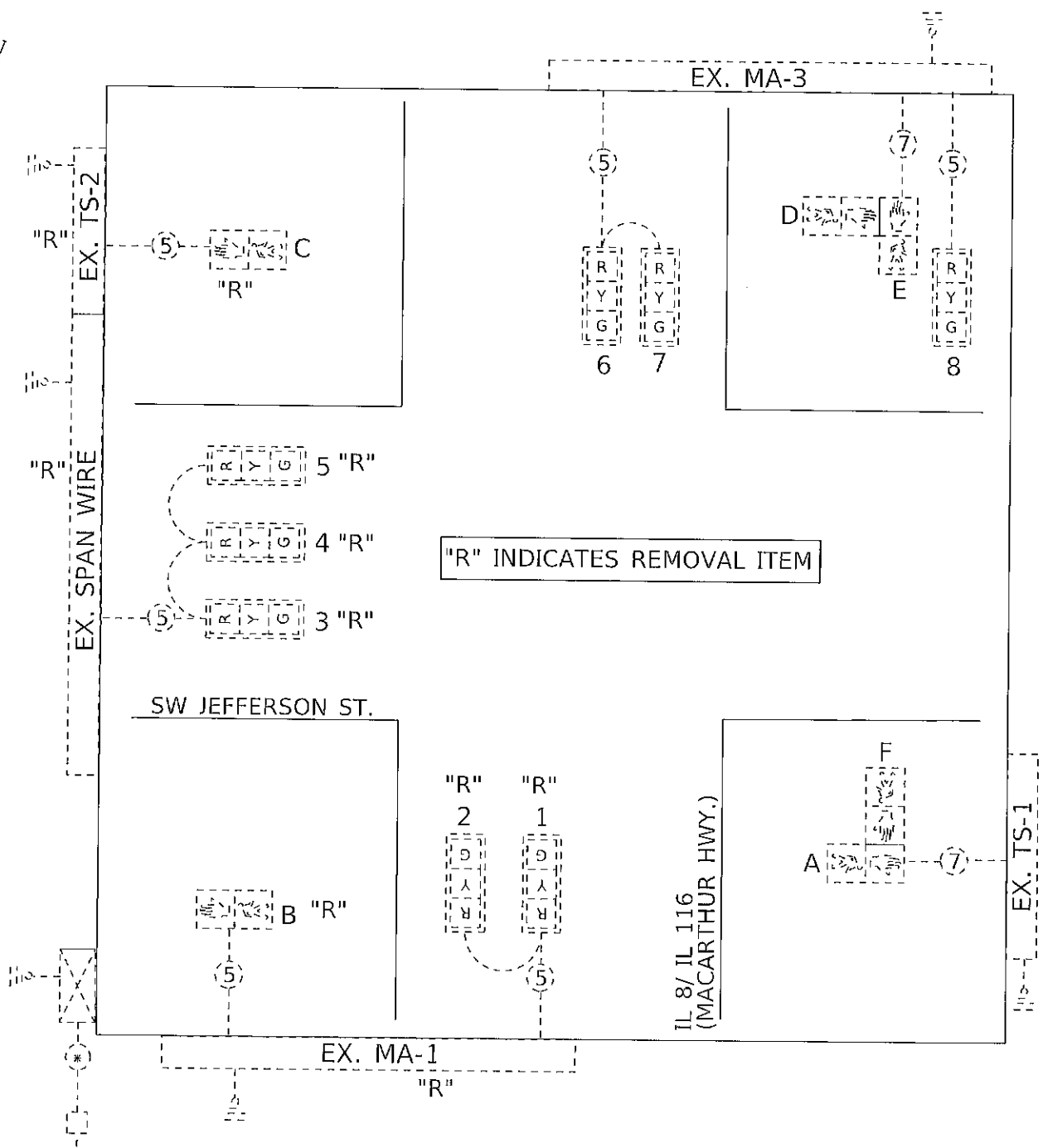
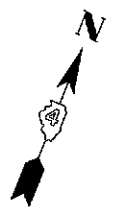

"R" INDICATES REMOVAL ITEM

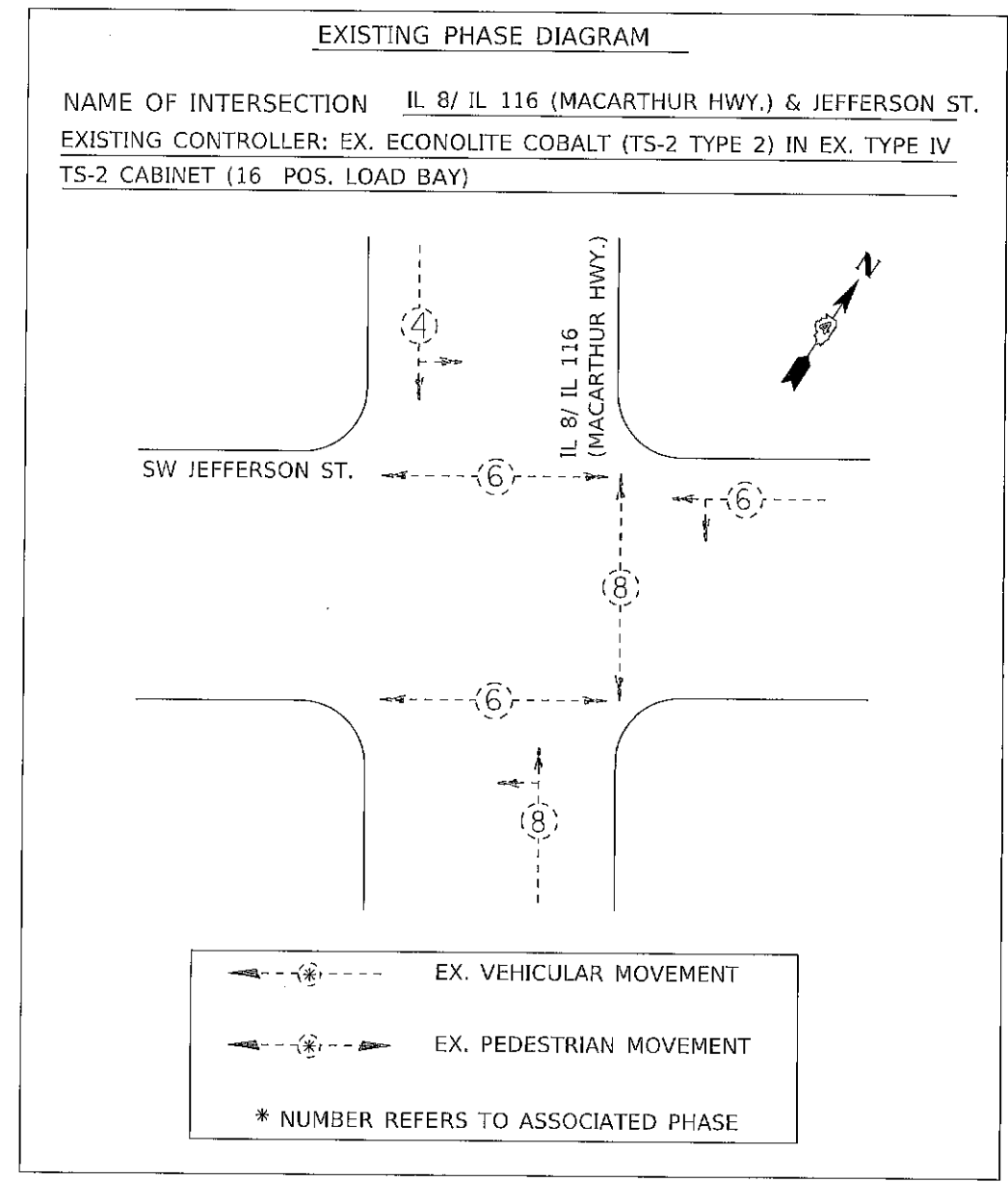

* NUMBER REFERS TO ASSOCIATED PHASE
 EX. VEHICULAR MOVEMENT
 EX. PEDESTRIAN MOVEMENT

TRAFFIC SIGNALS LEGEND

- EX. TRAFFIC SIGNAL CONTROLLER CABINET
- EX. 3 SEC. SIGNAL HEAD W/BACKPLATE
- EX. 5/C NO. 14 SIGNAL CABLE
- EX. ELECTRIC SERVICE
- EX. PEDESTRIAN SIGNAL HEAD
- EX. 7/C NO. 14 SIGNAL CABLE
- EX. GROUND/SAFETY BOND
- EX. 1/C NO. 6 CABLE

MODEL: Default
 FILE NAME: C:\common\GEN\Transfer - Bureau\68G54 - Final Plans\68G54 04 Mast Arm Replacement 2021\FINAL_03-19-21.dgn

USER NAME = hansonlj	DESIGNED -	REVISED -	
PLOT SCALE = 23.8272' / in.	DRAWN -	REVISED -	
PLOT DATE = 3/19/2021	CHECKED -	REVISED -	
	DATE -	REVISED -	

STATE OF ILLINOIS
DEPARTMENT OF TRANSPORTATION

EXISTING CABLE & PHASE DIAGRAMS
IL 8/IL 116 (MACARTHUR HWY.) & SW JEFFERSON ST. - PEORIA

SCALE: SHEET OF SHEETS STA. TO STA.

F.A. RTE.	SECTION	COUNTY	TOTAL SHEETS	SHEET NO.
VAR.	D4 MAST ARM REPLACEMENT 2021	PEORIA	40	20
CONTRACT NO. 68G54				
ILLINOIS FED. AID PROJECT				

NOT TO SCALE

IL 8/ IL 116 (MACARTHUR) & JEFFERSON - PROPOSED

BILL OF MATERIALS

ITEM DESCRIPTION	UNIT	QTY.
PORTLAND CEMENT CONCRETE SIDEWALK 4 INCH	SQ FT	70.0
SIDEWALK REMOVAL	SQ FT	80.0
SIGN PANEL - TYPE 2	SQ FT	31.6
UNDERGROUND CONDUIT, PVC, 3" DIA.	FOOT	40.0
ELECTRIC CABLE IN CONDUIT, SIGNAL NO. 14 5C	FOOT	487.0
ELECTRIC CABLE IN CONDUIT, EQUIPMENT GROUNDING CONDUCTOR, NO. 6 1C	FOOT	77.5
STEEL MAST ARM ASSEMBLY AND POLE, 26 FT.	EACH	1.0
STEEL MAST ARM ASSEMBLY AND POLE, 46 FT.	EACH	1.0
CONCRETE FOUNDATION, TYPE E 30-INCH DIAMETER	FOOT	10.0
CONCRETE FOUNDATION, TYPE E 36-INCH DIAMETER	FOOT	13.0
DRILL EXISTING FOUNDATION	EACH	1.0
DRILL EXISTING HANDHOLE	EACH	2.0
SIGNAL HEAD, POLYCARBONATE, LED, 1-FACE, 3-SECTION, MAST ARM MOUNTED	EACH	5.0
PEDESTRIAN SIGNAL HEAD, LED, 1-FACE, BRACKET MOUNTED	EACH	2.0
TRAFFIC SIGNAL BACKPLATE, RETROREFLECTIVE	EACH	5.0

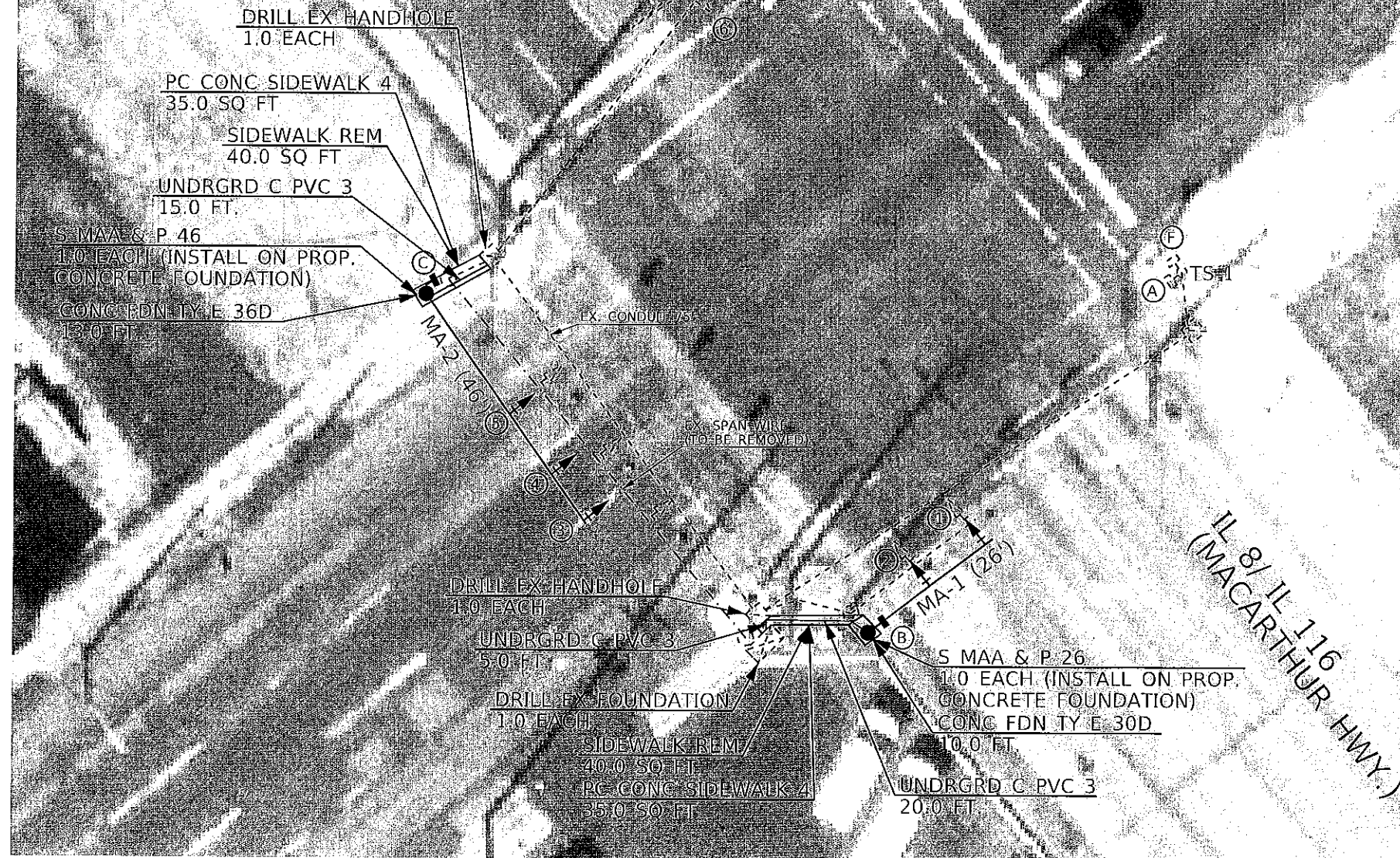

IL 8/ IL 116 (MACARTHUR HWY.) & SW JEFFERSON ST.
MAST ARM SCHEDULE

REF	LOCATION	LENGTH	DESCRIPTION
MA-1	S QUAD	26 FT.	S MAA & P
MA-2	W QUAD	46 FT.	S MAA & P

IL 8/ IL 116 (MACARTHUR HWY.) & SW JEFFERSON ST.
TRAFFIC SIGNAL HEAD SCHEDULE

QTY.	UNIT	ITEM	LOCATION
-	EACH	SH P LED 1F 3S BM	8 (EXISTING)
5.0	EACH	SH P LED 1F 3S MAM	1,2,3,4,5 (PROPOSED) 6,7 (EXISTING)
5.0	EACH	TS BACKPLATE RET-REFL	1,2,3,4,5 (PROPOSED) 6,7,8 (EXISTING)
2.0	EACH	PED SH LED 1F BM	B,C
-	EACH	PED SH LED 2F BM	A/F, D/E

NOT TO SCALE

MODEL: Default
FILE NAME: C:\common\AGENTTransfer - bureau\68G54 - Final Plans\68G54 - D4 Mast Arm Replacement 2021_FINAL_03-19-21.dwg

USER NAME = hansonj	DESIGNED -	REVISD -
PLOT SCALE = 23.8272' / in.	DRAWN -	REVISD -
PLOT DATE = 3/19/2021	CHECKED -	REVISD -
	DATE -	REVISD -

STATE OF ILLINOIS
DEPARTMENT OF TRANSPORTATION

PROPOSED TRAFFIC SIGNAL PLANS
IL 8/IL 116 (MACARTHUR HWY.) & SW JEFFERSON ST. - PEORIA

F.A. RTE.	SECTION	COUNTY	TOTAL SHEETS	SHEET NO.
VAR.	DRAWING NO. 0001	PEORIA	40	21
CONTRACT NO. 68G54				
ILLINOIS FED. AID PROJECT				

SCALE: SHEET OF SHEETS STA. TO STA.

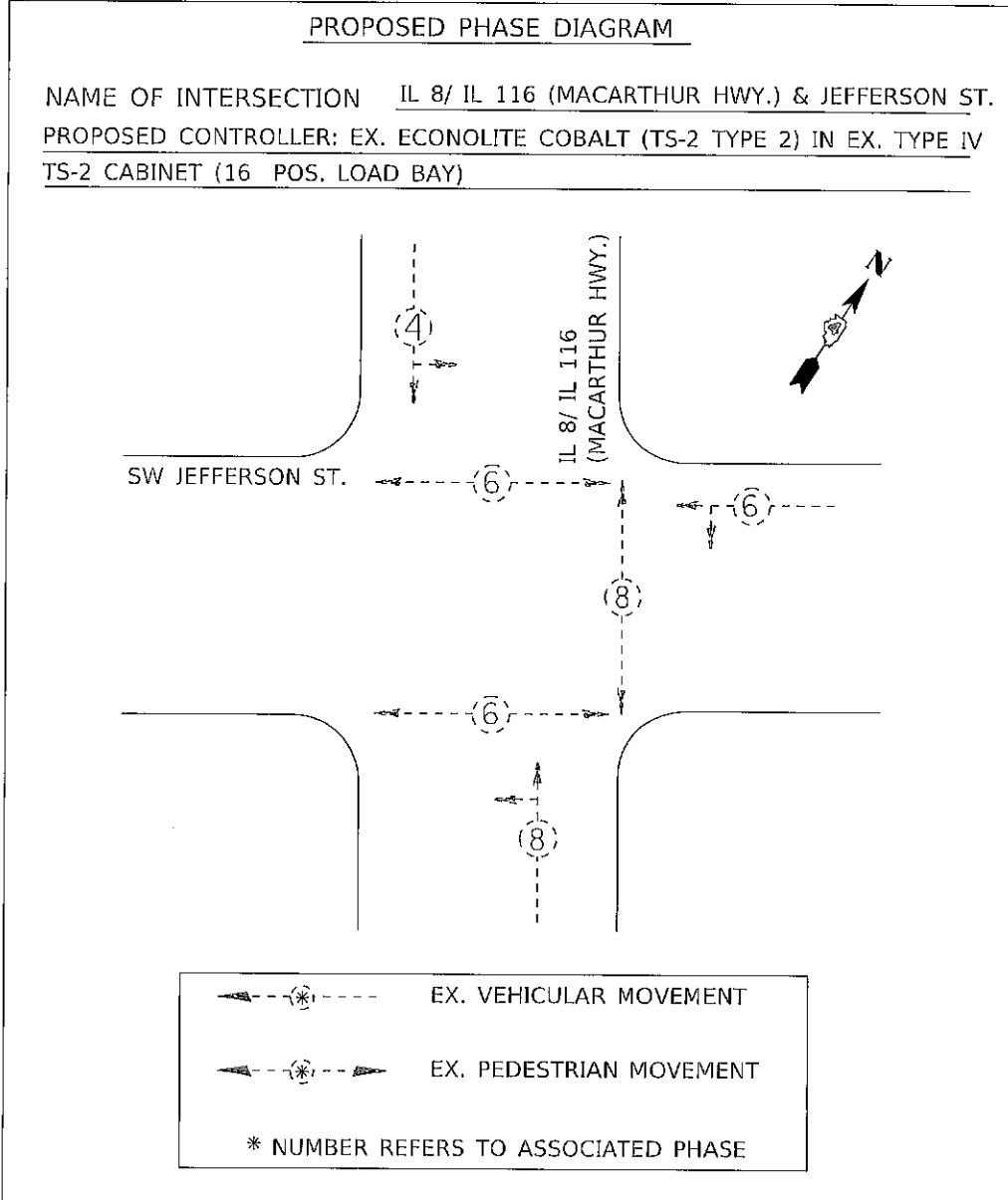
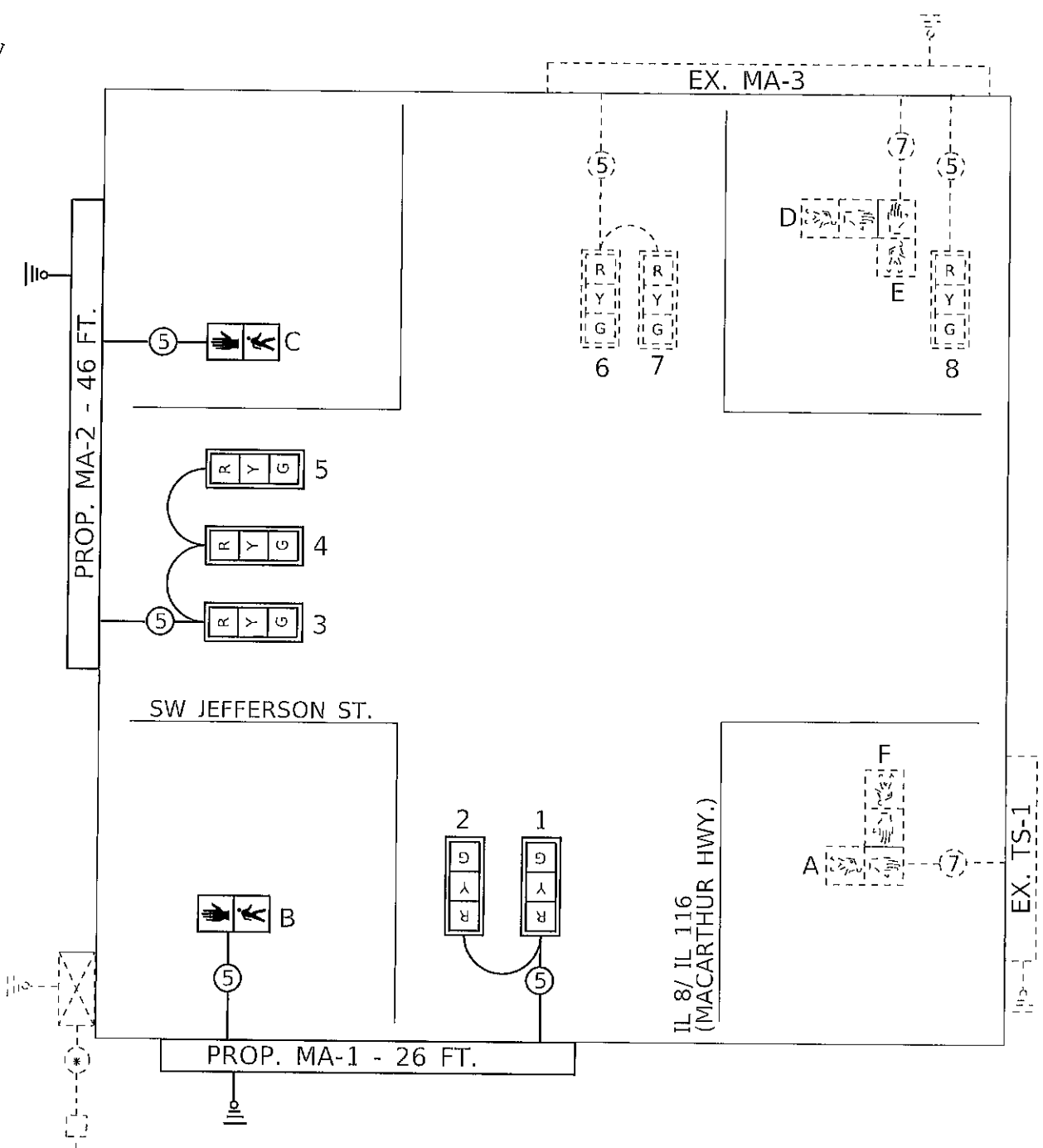

TRAFFIC SIGNALS LEGEND

- | | | |
|--|--|---|
| <p> EX. TRAFFIC SIGNAL CONTROLLER CABINET</p> <p> EX. ELECTRIC SERVICE</p> <p> PROP. GROUND/SAFETY BOND</p> <p> EX. GROUND/SAFETY BOND</p> | <p> PROP. 3 SEC. SIGNAL HEAD W/BACKPLATE</p> <p> PROP. PEDESTRIAN SIGNAL HEAD</p> <p> EX. PEDESTRIAN SIGNAL HEAD</p> | <p> PROP. 5/C NO. 14 SIGNAL CABLE</p> <p> PROP. 7/C NO. 14 SIGNAL CABLE</p> <p> EX. 1/C NO. 6 CABLE</p> |
|--|--|---|

NOT TO SCALE

MODEL: Default
 FILE NAME: C:\common\gentransfer - bureau\68G54 - Final Plans\68G54 D4 Mast Arm Replacement 2021 FINAL 03-19-21.dgn

USER NAME = hansonj	DESIGNED -	REVISED -	
PLOT SCALE = 23.8272" / ft.	DRAWN -	REVISED -	
PLOT DATE = 3/19/2021	CHECKED -	REVISED -	
	DATE -	REVISED -	

**STATE OF ILLINOIS
DEPARTMENT OF TRANSPORTATION**

PROPOSED CABLE & PHASE DIAGRAMS
IL 8/IL 116 (MACARTHUR HWY.) & SW JEFFERSON ST. - PEORIA

SCALE: SHEET OF SHEETS STA. TO STA.

F.A. RTE.	SECTION	COUNTY	TOTAL SHEETS	SHEET NO.
VAR.	D4 MAST ARM REPLACEMENT 2021	PEORIA	40	22
CONTRACT NO. 68G54				
ILLINOIS FED. AID PROJECT				

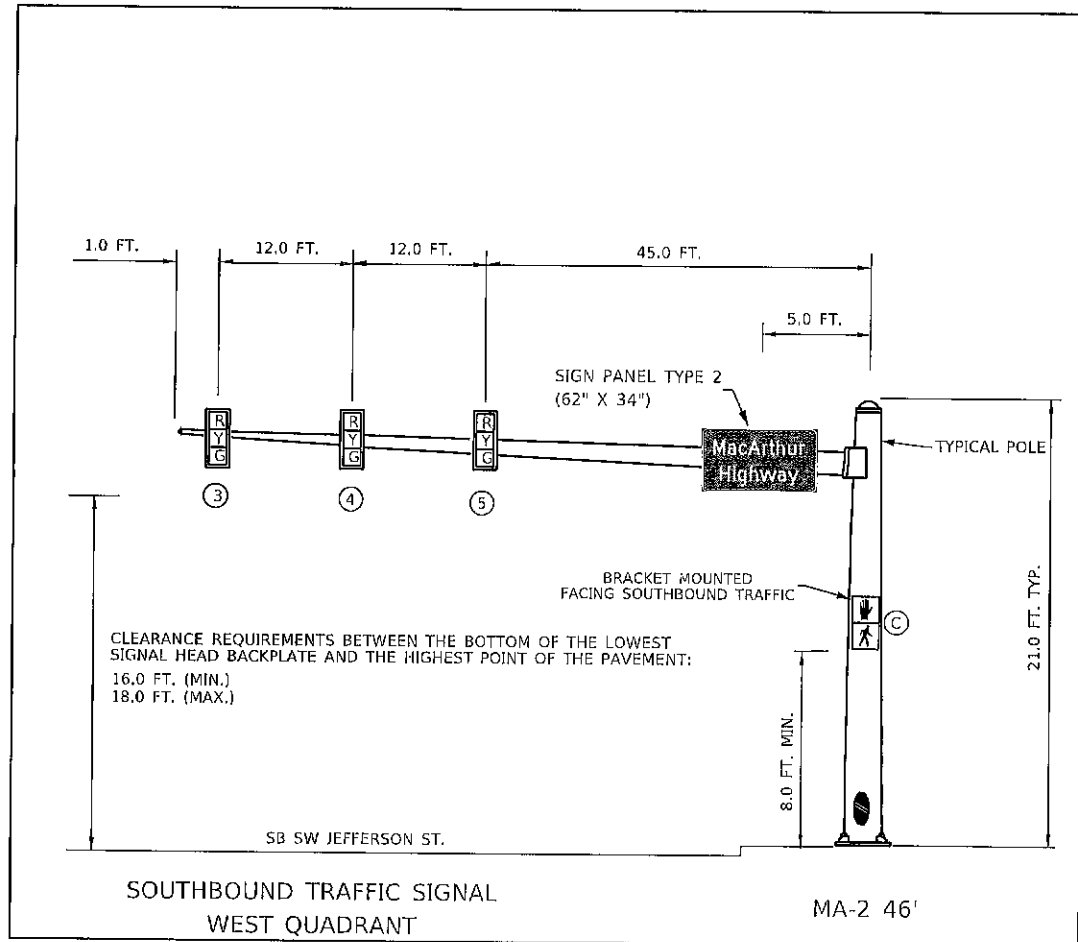
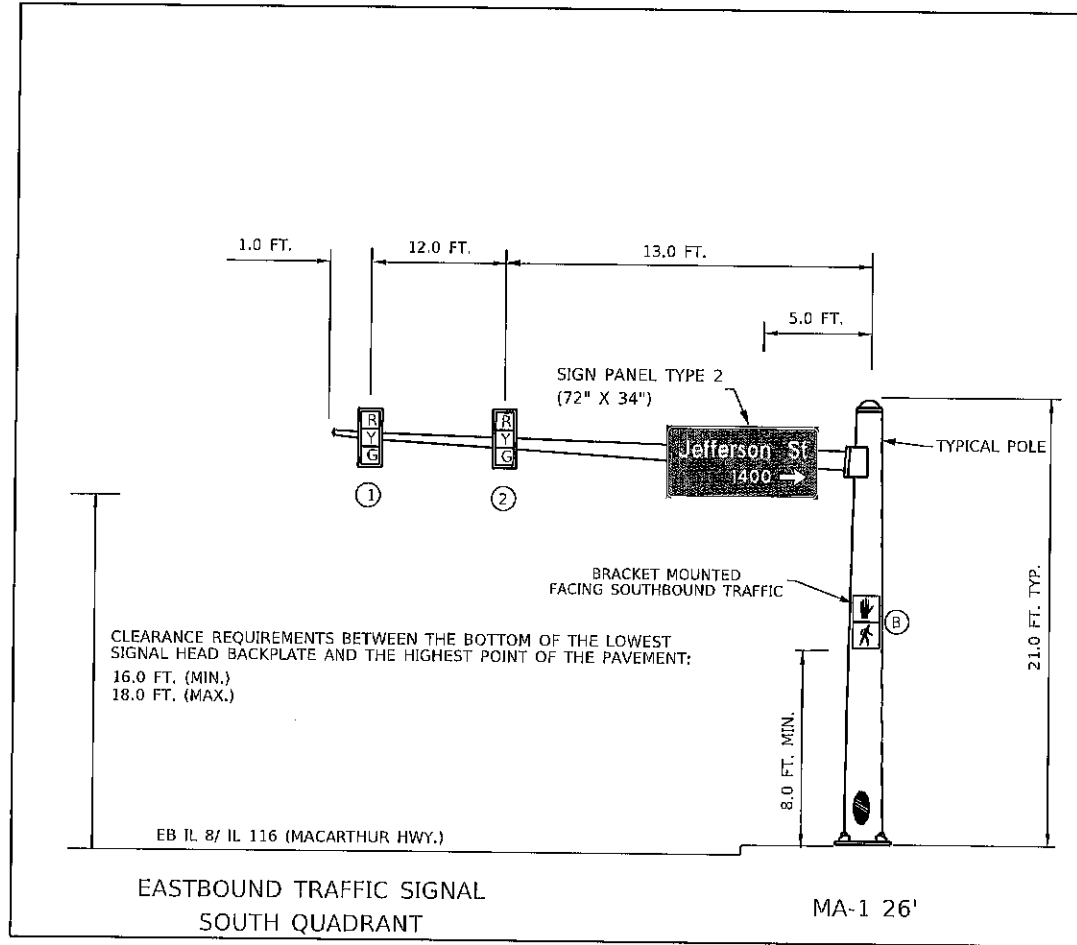

- NOTES:
1. THE CONTRACTOR SHALL RELOCATE ALL OTHER EXISTING SIGNS FROM THE REMOVED MAST ARMS AND TRAFFIC SIGNAL POSTS. THIS WORK WILL NOT BE PAID FOR SEPARATELY BUT SHALL BE INCLUDED IN THE COST OF THE PROPOSED MAST ARMS AND TRAFFIC SIGNAL POSTS.
 2. ALL PROPOSED SIGNS SHALL INCLUDE THE BLOCK NUMBERING AT THE BOTTOM OF THE SIGN.

MODEL: Default
 FILE NAME: C:\common\GENT\transfer - bureau\68654 - Final Plans\68654 - Dtd. Mast Arm Replacement 2021 FINAL 03-19-21.dgn

NOT TO SCALE

USER (NAME)	= hansonlj	DESIGNED	-	REVISED	-
DRAWN	-	CHECKED	-	REVISED	-
PLOT SCALE	= 23,8272' / in.	DATE	-	REVISED	-
PLOT DATE	= 3/19/2021				

STATE OF ILLINOIS
DEPARTMENT OF TRANSPORTATION

PROPOSED MAST ARM DETAILS
 IL 8/IL 116 (MACARTHUR HWY.) & SW JEFFERSON ST. - PEORIA

F.A. RTE.	SECTION	COUNTY	TOTAL SHEETS	SHEET NO.
VAR.	04 MAST ARM REPLACEMENT 2021	PEORIA	40	23
CONTRACT NO. 68654			ILLINOIS FED. AID PROJECT	

SCALE: SHEET OF SHEETS STA. TO STA.

IL 8/ IL 116 (MACARTHUR) & ADAMS - REMOVAL		
BILL OF MATERIALS		
ITEM DESCRIPTION	UNIT	QTY.
REMOVE EXISTING CONCRETE FOUNDATION	EACH	3.0
REMOVE EXISTING TRAFFIC SIGNAL EQUIPMENT	EACH	1.0



"R" INDICATES REMOVAL ITEM

IL 8/ IL 116 (MACARTHUR) & ADAMS - REMOVAL	
REMOVE EXISTING TRAFFIC SIGNAL EQUIPMENT - QTY. 1 EACH (INCLUDES ALL ITEMS LISTED BELOW)	
THE FOLLOWING ITEMS SHALL BE REMOVED AND DISPOSED OF BY THE CONTRACTOR OFF OF THE RIGHT-OF-WAY. THE SALVAGE VALUE OF THIS EQUIPMENT SHALL BE REFLECTED IN THE UNIT BID PRICE FOR "REMOVE EXISTING TRAFFIC SIGNAL EQUIPMENT."	
QTY.	DESCRIPTION
1.0	TRAFFIC SIGNAL POST
2.0	TRAFFIC SIGNAL MAST ARM
4.0	SIGNAL HEAD, 1-FACE, 3-SECTION, MAST ARM MOUNTED
3.0	SIGNAL HEAD, 1-FACE, 3-SECTION, SPAN WIRE MOUNTED
1.0	PEDESTRIAN SIGNAL HEAD, LED, 1-FACE, BRACKET MOUNTED
2.0	PEDESTRIAN SIGNAL HEAD, LED, 2-FACE, BRACKET MOUNTED
ALL	SPAN WIRE COMPONENTS
ALL	TRAFFIC SIGNAL CABLING NOT USED IN PROP. INSTALLATION

NOT TO SCALE

MODEL: Default
FILE NAME: C:\Common\GENT\Transfer - Bureau\6854 - Final Plans\6854 D4 Misc Arm Replacement 2021 FINAL 03-19-21.dgn

USER NAME = hansonj	DESIGNED -	REVISED -
PLOT SCALE = 23,8272' / in.	DRAWN -	REVISED -
PLOT DATE = 3/19/2021	CHECKED -	REVISED -
	DATE -	REVISED -

STATE OF ILLINOIS
DEPARTMENT OF TRANSPORTATION

EXISTING TRAFFIC SIGNAL PLANS & REMOVAL ITEMS			
IL 8/IL 116 (MACARTHUR HWY.) & SW ADAMS ST. - PEORIA			
SCALE:	SHEET	OF SHEETS	STA. TO STA.

F.A. RTE.	SECTION	COUNTY	TOTAL SHEETS	SHEET NO.
VAR.	IL 8/IL 116 (MACARTHUR HWY.) & SW ADAMS ST.	PEORIA	40	24
			CONTRACT NO. 6854	
ILLINOIS FED. AID PROJECT				

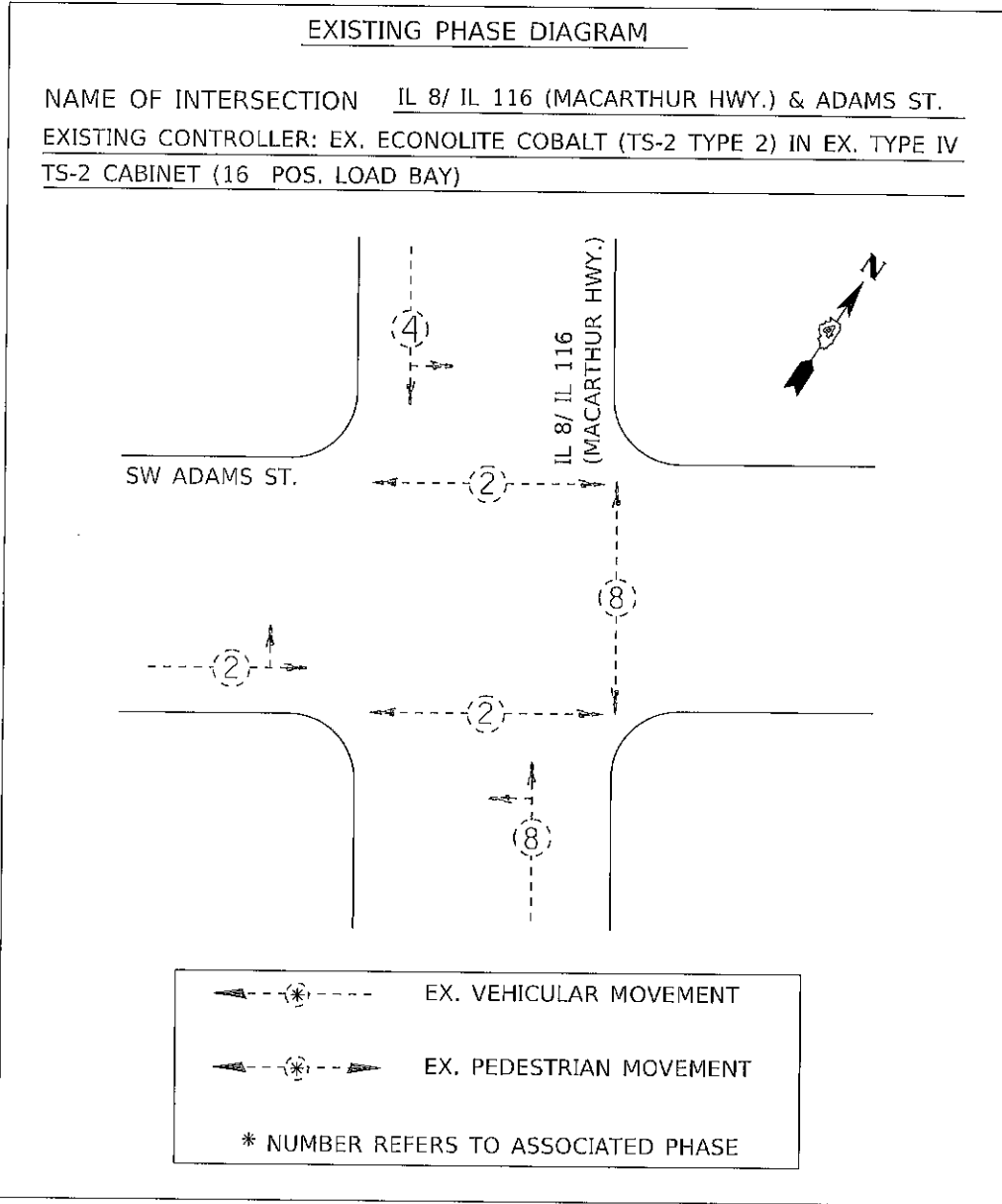
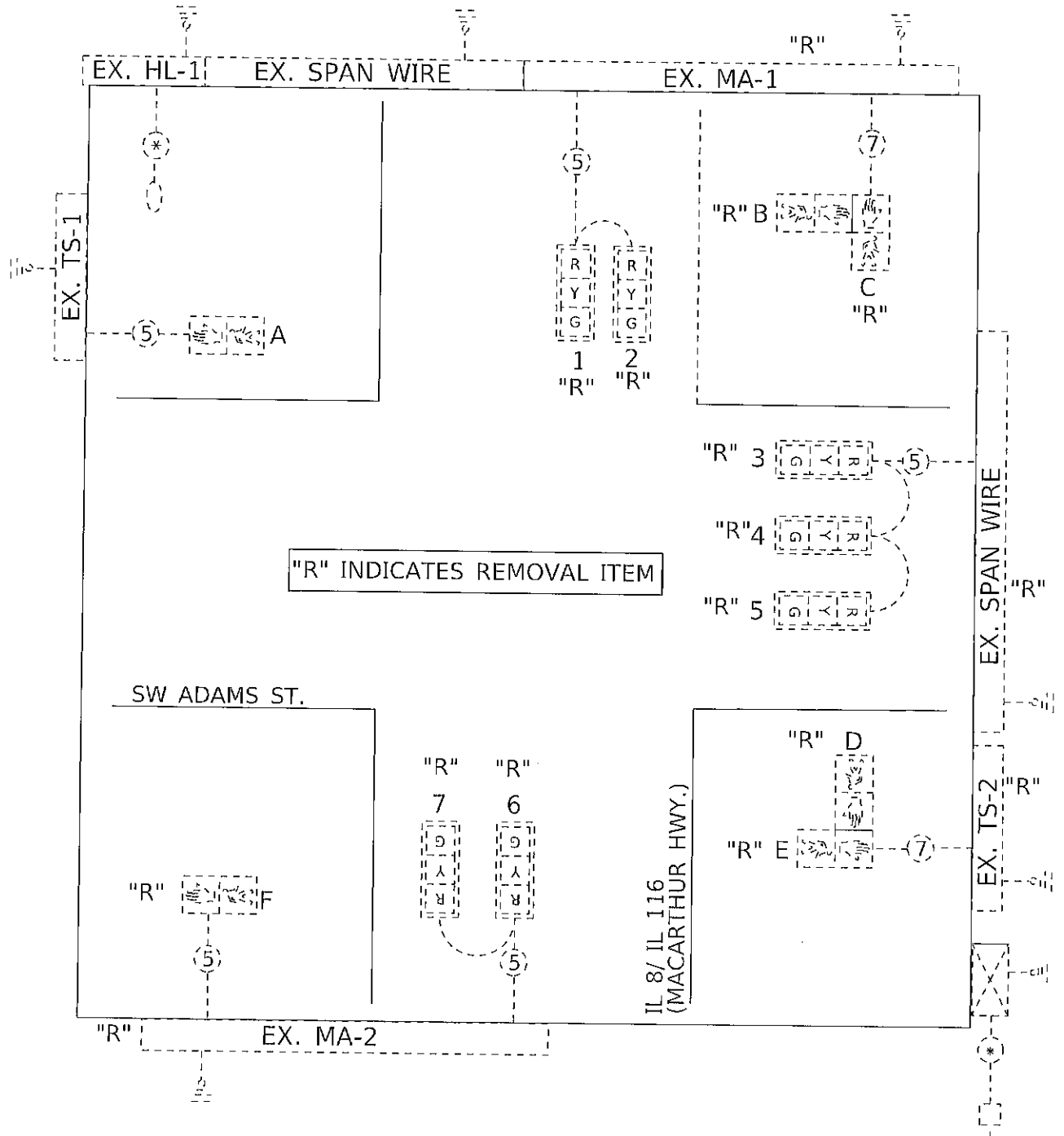

TRAFFIC SIGNALS LEGEND

- EX. TRAFFIC SIGNAL CONTROLLER CABINET
- PROP. 3 SEC. SIGNAL HEAD W/BACKPLATE
- EX. 5/C NO. 14 SIGNAL CABLE
- EX. ELECTRIC SERVICE
- PROP. PEDESTRIAN SIGNAL HEAD
- EX. 7/C NO. 14 SIGNAL CABLE
- EX. HPS LUMINIARE
- EX. GROUND/SAFETY BOND
- EX. 1/C NO. 6 CABLE

MODEL: Default
 FILE: \\mfc\c:\admin\GEN\Transfer - Bureau\68G54 - Final\Plan\68G54 D4 Mast Arm Replacement 2021 Final (03-19-21).dgn

NOT TO SCALE

USER NAME = nansonj PLOT SCALE = 23,8272' / in. PLOT DATE = 3/19/2021	DESIGNED - DRAWN - CHECKED - DATE -	REVISED - REVISED - REVISED - REVISED -	STATE OF ILLINOIS DEPARTMENT OF TRANSPORTATION	EXISTING CABLE & PHASE DIAGRAMS IL 8/IL 116 (MACARTHUR HWY.) & SW ADAMS ST. - PEORIA	F.A. RTE. VAR.	SECTION D4 MAST ARM REPLACEMENT 2021	COUNTY PEORIA	TOTAL SHEETS 40	SHEET NO. 25
				SCALE: SHEET OF SHEETS STA. TO STA.	CONTRACT NO. 68G54 ILLINOIS FED. AID PROJECT				

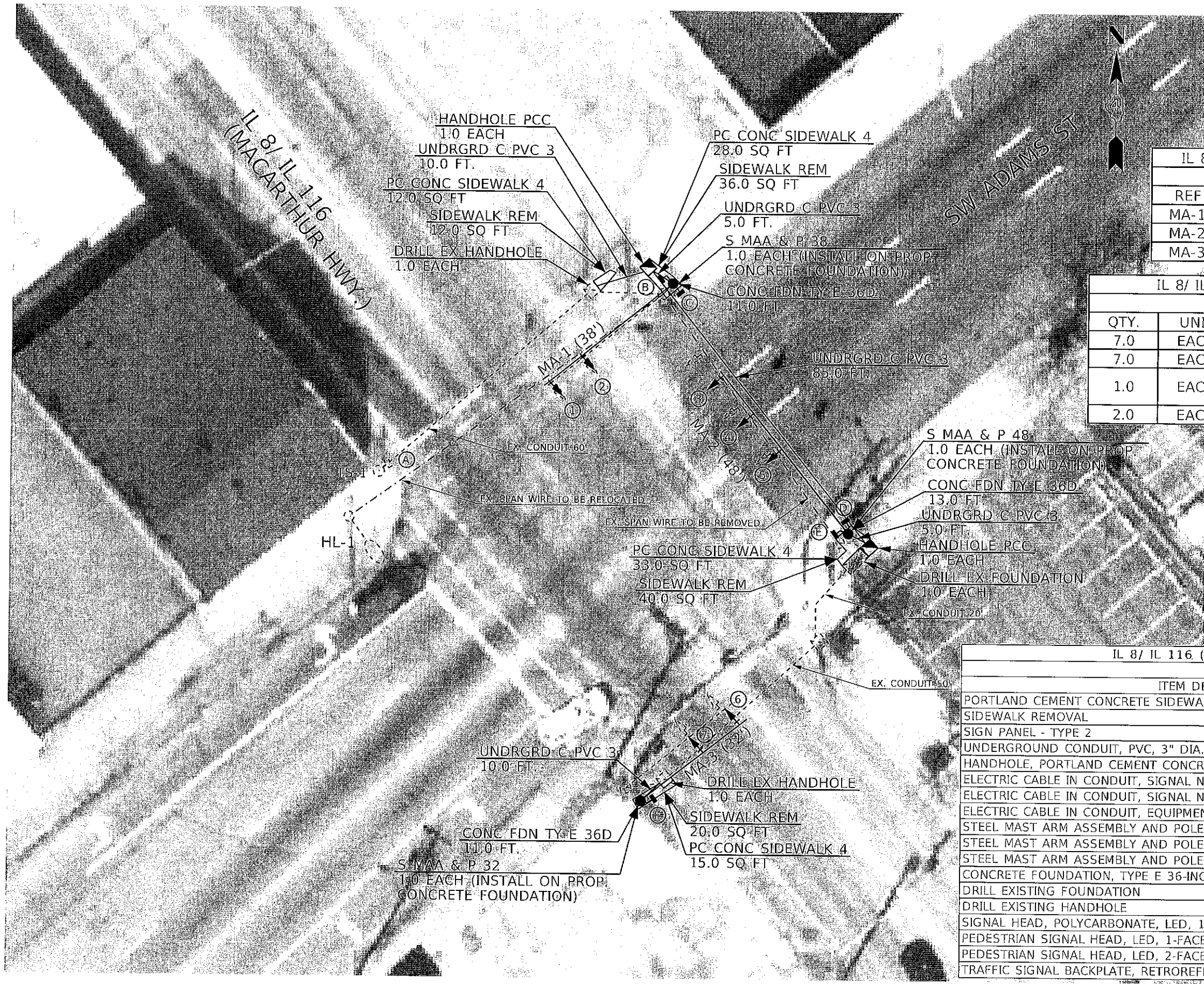

IL 8/ IL 116 (MACARTHUR HWY.) & SW ADAMS ST.
MAST ARM SCHEDULE

REF	LOCATION	LENGTH	DESCRIPTION
MA-1	N QUAD	38 FT.	S MAA & P
MA-2	E QUAD	48 FT.	S MAA & P
MA-3	S QUAD	32 FT.	S MAA & P

IL 8/ IL 116 (MACARTHUR HWY.) & SW ADAMS ST.
TRAFFIC SIGNAL HEAD SCHEDULE

QTY.	UNIT	ITEM	LOCATION
7.0	EACH	SH P LED 1F 3S MAM	1,2,3,4,5,6,7
7.0	EACH	TS BACKPLATE RET-REFL	1,2,3,4,5,6,7
1.0	EACH	PED SH LED 1F BM	F (PROPOSED) A(EXISTING)
2.0	EACH	PED SH LED 2F BM	B/C, D/E

NOTES:
1. THE EXISTING SPAN WIRE THAT FEEDS HL-1 SHALL BE RELOCATED THROUGH THE PROPOSED CONDUIT FROM THE CONTROLLER TO PROP. MA-1 AND FROM PROP. MA-1 OVERHEAD TO EX. HL-1. THIS WORK WILL NOT BE PAID FOR SEPARATELY, BUT SHALL BE INCLUDED IN THE COST OF THE PROPOSED MAST ARM.

IL 8/ IL 116 (MACARTHUR) & ADAMS - PROPOSED
BILL OF MATERIALS

ITEM DESCRIPTION	UNIT	QTY.
PORTLAND CEMENT CONCRETE SIDEWALK 4 INCH	SQ FT	88.0
SIDEWALK REMOVAL	SQ FT	108.0
SIGN PANEL - TYPE 2	SQ FT	37.2
UNDERGROUND CONDUIT, PVC, 3" DIA.	FOOT	115.0
HANDHOLE, PORTLAND CEMENT CONCRETE	EACH	1.0
ELECTRIC CABLE IN CONDUIT, SIGNAL NO. 14 5C	FOOT	769.0
ELECTRIC CABLE IN CONDUIT, SIGNAL NO. 14 7C	FOOT	158.5
ELECTRIC CABLE IN CONDUIT, EQUIPMENT GROUNDING CONDUCTOR, NO. 6 1C	FOOT	178.5
STEEL MAST ARM ASSEMBLY AND POLE, 32 FT.	EACH	1.0
STEEL MAST ARM ASSEMBLY AND POLE, 38 FT.	EACH	1.0
STEEL MAST ARM ASSEMBLY AND POLE, 48 FT.	EACH	1.0
CONCRETE FOUNDATION, TYPE E 36-INCH DIAMETER	FOOT	35.0
DRILL EXISTING FOUNDATION	EACH	1.0
DRILL EXISTING HANDHOLE	EACH	2.0
SIGNAL HEAD, POLYCARBONATE, LED, 1-FACE, 3-SECTION, MAST ARM MOUNTED	EACH	7.0
PEDESTRIAN SIGNAL HEAD, LED, 1-FACE, BRACKET MOUNTED	EACH	1.0
PEDESTRIAN SIGNAL HEAD, LED, 2-FACE, BRACKET MOUNTED	EACH	2.0
TRAFFIC SIGNAL BACKPLATE, RETROREFLECTIVE	EACH	7.0

NOT TO SCALE

USER NAME = hansonj	DESIGNED -	REVISED -
PLOT SCALE = 23,872" / 1"	CHECKED -	REVISED -
PLOT DATE = 3/19/2021	DATE -	REVISED -

STATE OF ILLINOIS
DEPARTMENT OF TRANSPORTATION

PROPOSED TRAFFIC SIGNAL PLANS
IL 8/IL 116 (MACARTHUR HWY.) & SW ADAMS ST. - PEORIA

F.A. RFE.	SECTION	COUNTY	TOTAL SHEETS	SHEET NO.
VAR.	08ADAMS/ARM R2FACE/HT/22P1	PEORIA	40	26
CONTRACT NO. 68G54				
ILLINOIS FED. AID PROJECT				

MODEL: default
FILE NAME: D:\p\m\m\gen\trans\tr - Bureau\68G54 - Final Plans\68G54 - Final Plans\68G54 - Final Plans\68G54.dwg