

OTTO BAUM COMPANY, INC.

C O N T R A C T O R S

MASONRY ■ CONCRETE ■ EARTHWORK ■ SITE/CIVIL ■ RESTORATION

www.ottobaum.com

217-528-2386 ■ Fax 217-528-3074

1700 Clear Lake Ave. ■ Springfield, IL 62703

June 22, 2014

Ms. Andrea Klopfenstein, P.E.
City of Peoria
3505 N. Dries Lane
Peoria, IL 61602

Re: Poplett Hollow Road
Culvert Replacement
Cost Savings Proposal

Dear Ms. Klopfenstein,

Otto Baum Company, Inc. is pleased to offer the City of Peoria a cost savings concept utilizing a temporary crossing in lieu of the temporary bridge complete for the above-mentioned project.

Original Bid Proposal

Temporary Bridge Complete	1 Each	\$80,000.00
Emergency Backfill	1 LS	<u>\$4900.00</u>
	Total	\$84,900.00

Cost Savings Proposal

Temporary Crossing	1 LS	<u>\$27,000.00</u>
	Total	\$27,000.00

Cost Savings Total **\$57,900.00**

As mentioned above our proposal will utilize a temporary crossing that will consist of a 6' diameter metal culvert pipe approximately 20 feet in length installed in the upstream end of the creek channel. The culvert pipe will be bedded and backfilled with CA-6 course aggregate. The roadway will be constructed over the temporary culvert approximately 12 feet wide by 120 feet in length consisting of 6 inches of CA-6 course aggregate for roadway base and 2 stop signs mounted on A-frame stands to control the single lane of traffic during stage 1 construction. Please see attached details that illustrate the crossing and roadway alignment.

Please note once the crossing has been installed it will be Otto Baum's intent to begin stage 1 construction by closing the road and beginning the demo operation. The demo operation will include the removal of the existing 6' diameter pipe culvert, miscellaneous tree and debris removal, removal of the existing pavement, removal of the existing gabion and the driveway pavement removal. The next operation will consist of excavation, grading and placing of the 6" bedding course for the downstream cast in place end section and the precast box culvert sections. Next we will begin installing the precast box sections from the downstream end to the upstream end where the box sections terminate. Once the box culvert sections are installed we will form and pour the cast in end section and complete any additional work remaining to complete stage 1 (i.e. miscellaneous concrete, backfilling, gabion installation and installing riprap on the downstream end). After stage 1 work is complete Otto Baum will

then remove the temporary crossing installed in the pre-stage and let traffic cross over the newly constructed box culvert driving on the aggregate base. Upon removal of the temporary crossing we will begin stage 2 construction consisting of excavation, grading, installation of the bedding layer for the upstream cast in place end section, the upstream cast in place end section, backfilling, installation of the riprap at the upstream end, miscellaneous grading of site, placement of the HMA pavement and final seeding of site.

Also note, the cost savings proposal offered will not have any effect on the substantial complete date of September 30, 2014, or the final completion date of October 7, 2014.

We believe the temporary crossing not only provides a cost savings to the City but, will safely serve the purpose of the original contract by offering the residents access to their dwellings along with any emergency vehicles that could potentially be needed while this project is under construction.

We appreciate the City of Peoria's consideration in this matter and ask that you please contact me at 309-284-1748 should you have any further questions regarding this proposal.

Sincerely,

A handwritten signature in black ink, appearing to read "Richard J. Miller".

Richard J. Miller
Otto Baum Company, Inc.

Enclosure

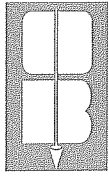

OTTO BAUM COMPANY, INC. City of Peoria

www.ottobaum.com

217-528-2386 ■ Fax 217-528-3074

1700 Clear Lake Ave. ■ Springfield, IL 62703

C O N T R A C T O R S MASONRY ■ CONCRETE ■ EARTHWORK ■ SITE/CIVIL ■ RESTORATION

VE Proposal revised 6/13/14

Contact: Rich Miller
217-622-0257

Job Name: Poppett Hollow Rd. Culvert Replacement
City of Peoria, IL

Acknowledge Addendum #1

ITEM	DESCRIPTION	QUANTITY	UNIT	UNIT PRICE	AMOUNT
10	SEEDING, CL 1A	0.25	ACRE	7,300.00	1,825.00
20	TEMPORARY DITCH CHECK	20.00	FT	42.00	840.00
30	STONE RIPRAP, CLASS A5	130.00	SY	100.00	13,000.00
40	GABIONS	40.00	CY	235.00	9,400.00
50	AGGREGATE BASE COURSE, TYPE B 8"	279.00	SY	20.00	5,580.00
60	HOT-MIX ASPHALT SURFACE COURSE, MIX "C", N30	48.00	TON	185.00	8,880.00
70	PAVEMENT REMOVAL	320.00	SY	9.00	2,880.00
80	DRIVEWAY PAVEMENT REMOVAL	9.00	SY	34.00	306.00
90	AGGREGATE DRIVEWAY SHOULDERS, TYPE B 6"	32.00	SY	61.00	1,952.00
100	REMOVAL OF EXISTING STRUCTURES	1.00	EA	28,000.00	28,000.00
110	TEMPORARY BRIDGE COMPLETE		EA		
120	BOX CULVERT END SECTIONS, CULVERT NO. 1	2.00	EA	32,500.00	65,000.00
130	PRECAST CONCRETE BOX CULVERTS 7'X6'	72.00	FT	625.00	45,000.00
140	PERMANENT STEEL SHEET PILING	390.00	SF	52.00	20,280.00
150	GRANULAR BACKFILL FOR STRUCTURES	240.00	CY	83.00	19,920.00
160	CONCRETE GUTTER, TYPE A (SPECIAL)	140.00	FT	118.00	16,520.00
170	TRAFFIC CONTROL AND PROTECTION, (SPECIAL)	1.00	LS	3,600.00	3,600.00
180	EMERGENCY BACKFILL		LS		
1000	TEMPORARY CROSSING	1.00	LS	27,000.00	27,000.00

GRAND TOTAL

\$269,983.00

NOTES:

Temporary Bridge Complete and the Emergency Backfill have been deleted from this proposal as part of the value engineering proposal and replaced with the Temporary Crossing.

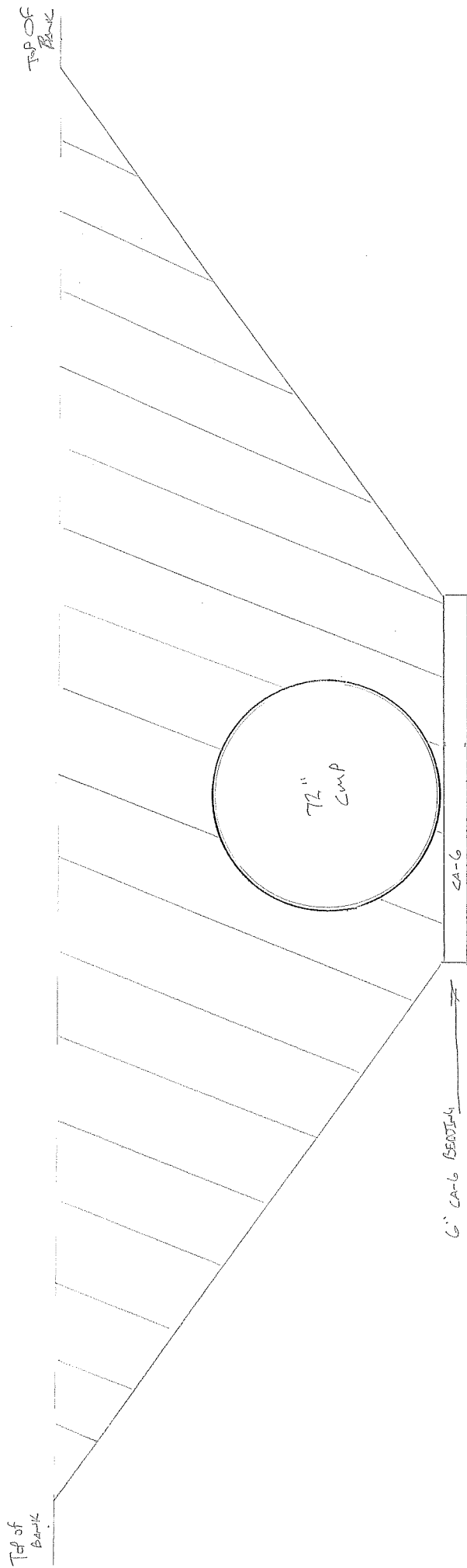

THROUGH SECTION OF UPSTREAM CHANNEL FOR TRENCH CROSSING

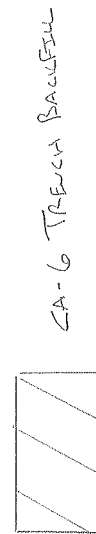

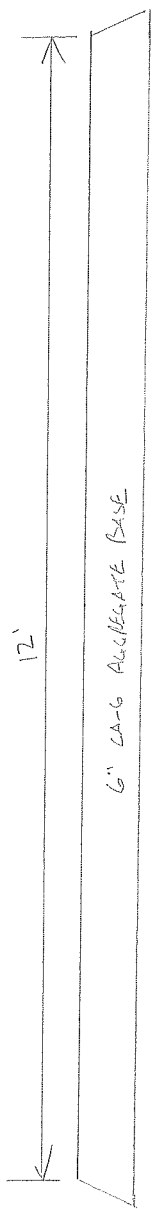

TYPICAL SECTION OF TEMP CROSSING

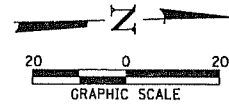

LEGEND
 TEMPORARY DITCH CHECK

DATE	
BY	
REVIEWED	
PLOTTED	
ALIGNMENT CHECKED	
GRADES CHECKED	
STRUCTURE NOTATIONS CHECKED	
NOTE BOOK NO.	
ADD FILE NAME	

DATE	
BY	
REVIEWED	
PLOTTED	
GRADES CHECKED	
STRUCTURE NOTATIONS CHECKED	
NOTE BOOK NO.	
ADD FILE NAME	

DRIVER = I:\Bentley\Projects\11001\11001\11001.dwg
 FILE NAME = S:\REV\11001\11001\11001.dwg

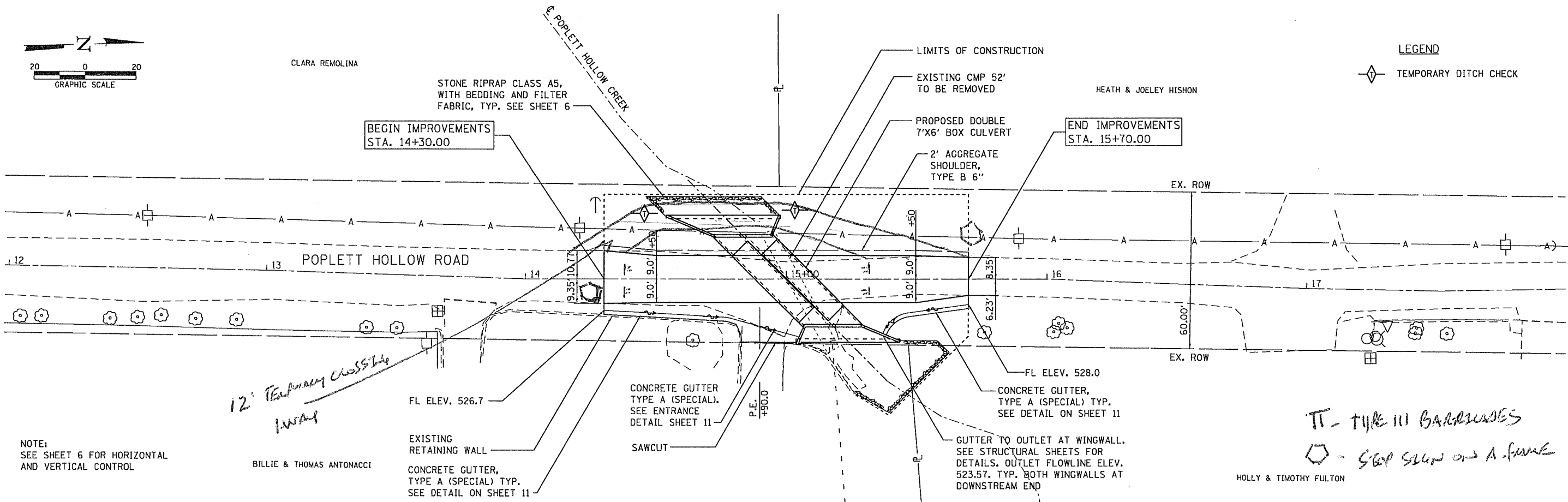

NOTE:
 SEE SHEET 6 FOR HORIZONTAL
 AND VERTICAL CONTROL

12' Temporary Crosswalk
 BILLIE & THOMAS ANTONACCI

TT - TYPE III BARBICUTES
○ - STOP SIGN ON A FRAME
 HOLLY & TIMOTHY FULTON

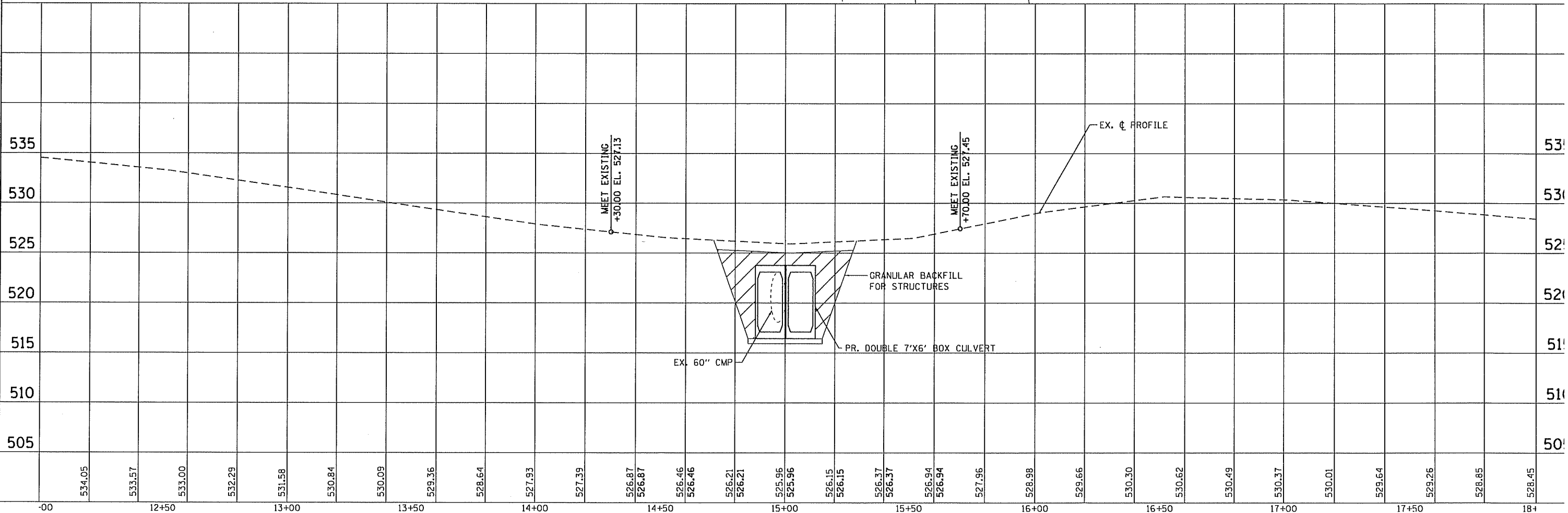

534.05	533.57	533.00	532.29	531.58	530.84	530.09	529.36	528.64	527.93	527.39	526.87	526.87	526.46	526.46	526.21	526.21	525.96	525.96	526.15	526.15	526.37	526.37	526.94	526.94	527.96	528.98	529.66	530.30	530.62	530.49	530.37	530.01	529.64	529.26	528.85	528.45
-00	12+50	13+00	13+50	14+00	14+50	15+00	15+50	16+00	16+50	17+00	17+50	18+																								



USER NAME = msj	DESIGNED -	REVISED -
PRINTER =	DRAWN -	REVISED -
PLOT SCALE = 40.00' / 1"	CHECKED -	REVISED -
PLOT DATE = 5/21/2014	DATE -	REVISED -

STATE OF ILLINOIS
 DEPARTMENT OF TRANSPORTATION

PLAN AND PROFILE - POPLETT HOLLOW ROAD

SCALE:	SHEET NO.	OF	SHEETS	STA.	TO	STA.
--------	-----------	----	--------	------	----	------

F.A. RTE.	SECTION	COUNTY	TOTAL SHEETS	SHE NO.
	N/A	PEORIA	11	5
CONTRACT NO.				
ILLINOIS FED. AID PROJECT				



CITY OF PEORIA SUB-CONTRACTOR UTILIZATION STATEMENT

Section I (select all that apply)

- MBE/WBE Subcontractor(s) will be utilized on this project
 Non MBE/WBE Subcontractor(s) will be utilized on this project

Section II: Prime Contractor

Name: OTTOBAUM COMPANY, INC.
 Address: 866 N MAIN ST. MORTON, IL
 Phone: 309-266-7114
 Contact Person: RICH MILLER
 Email: richmiller@ottobaum.com
 Ownership Status: MBE WBE M/WBE Non-M/WBE

Project

Name: POPLETT HOLLOW ROAD REPAIR
 Total Contract Value: 209,983

Section III: Selected Subcontractors

Subcontractor Name	MBE, WBE or Non M/WBE	Amount	% of Total Contract	Scope of Work
THORNTON RAVE	MBE	26,748	10%	BOX CULVERT SUPPLY
CJL LANDSCAPING	WBE	1,625	1%	LANDSCAPING
CNS FORESTRY	WBE	11,450	4%	CLEARING
MCS	WBE	3,200	1%	TRAFFIC CONTROL
KENNEL TRUCKING	NON	16,520.35	6%	TRUCKING
TAZEWELL CO. ASPHALT	NON	8,400	3%	ASPHALT
TOTALS				

**If more than seven firms are utilized, please copy the form and attach the additional information.*

Section IV: Subcontractors that submitted bids but were not selected (M/WBE Only)

Subcontractor Name	Scope of Work Bid	Denial Reason
MILLENNIA	LANDSCAPING	NOT LOWEST QUOTE
WARD'S CUSTOM LANDSCAPING	LANDSCAPING	NOT LOWEST QUOTE
N.E. RUDD TRUCKING	TRUCKING	NOT LOWEST QUOTE

**If more than seven firms submitted quotes, please copy the form and attach the additional information.*

-----Continues on next page-----

For Office Use Only
 Reviewed by: _____

Section V: Subcontractors Contacted (M/WBE Only)

Subcontractor Name	Method of Contact	Contact Outcome

**If more than six firms were contacted, please copy the form and attach the additional information*

Section IV

The City of Peoria is committed to promoting equal opportunity and has established the following subcontractor utilization goals for city funded construction projects: 10% MBE and 5% WBE. Prime Contractors have an obligation to make a good faith effort to advance the city's commitment to increase diversity among the firms working on city construction projects.

This form must be completed and submitted with bid proposals. ALL subcontractors intended for use on this project shall be listed in the Section III above; along with the total amount to be paid to the subcontractors; percentage of total contract; and scope of work. If for whatever reason the prime contractor has to utilize a subcontractor not listed above, they must submit a Notification of Change in Participation.

The undersigned certifies that the information included herein is true and correct; the subcontractors listed above have agreed to perform the scope of work described. The undersigned further certifies that it has no controlling, dominating or conflict of interest in any of the listed subcontractors.

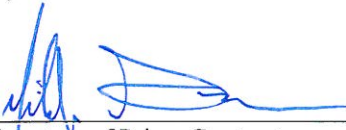

 Signature of Prime Contractor

6/13/14

 Date

For Office Use Only
 Reviewed by: _____

Org.: May 2008
 Revised: Feb. 2011