



Famsworth GROUP

7707 N. KNOWLIE AVE. SUITE 100
PEORIA, ILLINOIS 61614
6309 630-8888 / 765-6712

www.f-w.com
Engineers | Architects | Surveyors | Scientists

ISSUE: _____
Date: _____ Description: _____

PRELIMINARY

DRAFT
NOT FOR CONSTRUCTION

PROJECT:
Peoria School District 150

**Peoria High School
Athletic Facilities
Improvements**

Peoria, IL

Date: 12-02-13

Design/Drawn: JLH

Reviewed: JE

Book No.: - Field: -

SHEET TITLE:
PHOTOMETRICS PLAN

SHEET NUMBER:

E0.0

Project No.: 0131556.00

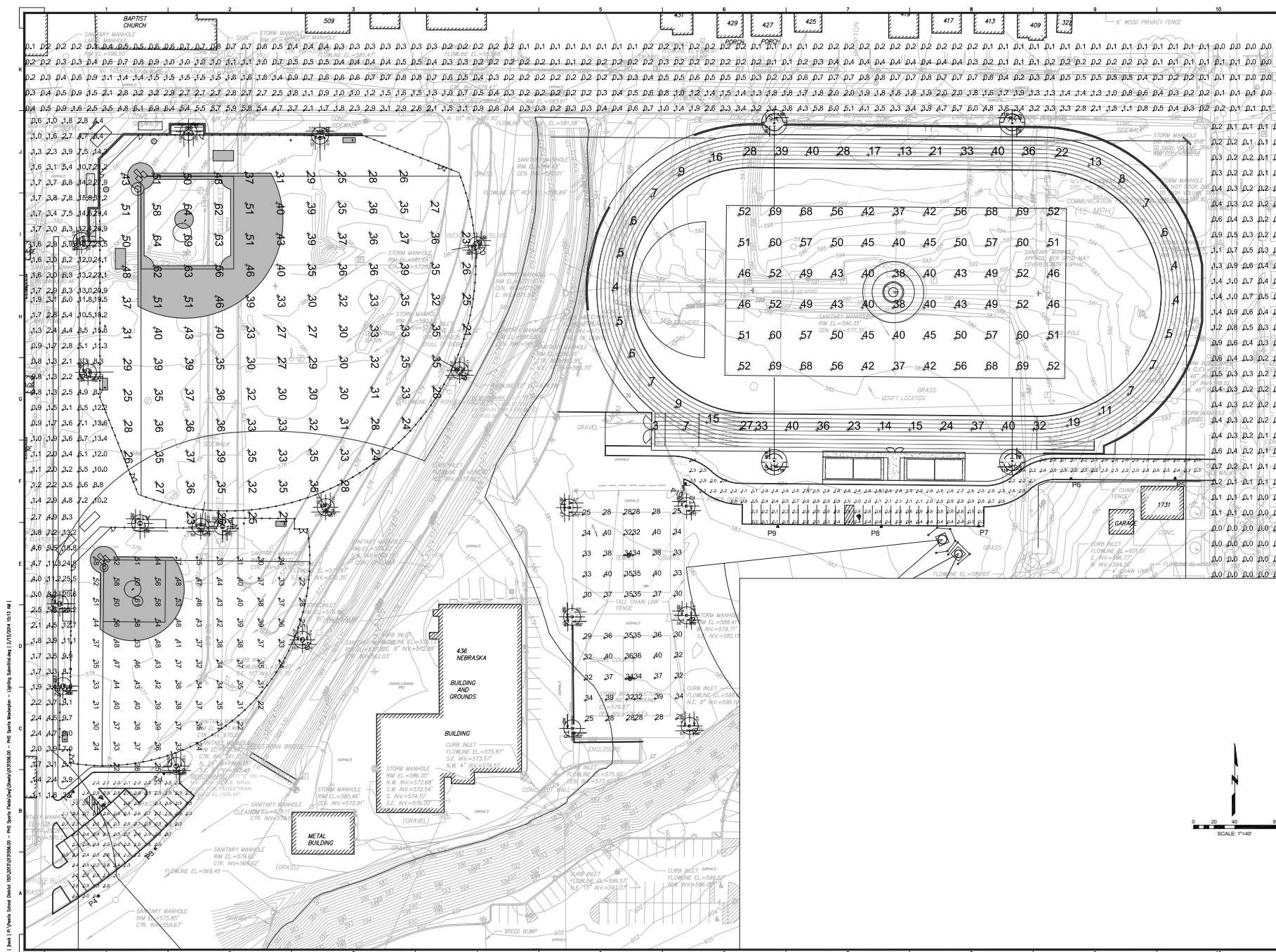

I:\proj\13\New School District 150\PHOTOMETRICS - Peoria School District 150\PHOTOMETRICS - Peoria School District 150.dwg 12/02/2013 03:13:41



D-Series Size 1 Mast Arm Mount LED Area Luminaire



d[®]series

Specifications

EPA: 0.9 ft²
(0.08 m²)

Length: 27"
(68.6 cm)

Width: 13"
(33.0 cm)

Height: 5"
(12.7 cm)

Weight (max): 26 lbs
(11.8 kg)

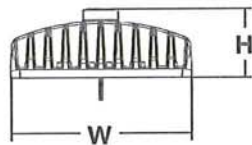
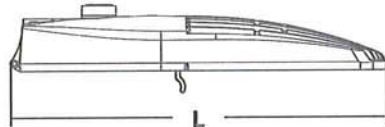

Catalog Number

Notes

Driveway & parking fixture

Type

Hit the Tab key or mouse over the page to see all interactive elements.

Introduction

The modern styling of the D-Series is striking yet unobtrusive - making a bold, progressive statement even as it blends seamlessly with its environment.

The D-Series distills the benefits of the latest in LED technology into a high performance, high efficacy, long-life luminaire. The outstanding photometric performance results in sites with excellent uniformity, greater pole spacing and lower power density. It is ideal for replacing 100 – 400W metal halide in pedestrian and area lighting applications with typical energy savings of 65% and expected service life of over 100,000 hours.

Ordering Information

EXAMPLE: DSX1 LED 2 30B700/40K SR3 MVOLT MA DDBXD

DSX1 LED

Series	Light Engines	Performance Package ¹	Distribution	Voltage	Mounting	Options	Finish (Applied)
DSX1 LED	1 One engine (30 LEDs)	530 mA options: 30B530/30K 3000K 30B530/40K 4000K 30B530/50K 5000K 700 mA options: 30B700/30K 3000K 30B700/40K 4000K 30B700/50K 5000K	SR2 Type II	MVOLT ²	MA Mast arm ready	Shipped installed (blank) No NEMA twist-lock receptacle (decorative cover), wildlife shield, trigger latch, and bridge fitter. DMG 0-10V dimming driver (no controls) ⁴ PER NEMA twist-lock receptacle only (no controls) DCR Dimmable and controllable via ROAM [®] (no controls) ⁵ HS House-side shield ⁶ WTB Utility terminal block DS Dual switching ^{7,8} BUBLVL External bubble level	DDBXD Dark bronze
	2 Two engines (60 LEDs)		SR3 Type III	120 ³			DBLXD Black
			SR4 Type IV	208 ³			DNAXD Natural aluminum
			SR5 Type V	240 ³			DWHXD White
			FT Forward throw	277 ³			DDBTXD Textured dark bronze
				347 ³			DBLTXD Textured black
				480 ³			DNATXD Textured natural aluminum
							DWHGXD Textured white

Accessories

Ordered and shipped separately.

SBOR 10 GDR BZ 3V	Pole-mounted motion/ambient sensor, 8-15' mounting height, MVOLT (specify finish)
SBOR 6 GDR BZ 3V	Pole-mounted motion/ambient sensor, 15-30' mounting height, MVOLT (specify finish)
DLL127F 1.5 JU	Photocell - SSL twist-lock, MVOLT ⁹
DLL347F 1.5 CUL JU	Photocell - SSL twist-lock (347V) ⁹
DLL480F 1.5 CUL JU	Photocell - SSL twist-lock (480V) ⁹
SCU	Shorting cap ⁹
DSX1HSU	House-side shield (one per light engine)

For more control options, visit [Sensor Switch](#), [DTI](#) and [ROAM](#) online.

Visit Lithonia Lighting's [POLES CENTRAL](#) to see our wide selection of poles, accessories and educational tools.

NOTES

- Configured with 4000K (40K) provides the shortest lead times. Consult factory for 3000K (30K) and 5000K (50K) lead times.
- MVOLT driver operates on any line voltage from 120-277V (50/60Hz).
- Not available with single board, 530 mA product (1 30B530).
- Not available with 347 or 480V.
- Specifies a ROAM[®] enabled luminaire with 0-10V dimming capability; requires NEMA twist-lock receptacle. Not available with 347 or 480V. Additional hardware and services required for ROAM[®] deployment; must be purchased separately. Call 1-800-442-6745 or email: sales@roomservices.net.
- Also available as a separate accessory; see Accessories information at left.
- Requires two light engines. Provides 50% dimming capability via two independent drivers, each operating half the luminaire. N/A with PER, DCR, DMG, WTB or 530mA with 347v or 480v.
- Requires an additional switched line.
- Requires luminaire to be specified with PER option. Ordered and shipped as a separate line item.



Performance Data

Lumen Output

Lumen values are from photometric tests performed in accordance with IESNA LM-79-08. Data is considered to be representative of the configurations shown, within the tolerances allowed by Lighting Facts. Actual performance may differ as a result of end-user environment and application. Contact factory for performance data for any configurations not shown here.

Light Engines	Drive Current (mA)	Performance Package	System Watts	Dist. Type	40K (4000K, 67 CRI)					50K (5000K, 67 CRI)				
					Lumens	B	U	G	LPW	Lumens	B	U	G	LPW
1 (30 LEDs)	530	30B530/--K	55W	SR2	4634	1	0	1	84	5056	1	0	1	92
				SR3	4695	1	0	2	85	5123	1	0	2	93
				SR3 HS	3425	0	0	1	61	3737	0	0	1	68
				SR4	4694	1	0	2	85	5122	1	0	2	93
				SR4 HS	3459	0	0	1	62	3774	0	0	1	69
				SR5	4696	3	0	1	85	5124	3	0	1	93
	FT	4694	1	0	1	85	5122	1	0	2	93			
	700	30B700/--K	73W	SR2	5679	1	0	1	77	6223	2	0	2	85
				SR3	5835	1	0	2	79	6394	2	0	2	88
				SR3 HS	4239	0	0	2	58	4645	0	0	2	64
				SR4	5798	1	0	2	79	6354	1	0	2	87
				SR4 HS	4294	0	0	2	58	4706	0	0	2	64
SR5				5769	3	0	1	79	6322	3	0	2	87	
FT	5820	1	0	2	79	6378	1	0	2	87				
2 (60 LEDs)	530	30B530/--K	106W	SR2	9109	2	0	2	86	9929	2	0	2	93
				SR3	9257	2	0	2	87	10,010	2	0	3	94
				SR3 HS	6717	0	0	2	64	7302	0	0	2	69
				SR4	9204	2	0	2	87	10,010	2	0	2	94
				SR4 HS	6900	0	0	2	64	7446	0	0	2	70
				SR5	9223	4	0	2	87	10,198	4	0	2	96
	FT	9183	2	0	2	87	10,020	2	0	2	95			
	700	30B700/--K	143W	SR2	11,170	2	0	2	78	12,312	3	0	3	86
				SR3	11,391	2	0	3	80	12,462	2	0	3	87
				SR3 HS	8285	0	0	2	58	9047	0	0	2	63
				SR4	11,332	2	0	2	79	12,368	2	0	3	86
				SR4 HS	8318	0	0	2	58	9149	0	0	2	64
SR5				11,723	4	0	2	82	12,455	4	0	2	87	
FT	11,662	2	0	3	82	12,531	2	0	3	87				

Lumen Ambient Temperature (LAT) Multipliers

Use these factors to determine relative lumen output for average ambient temperatures from 0-40°C (32-104°F).

Ambient	Lumen Multiplier
0°C	1.02
10°C	1.01
20°C	1.00
25°C	1.00
30°C	1.00
40°C	0.99

Projected LED Lumen Maintenance

Data references the extrapolated performance projections for the DSX1 LED 2 30B700 platform in a 40°C ambient, based on 10,000 hours of LED testing (tested per IESNA LM-80-08 and projected per IESNA TM-21-11).

To calculate LLF, use the lumen maintenance factor that corresponds to the desired number of operating hours below. For other lumen maintenance values, contact factory.

Operating Hours	0	25,000	50,000	100,000
Lumen Maintenance Factor	1.0	0.95	0.92	0.87

Electrical Load

Light Engines	Drive Current (mA)	System Watts	Current (A)					
			120	208	240	277	347	480
1	530	55 W	0.46	0.26	0.23	0.20	0.16	0.11
	700	73 W	0.61	0.35	0.30	0.26	0.21	0.15
2	530	106 W	0.89	0.51	0.44	0.38	0.31	0.22
	700	143 W	1.19	0.69	0.60	0.52	0.41	0.30

Photometric Diagrams

To see complete photometric reports or download .ies files for this product, visit Lithonia Lighting's D-Series Area Size 1 homepage.

Isofootcandle plots for the DSX1 LED 2 30B700/50K SR3. Distances are in units of mounting height (20').

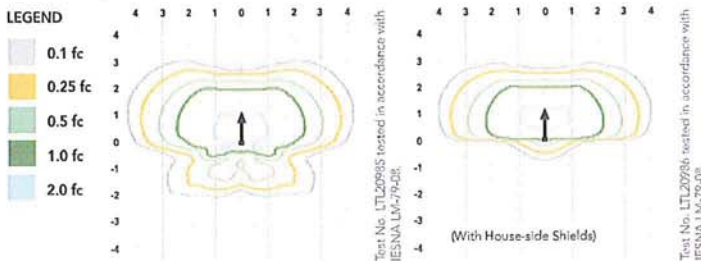

Distribution overlay comparisons to 250W and 400W metal halide.

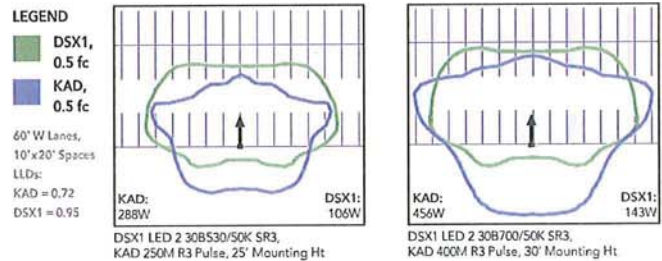

FEATURES & SPECIFICATIONS

INTENDED USE

The sleek design of the D-Series Size 1 reflects the embedded high performance LED technology. It is ideal for many commercial and municipal applications, such as parking lots, plazas, campuses, and streetscapes.

CONSTRUCTION

Single-piece die-cast aluminum housing has integral heat sink fins to optimize thermal management through conductive and convective cooling. Modular design allows for ease of maintenance and future light engine upgrades. The LED driver is mounted in direct contact with the casting to promote low operating temperature and long life. Low EPA (0.9 ft) for optimized pole wind loading.

FINISH

Exterior parts are protected by a zinc-infused Super Durable TGIC thermoset powder coat finish that provides superior resistance to corrosion and weathering. A tightly controlled multi-stage process ensures a minimum 3 mils thickness for a finish that can withstand extreme climate changes without cracking or peeling. Available in both textured and non-textured finishes.

OPTICS

Precision-molded proprietary acrylic lenses are engineered for superior area lighting distribution, uniformity, and pole spacing. Light engines are available in 3000K (80 CRI), 4000K (67 CRI) or 5000K (67 CRI) configurations. The D-Series Size 1 has zero uplight and qualifies as a Nighttime Friendly™ product, meaning it is consistent with the LEED® and Green Globes™ criteria for eliminating wasteful uplight.

ELECTRICAL

Light engine(s) consist of 30 high-efficacy LEDs mounted to a metal-core circuit board to maximize heat dissipation and promote long life (100,000 hrs at 40°C, L87). Class 1 electronic driver has a power factor >90%, THD <20%, and has an expected life of 100,000 hours with <1% failure rate. Easily-serviceable surge protection device meets a minimum Category C Low operation (per ANSI/IEEE C62.41.2).

INSTALLATION

Four-bolt mast arm mount provides easy, secure installation for nominal 1-1/4" to 2" diameter arms (1-5/8" to 2-3/8" O.D.) and enables the D-Series Size 1 to withstand up to a 3.0 G vibration load rating per ANSI C136.31. Housing includes cast-in wildlife shield. Die-cast trigger latch on door provides tool-less entry for easy and secure opening with one hand; top-side leveling crosshairs and internal bubble level assist with installation.

LISTINGS

CSA certified to U.S. and Canadian standards. Light engines are IP66 rated. Rated for -40°C minimum ambient. U.S. D663,462 S. International patents pending.

DesignLights Consortium® (DLC) qualified product. Not all versions of this product may be DLC qualified. Please check the DLC Qualified Products List at www.designlights.org to confirm which versions are qualified.

WARRANTY

Five year limited warranty. Full warranty terms located at www.acuitybrands.com/CustomerResources/Terms_and_conditions.asp.

Note: Specifications subject to change without notice.



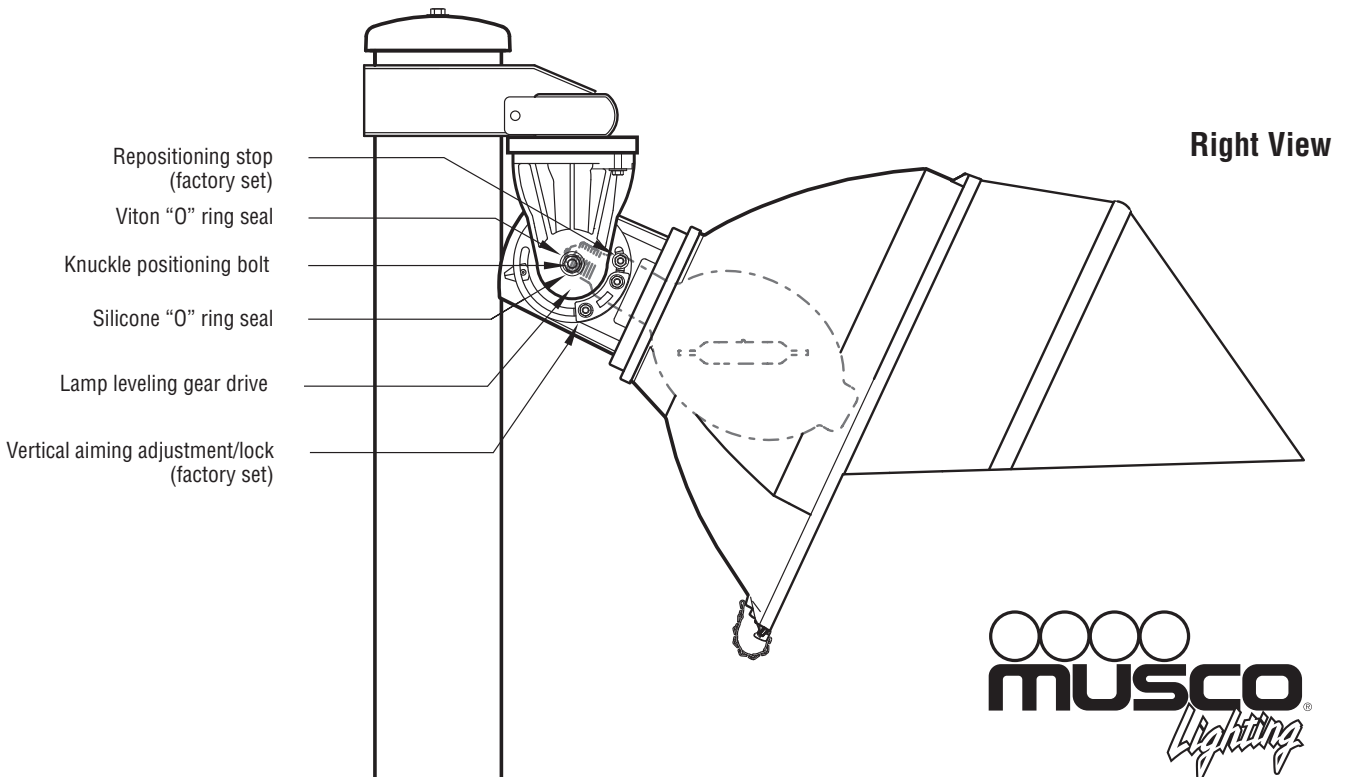
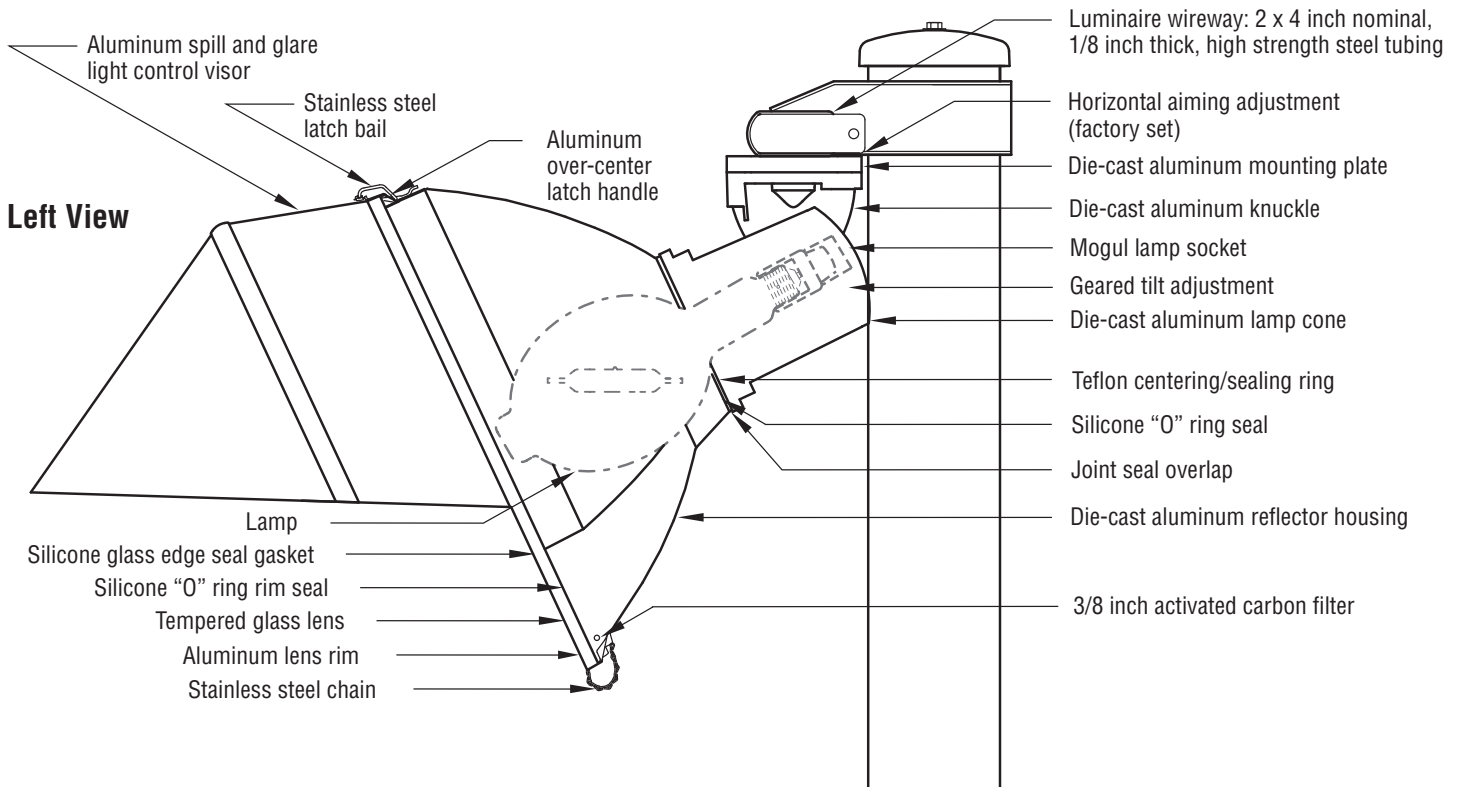

800/825-6030
www.musco.com
lighting@musco.com

Copyright © Musco Lighting, Inc. 2014
 All rights reserved. Musco Lighting, Inc.
 is a registered trademark of Musco Lighting, Inc.

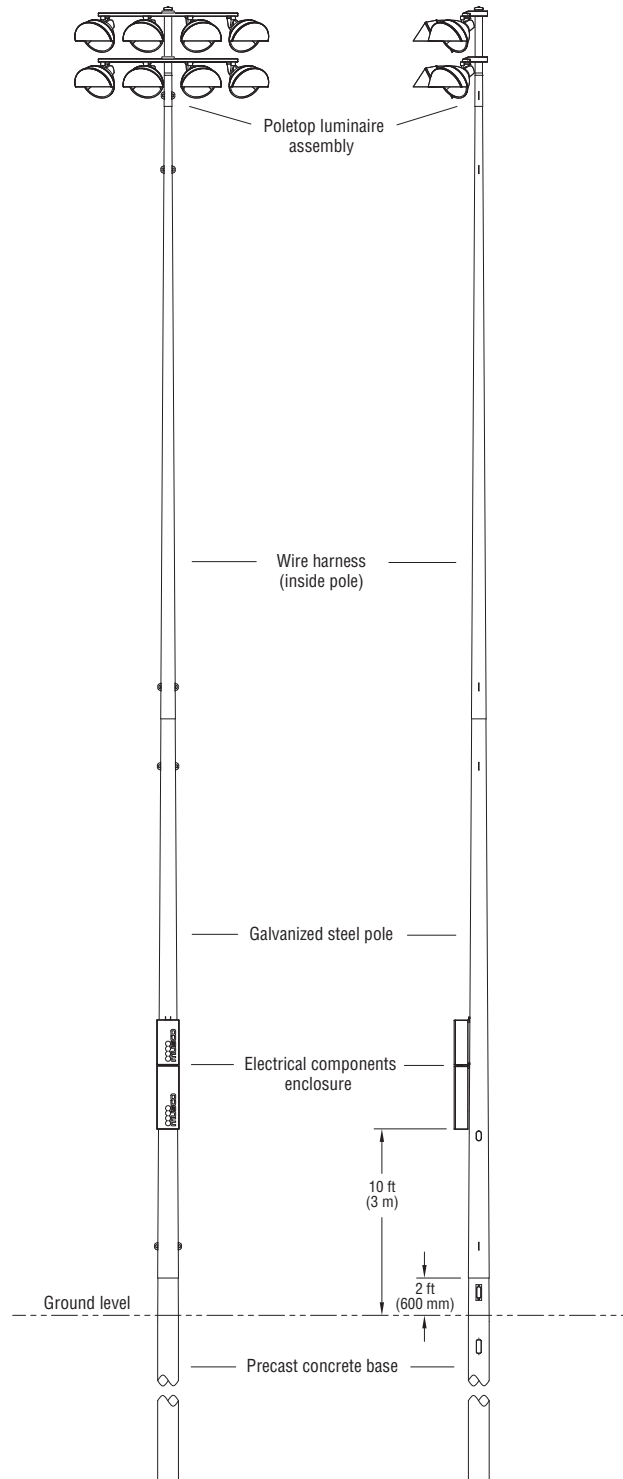

PRELIMINARY

COMPONENT NO.	LSG-08
DRAWING BY	RWS
DATE	10/23/13
DRAWING NUMBER	M-1223-91US-5
SCALE	Not to scale

Light-Structure Green™ system
 (8) metal halide luminaire
 Typical configuration



CORPORATE OFFICE:
 P.O. Box 508
 100 1st Avenue West
 Okaloosa, Iowa 52577
 +1-800-825-6020
 +1-641-673-0411



EQUIPMENT LIST FOR AREAS SHOWN								
Pole				Luminaires				
QTY	LOCATION	SIZE	GRADE ELEVATION	MOUNTING HEIGHT	LAMP TYPE	QTY / POLE	THIS GRID	OTHER GRIDS
4	S1-S4	80'	-	80'	1500W MZ	13	13	0
TOTALS						52	52	0

MY PROJECT	
Name:	Peoria Central High School Complex
Location:	Peoria, IL

GRID SUMMARY	
Name:	Soccer
Size:	330' x 165'
Spacing:	30.0' x 30.0'
Height:	3.0' above grade

CONSTANT ILLUMINATION	
SUMMARY	HORIZONTAL FOOTCANDLES
Entire Grid	
Guaranteed Average:	50
Scan Average:	50.7
Maximum:	69
Minimum:	37
Avg / Min:	1.36
Guaranteed Max / Min:	2
Max / Min:	1.84
UG (adjacent pts):	1.32
CU:	0.43
No. of Points:	66
LUMINAIRE INFORMATION	
Luminaire Type:	Green Generation
Rated Lamp Life:	5,000 hours
Design Lumens:	134,000
Avg Lamp Tilt Factor:	1.000
No. of Luminaires:	52
Avg KW:	81.33 (88.4 max)

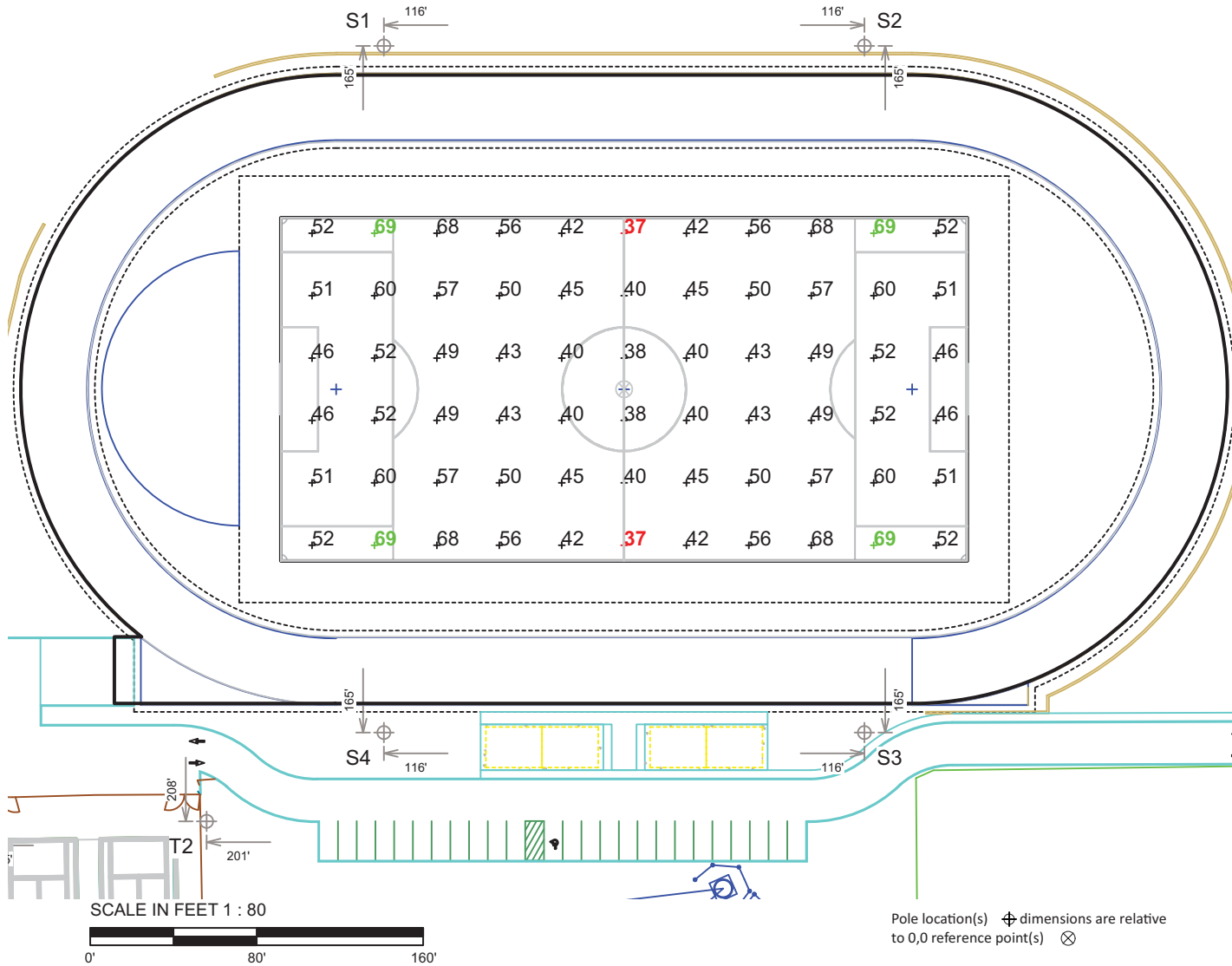

Guaranteed Performance: The Guaranteed Average CONSTANT ILLUMINATION described above is guaranteed for the rated life of the lamp.

Field Measurements: Illumination measured in accordance with IESNA LM-5-04 and CIBSE LG4. Individual values may vary. See the Warranty document for details.

Electrical System Requirements: Refer to Amperage Draw Chart and/or the "Musco Control System Summary" for electrical sizing.

Installation Requirements: Results assume +/- 3% nominal voltage at line side of the ballast and structures located within 3 feet (1m) of design locations.

ENGINEERED DESIGN		
By:	Eric Svenby	
File # / Date:	167924B	27-Feb-14

Not to be reproduced in whole or part without the written consent of Musco Sports Lighting, LLC. ©1981, 2014 Musco Sports Lighting, LLC.



EQUIPMENT LIST FOR AREAS SHOWN								
Pole				Luminaires				
QTY	LOCATION	SIZE	GRADE ELEVATION	MOUNTING HEIGHT	LAMP TYPE	QTY / POLE	THIS GRID	OTHER GRIDS
2	T1-T2	50'	-	50'	1000W MZ	2	2	0
2	T3-T4	50'	-	50'	1000W MZ	4	2	2
TOTALS						12	8	4

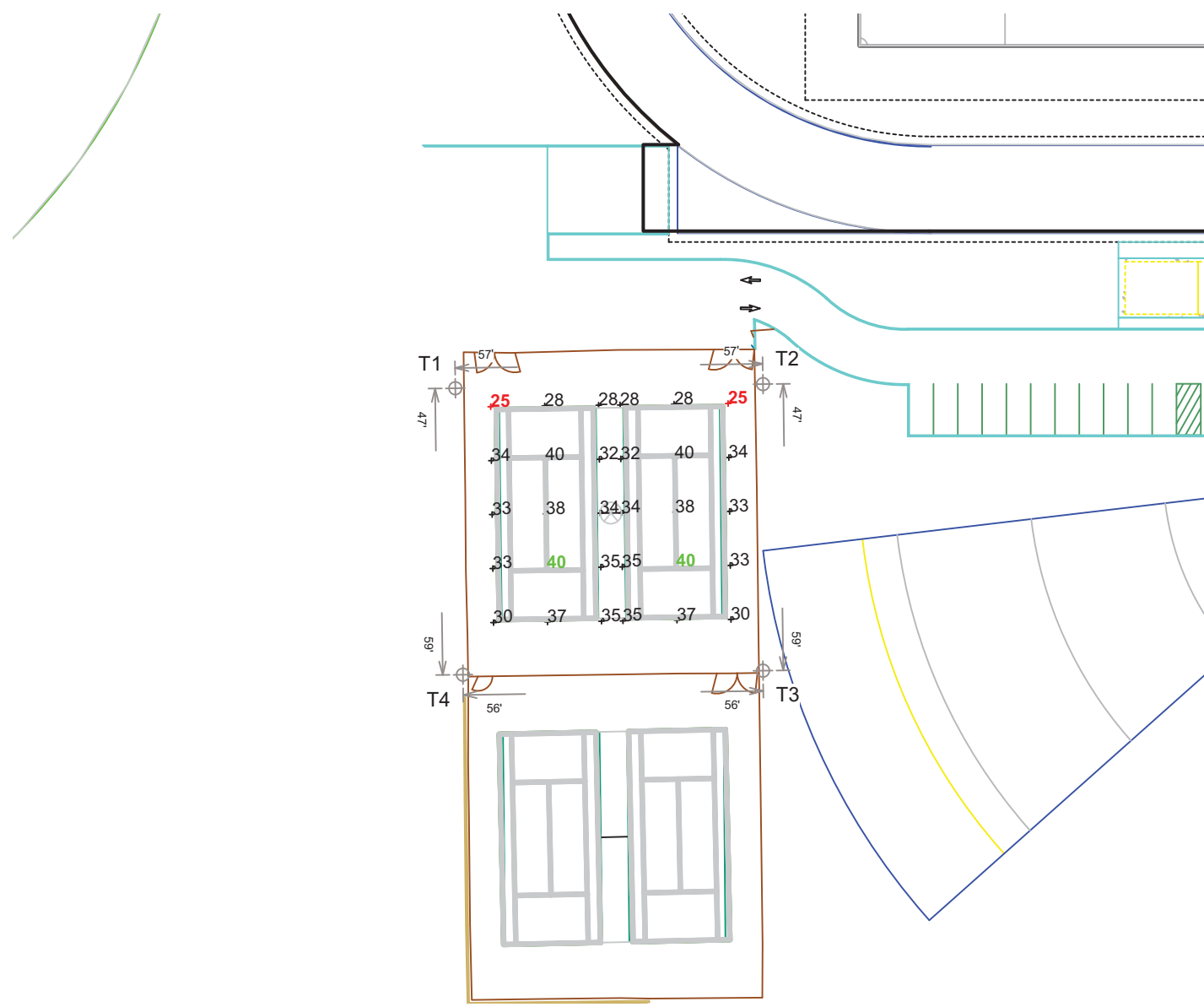

MY PROJECT	
Name:	Peoria Central High School Complex
Location:	Peoria, IL

GRID SUMMARY	
Name:	Tennis 1-2
Size:	2 Court - 12' Spacing
Spacing:	20.0' x 20.0'
Height:	3.0' above grade

CONSTANT ILLUMINATION SUMMARY		HORIZONTAL FOOTCANDLES
		Entire Grid
Guaranteed Average:		30
Scan Average:		33.4
Maximum:		40
Minimum:		25
Avg / Min:		1.34
Guaranteed Max / Min:		2.5
Max / Min:		1.60
UG (adjacent pts):		0.00
CU:		0.57
No. of Points:		30
LUMINAIRE INFORMATION		
Luminaire Type:	Green Generation	
Rated Lamp Life:	12,000 hours	
Design Lumens:	88,000	
Avg Lamp Tilt Factor:	1.000	
No. of Luminaires:	8	
Avg KW:	8.96 (10.4 max)	

Guaranteed Performance: The Guaranteed Average CONSTANT ILLUMINATION described above is guaranteed for the rated life of the lamp.

Field Measurements: Illumination measured in accordance with IESNA LM-5-04 and CIBSE LG4. Individual values may vary. See the Warranty document for details.

Electrical System Requirements: Refer to Amperage Draw Chart and/or the "Musco Control System Summary" for electrical sizing.

Installation Requirements: Results assume +/- 3% nominal voltage at line side of the ballast and structures located within 3 feet (1m) of design locations.

ENGINEERED DESIGN		
By:	Eric Svenby	
File # / Date:	167924B	27-Feb-14

Not to be reproduced in whole or part without the written consent of Musco Sports Lighting, LLC. ©1981, 2014 Musco Sports Lighting, LLC.



EQUIPMENT LIST FOR AREAS SHOWN								
Pole				Luminaires				
QTY	LOCATION	SIZE	GRADE ELEVATION	MOUNTING HEIGHT	LAMP TYPE	QTY / POLE	THIS GRID	OTHER GRIDS
2	T3-T4	50'	-	50'	1000W MZ	4	2	2
2	T5-T6	50'	-	50'	1000W MZ	2	2	0
4	TOTALS					12	8	4

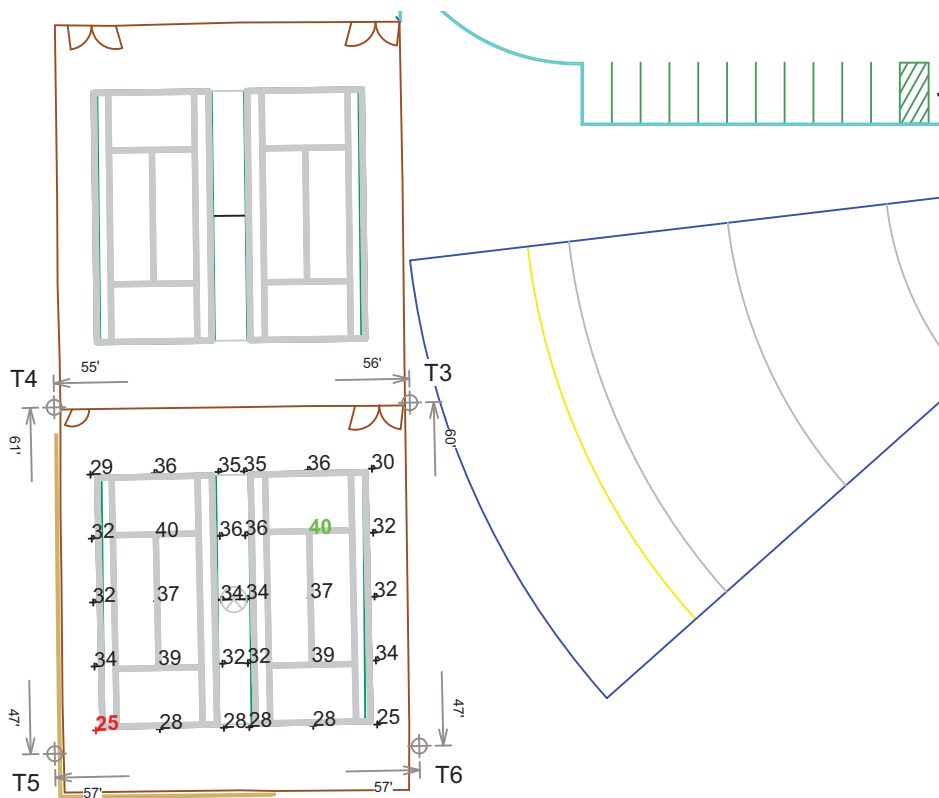

MY PROJECT	
Name:	Peoria Central High School Complex
Location:	Peoria, IL

GRID SUMMARY	
Name:	Tennis 3-4
Size:	2 Court - 12' Spacing
Spacing:	20.0' x 20.0'
Height:	3.0' above grade

CONSTANT ILLUMINATION	
SUMMARY	HORIZONTAL FOOTCANDLES
	Entire Grid
Guaranteed Average:	30
Scan Average:	33.2
Maximum:	40
Minimum:	25
Avg / Min:	1.31
Guaranteed Max / Min:	2.5
Max / Min:	1.58
UG (adjacent pts):	0.00
CU:	0.57
No. of Points:	30
LUMINAIRE INFORMATION	
Luminaire Type:	Green Generation
Rated Lamp Life:	12,000 hours
Design Lumens:	88,000
Avg Lamp Tilt Factor:	1.000
No. of Luminaires:	8
Avg KW:	8.96 (10.4 max)

Guaranteed Performance: The Guaranteed Average CONSTANT ILLUMINATION described above is guaranteed for the rated life of the lamp.

Field Measurements: Illumination measured in accordance with IESNA LM-5-04 and CIBSE LG4. Individual values may vary. See the Warranty document for details.

Electrical System Requirements: Refer to Amperage Draw Chart and/or the "Musco Control System Summary" for electrical sizing.

Installation Requirements: Results assume +/- 3% nominal voltage at line side of the ballast and structures located within 3 feet (1m) of design locations.

ENGINEERED DESIGN		
By:	Eric Svenby	
File # / Date:	167924B	27-Feb-14

Not to be reproduced in whole or part without the written consent of Musco Sports Lighting, LLC. ©1981, 2014 Musco Sports Lighting, LLC.

SCALE IN FEET 1 : 60

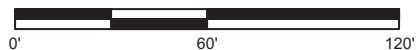

Pole location(s) ⊕ dimensions are relative to 0,0 reference point(s) ⊗



EQUIPMENT LIST FOR AREAS SHOWN								
Pole				Luminaires				
QTY	LOCATION	SIZE	GRADE ELEVATION	MOUNTING HEIGHT	LAMP TYPE	QTY / POLE	THIS GRID	OTHER GRIDS
4	S1-S4	80'	-	80'	1500W MZ	13	13	0
4	TOTALS					52	52	0

MY PROJECT	
Name:	Peoria Central High School Complex
Location:	Peoria, IL

GRID SUMMARY	
Name:	Track
Size:	Irregular
Spacing:	30.0' x 30.0'
Height:	3.0' above grade

CONSTANT ILLUMINATION	
SUMMARY	HORIZONTAL FOOTCANDLES
	Entire Grid
Scan Average:	18.0
Maximum:	40
Minimum:	3
Avg / Min:	6.22
Max / Min:	13.86
UG (adjacent pts):	0.00
CU:	0.11
No. of Points:	46
LUMINAIRE INFORMATION	
Luminaire Type:	Green Generation
Rated Lamp Life:	5,000 hours
Design Lumens:	134,000
Avg Lamp Tilt Factor:	1.000
No. of Luminaires:	52
Avg KW:	81.33 (88.4 max)

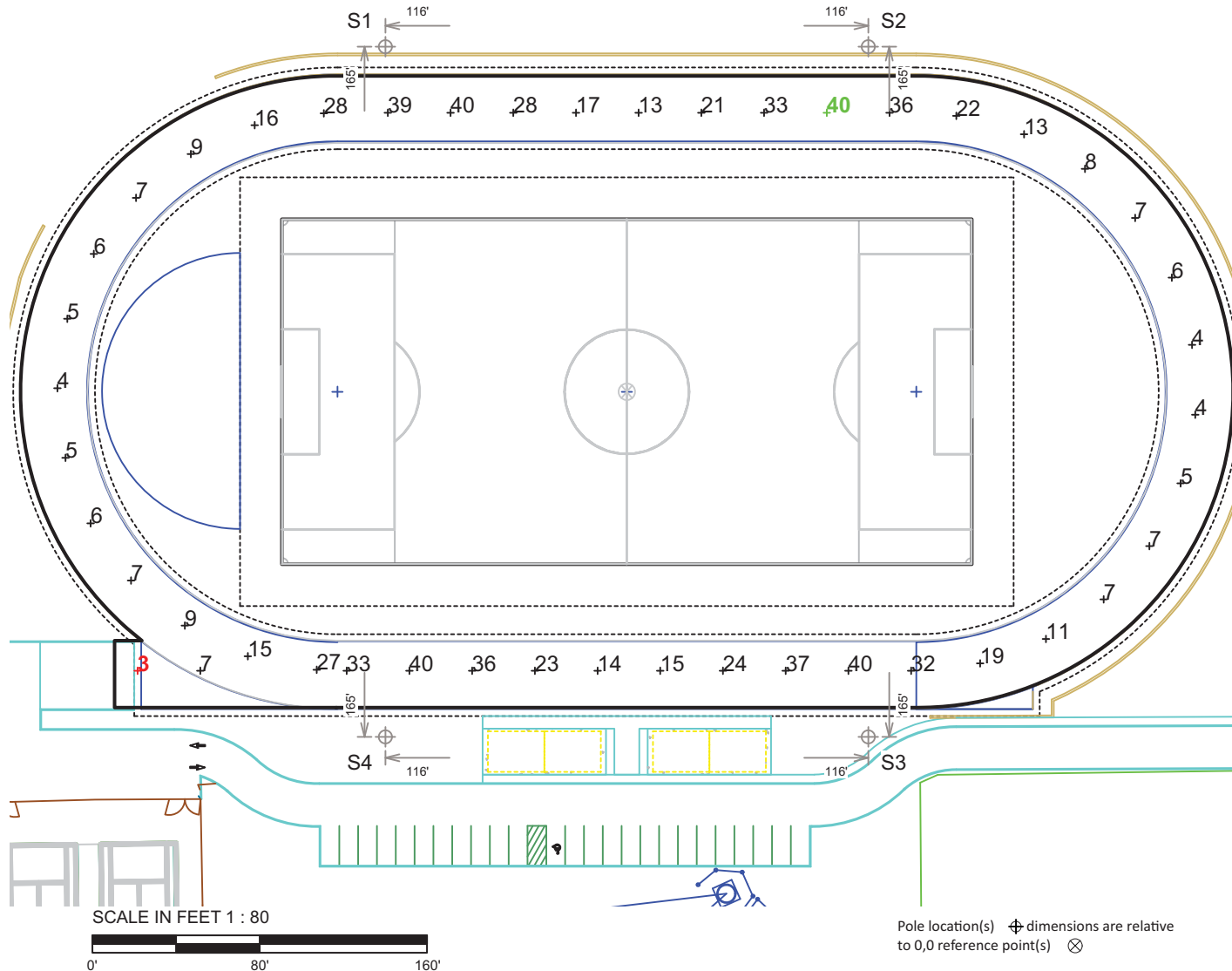

Guaranteed Performance: The CONSTANT ILLUMINATION described above is guaranteed for the rated life of the lamp.

Field Measurements: Illumination measured in accordance with IESNA LM-5-04 and CIBSE LG4. Individual values may vary. See the Warranty document for details.

Electrical System Requirements: Refer to Amperage Draw Chart and/or the "Musco Control System Summary" for electrical sizing.

Installation Requirements: Results assume +/- 3% nominal voltage at line side of the ballast and structures located within 3 feet (1m) of design locations.

ENGINEERED DESIGN		
By:	Eric Svenby	
File # / Date:	167924B	27-Feb-14

Not to be reproduced in whole or part without the written consent of Musco Sports Lighting, LLC. ©1981, 2014 Musco Sports Lighting, LLC.



EQUIPMENT LIST FOR AREAS SHOWN

Pole				Luminaires				
QTY	LOCATION	SIZE	GRADE ELEVATION	MOUNTING HEIGHT	LAMP TYPE	QTY / POLE	THIS GRID	OTHER GRIDS
6	A1-A2 B1-B2 C1-C2	60'	-	60'	1500W MZ	3	3	0
TOTALS						18	18	0

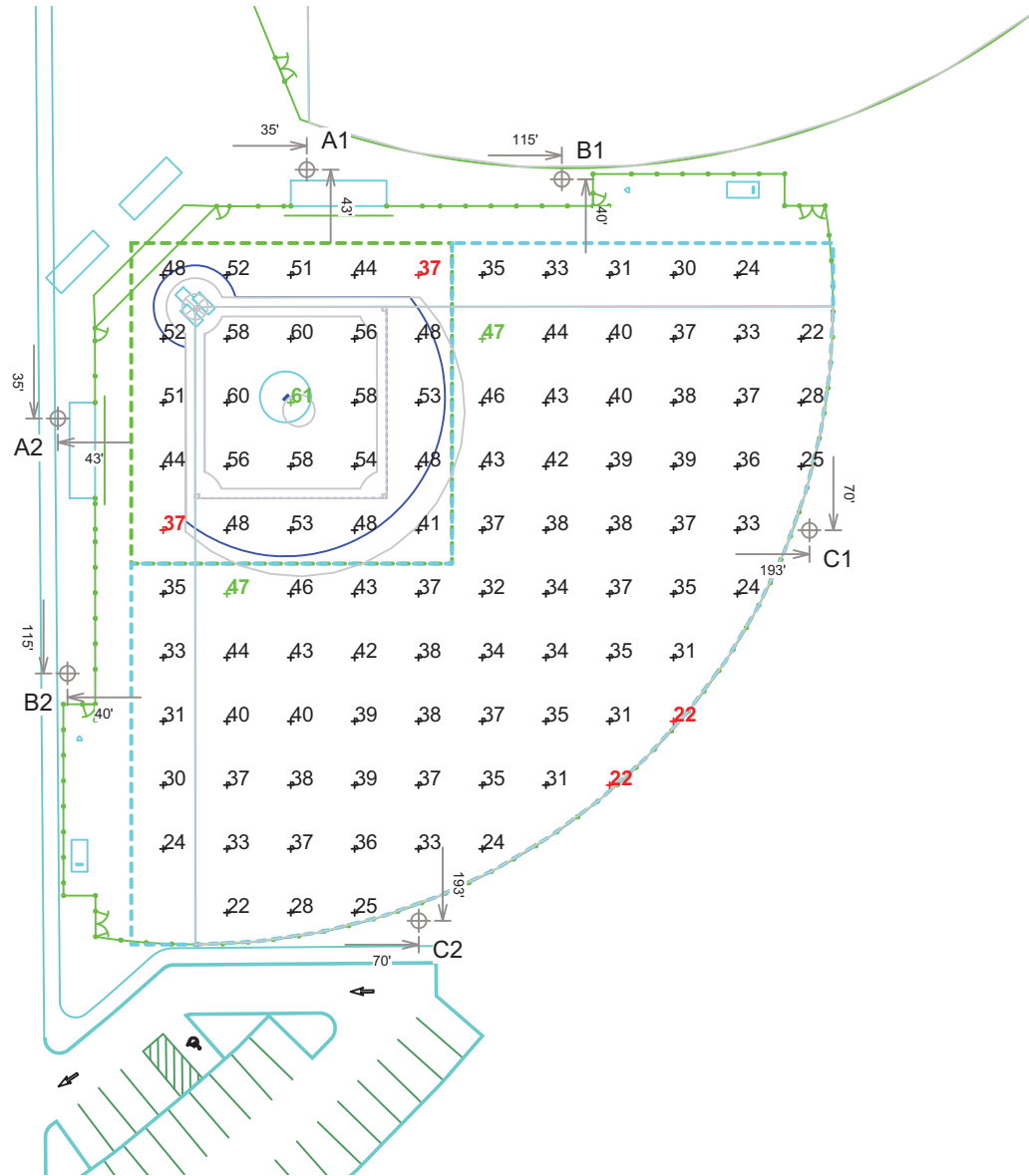

MY PROJECT

Name: Peoria Central High School Complex
Location: Peoria, IL

GRID SUMMARY

Name: Softball
Size: 200'/200'/200' - basepath 60'
Spacing: 20.0' x 20.0'
Height: 3.0' above grade

CONSTANT ILLUMINATION

SUMMARY	HORIZONTAL FOOTCANDLES	
	Infield	Outfield
Guaranteed Average:	50	30
Scan Average:	51.0	35.0
Maximum:	61	47
Minimum:	37	22
Avg / Min:	1.39	1.62
Guaranteed Max / Min:	2	2.5
Max / Min:	1.67	2.17
UG (adjacent pts):	1.32	1.51
CU:	0.64	
No. of Points:	25	73

LUMINAIRE INFORMATION	
Luminaire Type:	Green Generation
Rated Lamp Life:	5,000 hours
Design Lumens:	134,000
Avg Lamp Tilt Factor:	1.000
No. of Luminaires:	18
Avg KW:	28.15 (30.6 max)

Guaranteed Performance: The Guaranteed Average CONSTANT ILLUMINATION described above is guaranteed for the rated life of the lamp.

Field Measurements: Illumination measured in accordance with IESNA LM-5-04 and CIBSE LG4. Individual values may vary. See the Warranty document for details.

Electrical System Requirements: Refer to Amperage Draw Chart and/or the "Musco Control System Summary" for electrical sizing.

Installation Requirements: Results assume +/- 3% nominal voltage at line side of the ballast and structures located within 3 feet (1m) of design locations.

ENGINEERED DESIGN

By: Eric Svenby
File # / Date: 167924B 27-Feb-14

Not to be reproduced in whole or part without the written consent of Musco Sports Lighting, LLC. ©1981, 2014 Musco Sports Lighting, LLC.



EQUIPMENT LIST FOR AREAS SHOWN								
Pole				Luminaires				
QTY	LOCATION	SIZE	GRADE ELEVATION	MOUNTING HEIGHT	LAMP TYPE	QTY / POLE	THIS GRID	OTHER GRIDS
2	A3-A4	70'	-	70'	1500W MZ	5	5	0
2	B3-B4	80'	-	80'	1500W MZ	8	8	0
4	C3-C4 D1-D2	70'	-	70'	1500W MZ	4	4	0
8	TOTALS					42	42	0

MY PROJECT	
Name:	Peoria Central High School Complex
Location:	Peoria, IL

GRID SUMMARY	
Name:	Baseball
Size:	310'/360'/310' - basepath 90'
Spacing:	30.0' x 30.0'
Height:	3.0' above grade

CONSTANT ILLUMINATION		
SUMMARY	HORIZONTAL FOOTCANDLES	
	Infield	Outfield
Guaranteed Average:	50	30
Scan Average:	52.3	32.3
Maximum:	69	43
Minimum:	37	21
Avg / Min:	1.41	1.54
Guaranteed Max / Min:	2	2.5
Max / Min:	1.85	2.05
UG (adjacent pts):	1.36	1.67
CU:	0.71	
No. of Points:	25	96
LUMINAIRE INFORMATION		
Luminaire Type:	Green Generation	
Rated Lamp Life:	5,000 hours	
Design Lumens:	134,000	
Avg Lamp Tilt Factor:	1.000	
No. of Luminaires:	42	
Avg KW:	65.69 (71.4 max)	

Guaranteed Performance: The Guaranteed Average CONSTANT ILLUMINATION described above is guaranteed for the rated life of the lamp.

Field Measurements: Illumination measured in accordance with IESNA LM-5-04 and CIBSE LG4. Individual values may vary. See the Warranty document for details.

Electrical System Requirements: Refer to Amperage Draw Chart and/or the "Musco Control System Summary" for electrical sizing.

Installation Requirements: Results assume +/- 3% nominal voltage at line side of the ballast and structures located within 3 feet (1m) of design locations.

ENGINEERED DESIGN		
By:	Eric Svenby	
File # / Date:	167924B	27-Feb-14

Not to be reproduced in whole or part without the written consent of Musco Sports Lighting, LLC. ©1981, 2014 Musco Sports Lighting, LLC.

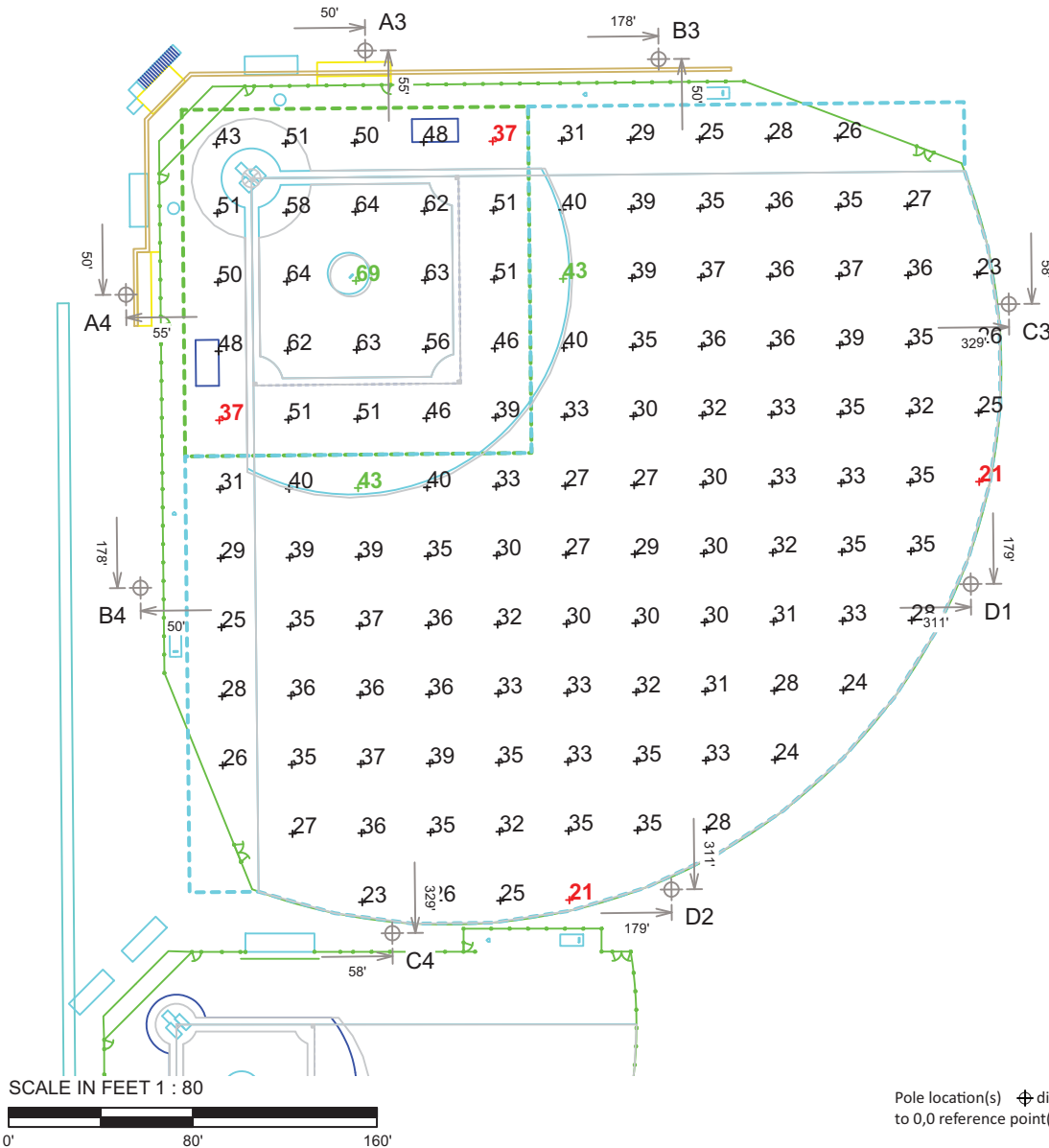



EQUIPMENT LIST FOR AREAS SHOWN

Pole				Luminaires				
QTY	LOCATION	SIZE	GRADE ELEVATION	MOUNTING HEIGHT	LAMP TYPE	QTY / POLE	THIS GRID	OTHER GRIDS
6	A1-A2 B1-B2 C1-C2	60'	-	60'	1500W MZ	3	3	0
2	A3-A4	70'	-	70'	1500W MZ	5	5	0
2	B3-B4	80'	-	80'	1500W MZ	8	8	0
4	C3-C4 D1-D2	70'	-	70'	1500W MZ	4	4	0
4	S1-S4	80'	-	80'	1500W MZ	13	13	0
4	T1-T2 T5-T6	50'	-	50'	1000W MZ	2	2	0
2	T3-T4	50'	-	50'	1000W MZ	4	4	0
TOTALS						128	128	0

MY PROJECT

Name: Peoria Central High School Complex
Location: Peoria, IL

GRID SUMMARY

Name: Spill @ North St
Size: 330' x 165'
Spacing: 15.0' x 15.0'
Height: 10.0' above grade

CONSTANT ILLUMINATION

SUMMARY	HORIZONTAL FOOTCANDLES
Entire Grid	
Scan Average:	0.2
Maximum:	1
Minimum:	0
Avg / Min:	34.03
Max / Min:	275.85
UG (adjacent pts):	1.66
CU:	0.00
No. of Points:	245
LUMINAIRE INFORMATION	
Luminaire Type:	Green Generation
Rated Lamp Life:	5,000 / 12,000 hrs
Design Lumens:	134,000 / 88,000
Avg Lamp Tilt Factor:	1.000
No. of Luminaires:	128
Avg KW:	193.09 (211.2 max)

Guaranteed Performance: The CONSTANT ILLUMINATION described above is guaranteed for the rated life of the lamp.

Field Measurements: Illumination measured in accordance with IESNA LM-5-04 and CIBSE LG4. Individual values may vary. See the Warranty document for details.

Electrical System Requirements: Refer to Amperage Draw Chart and/or the "Musco Control System Summary" for electrical sizing.

Installation Requirements: Results assume +/- 3% nominal voltage at line side of the ballast and structures located within 3 feet (1m) of design locations.

ENGINEERED DESIGN

By: Eric Svenby
File # / Date: 167924B 27-Feb-14

Not to be reproduced in whole or part without the written consent of Musco Sports Lighting, LLC. ©1981, 2014 Musco Sports Lighting, LLC.

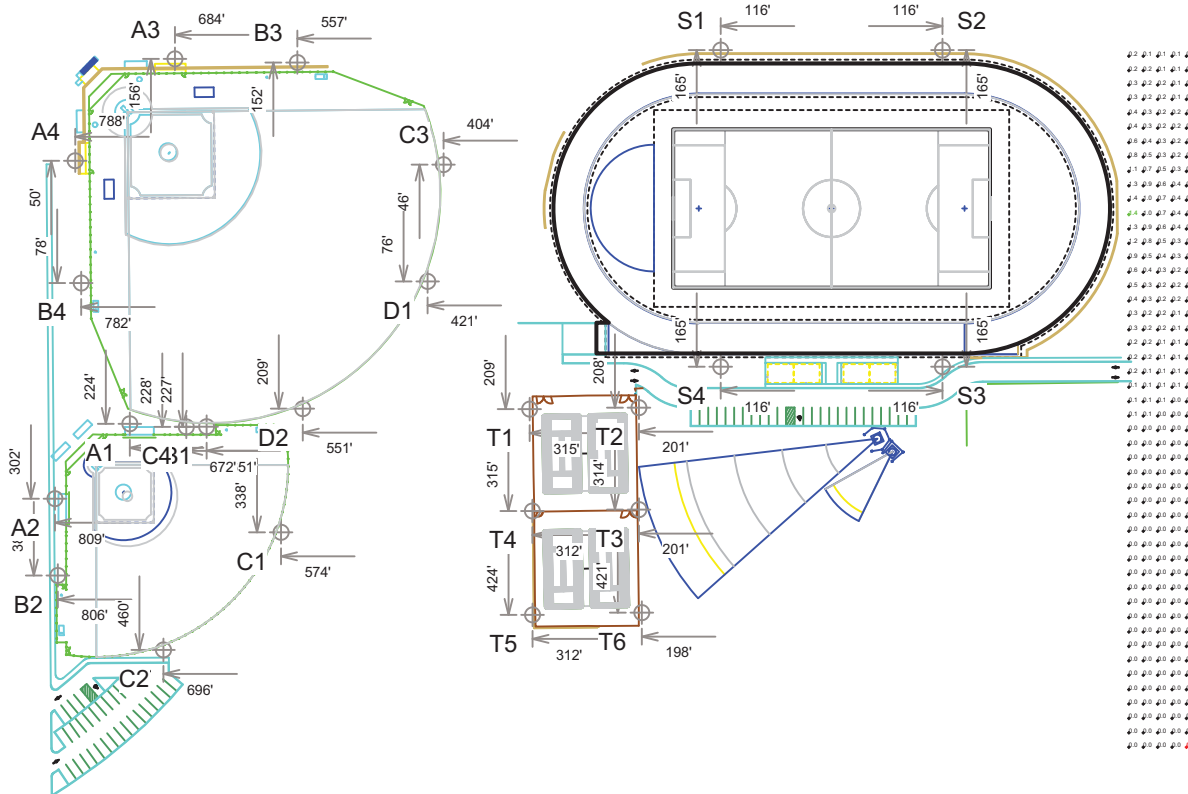

SCALE IN FEET 1 : 200



Pole location(s) ⊕ dimensions are relative to 0,0 reference point(s) ⊗



EQUIPMENT LIST FOR AREAS SHOWN								
Pole				Luminaires				
QTY	LOCATION	SIZE	GRADE ELEVATION	MOUNTING HEIGHT	LAMP TYPE	QTY / POLE	THIS GRID	OTHER GRIDS
6	A1-A2 B1-B2 C1-C2	60'	-	60'	1500W MZ	3	3	0
2	A3-A4	70'	-	70'	1500W MZ	5	5	0
2	B3-B4	80'	-	80'	1500W MZ	8	8	0
4	C3-C4 D1-D2	70'	-	70'	1500W MZ	4	4	0
4	S1-S4	80'	-	80'	1500W MZ	13	13	0
4	T1-T2 T5-T6	50'	-	50'	1000W MZ	2	2	0
2	T3-T4	50'	-	50'	1000W MZ	4	4	0
TOTALS						128	128	0

MY PROJECT	
Name:	Peoria Central High School Complex
Location:	Peoria, IL

GRID SUMMARY	
Name:	Spill @ W Nebraska Ave
Size:	330' x 165'
Spacing:	15.0' x 15.0'
Height:	10.0' above grade

CONSTANT ILLUMINATION	
SUMMARY	HORIZONTAL FOOTCANDLES
Entire Grid	
Scan Average:	1.0
Maximum:	7
Minimum:	0
Avg / Min:	39.34
Max / Min:	281.10
UG (adjacent pts):	12.40
CU:	0.01
No. of Points:	435
LUMINAIRE INFORMATION	
Luminaire Type:	Green Generation
Rated Lamp Life:	5,000 / 12,000 hrs
Design Lumens:	134,000 / 88,000
Avg Lamp Tilt Factor:	1.000
No. of Luminaires:	128
Avg KW:	193.09 (211.2 max)

Guaranteed Performance: The CONSTANT ILLUMINATION described above is guaranteed for the rated life of the lamp.

Field Measurements: Illumination measured in accordance with IESNA LM-5-04 and CIBSE LG4. Individual values may vary. See the Warranty document for details.

Electrical System Requirements: Refer to Amperage Draw Chart and/or the "Musco Control System Summary" for electrical sizing.

Installation Requirements: Results assume +/- 3% nominal voltage at line side of the ballast and structures located within 3 feet (1m) of design locations.

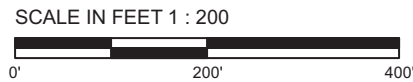
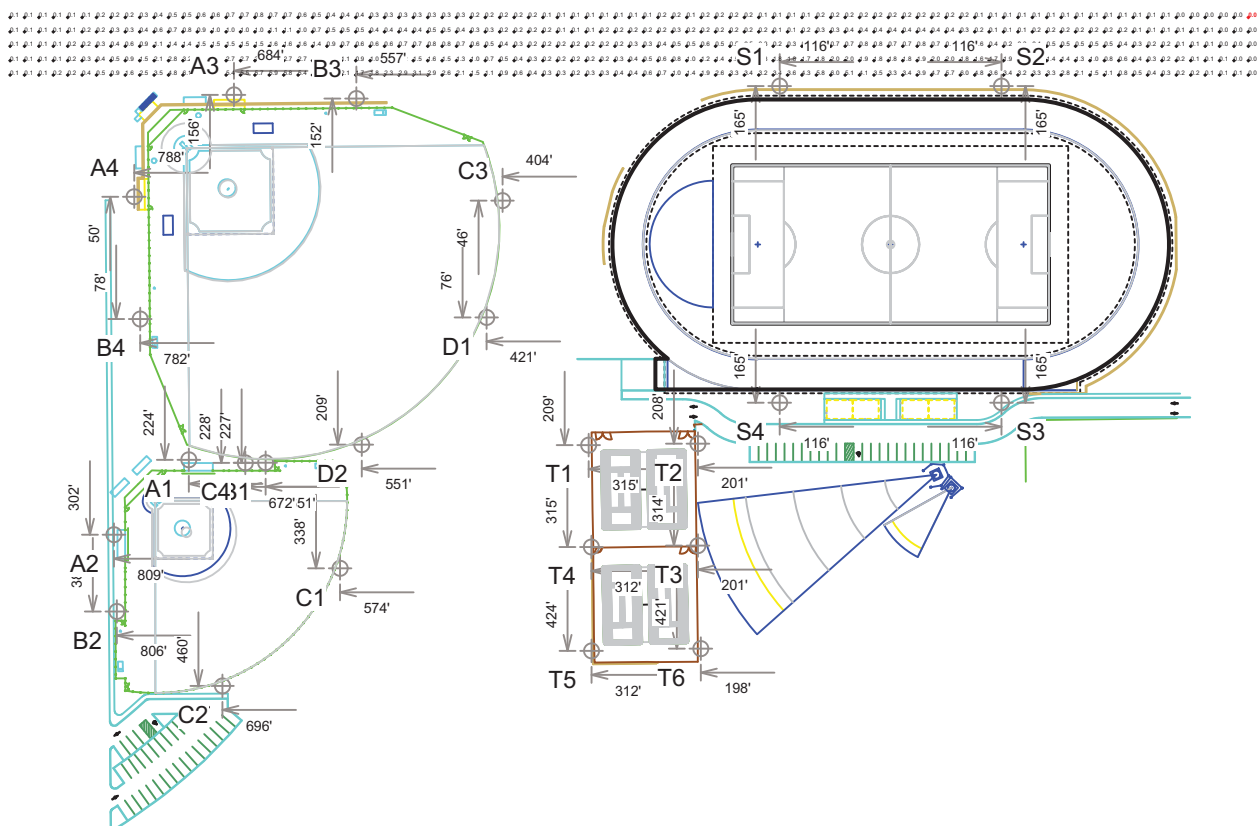

Pole location(s) ⊕ dimensions are relative to 0,0 reference point(s) ⊗

ENGINEERED DESIGN		
By:	Eric Svenby	
File # / Date:	167924B	27-Feb-14

Not to be reproduced in whole or part without the written consent of Musco Sports Lighting, LLC. ©1981, 2014 Musco Sports Lighting, LLC.



EQUIPMENT LIST FOR AREAS SHOWN

QTY	Pole			Luminaires				
	LOCATION	SIZE	GRADE ELEVATION	MOUNTING HEIGHT	LAMP TYPE	QTY / POLE	THIS GRID	OTHER GRIDS
6	A1-A2 B1-B2 C1-C2	60'	-	60'	1500W MZ	3	3	0
2	A3-A4	70'	-	70'	1500W MZ	5	5	0
2	B3-B4	80'	-	80'	1500W MZ	8	8	0
4	C3-C4 D1-D2	70'	-	70'	1500W MZ	4	4	0
4	S1-S4	80'	-	80'	1500W MZ	13	13	0
4	T1-T2 T5-T6	50'	-	50'	1000W MZ	2	2	0
2	T3-T4	50'	-	50'	1000W MZ	4	4	0
24	TOTALS					128	128	0

MY PROJECT

Name: Peoria Central High School Complex
Location: Peoria, IL

GRID SUMMARY

Name: Spill @ BB 1st Base
Size: 330' x 165'
Spacing: 15.0' x 15.0'
Height: 10.0' above grade

CONSTANT ILLUMINATION

SUMMARY	HORIZONTAL FOOTCANDLES
Entire Grid	
Scan Average:	8.4
Maximum:	31
Minimum:	1
Avg / Min:	14.08
Max / Min:	52.15
UG (adjacent pts):	2.39
CU:	0.01
No. of Points:	60
LUMINAIRE INFORMATION	
Luminaire Type:	Green Generation
Rated Lamp Life:	5,000 / 12,000 hrs
Design Lumens:	134,000 / 88,000
Avg Lamp Tilt Factor:	1.000
No. of Luminaires:	128
Avg KW:	193.09 (211.2 max)

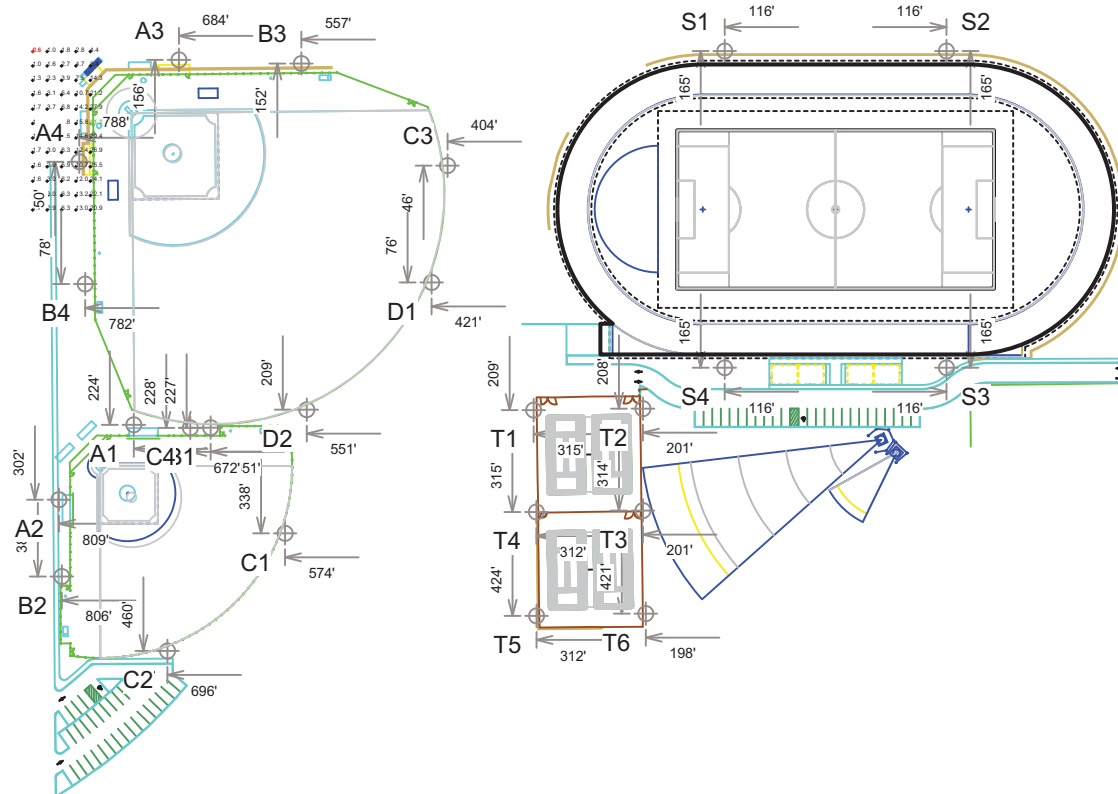

Guaranteed Performance: The CONSTANT ILLUMINATION described above is guaranteed for the rated life of the lamp.

Field Measurements: Illumination measured in accordance with IESNA LM-5-04 and CIBSE LG4. Individual values may vary. See the Warranty document for details.

Electrical System Requirements: Refer to Amperage Draw Chart and/or the "Musco Control System Summary" for electrical sizing.

Installation Requirements: Results assume +/- 3% nominal voltage at line side of the ballast and structures located within 3 feet (1m) of design locations.

ENGINEERED DESIGN

By: Eric Svenby
File # / Date: 167924B 27-Feb-14

Not to be reproduced in whole or part without the written consent of Musco Sports Lighting, LLC. ©1981, 2014 Musco Sports Lighting, LLC.



EQUIPMENT LIST FOR AREAS SHOWN

QTY	Pole			MOUNTING HEIGHT	Luminaires			
	LOCATION	SIZE	GRADE ELEVATION		LAMP TYPE	QTY / POLE	THIS GRID	OTHER GRIDS
6	A1-A2 B1-B2 C1-C2	60'	-	60'	1500W MZ	3	3	0
2	A3-A4	70'	-	70'	1500W MZ	5	5	0
2	B3-B4	80'	-	80'	1500W MZ	8	8	0
4	C3-C4 D1-D2	70'	-	70'	1500W MZ	4	4	0
4	S1-S4	80'	-	80'	1500W MZ	13	13	0
4	T1-T2 T5-T6	50'	-	50'	1000W MZ	2	2	0
2	T3-T4	50'	-	50'	1000W MZ	4	4	0
24	TOTALS					128	128	0

MY PROJECT

Name:	Peoria Central High School Complex
Location:	Peoria, IL

GRID SUMMARY

Name:	Spill @ BB Left Field
Size:	330' x 165'
Spacing:	15.0' x 15.0'
Height:	5.0' above grade

CONSTANT ILLUMINATION

SUMMARY	HORIZONTAL FOOTCANDLES
Entire Grid	
Scan Average:	5.1
Maximum:	20
Minimum:	1
Avg / Min:	6.23
Max / Min:	23.95
UG (adjacent pts):	2.51
CU:	0.00
No. of Points:	70
LUMINAIRE INFORMATION	
Luminaire Type:	Green Generation
Rated Lamp Life:	5,000 / 12,000 hrs
Design Lumens:	134,000 / 88,000
Avg Lamp Tilt Factor:	1.000
No. of Luminaires:	128
Avg KW:	193.09 (211.2 max)

Guaranteed Performance: The CONSTANT ILLUMINATION described above is guaranteed for the rated life of the lamp.

Field Measurements: Illumination measured in accordance with IESNA LM-5-04 and CIBSE LG4. Individual values may vary. See the Warranty document for details.

Electrical System Requirements: Refer to Amperage Draw Chart and/or the "Musco Control System Summary" for electrical sizing.

Installation Requirements: Results assume +/- 3% nominal voltage at line side of the ballast and structures located within 3 feet (1m) of design locations.

ENGINEERED DESIGN

By:	Eric Svenby
File # / Date:	167924B 27-Feb-14

Not to be reproduced in whole or part without the written consent of Musco Sports Lighting, LLC. ©1981, 2014 Musco Sports Lighting, LLC.

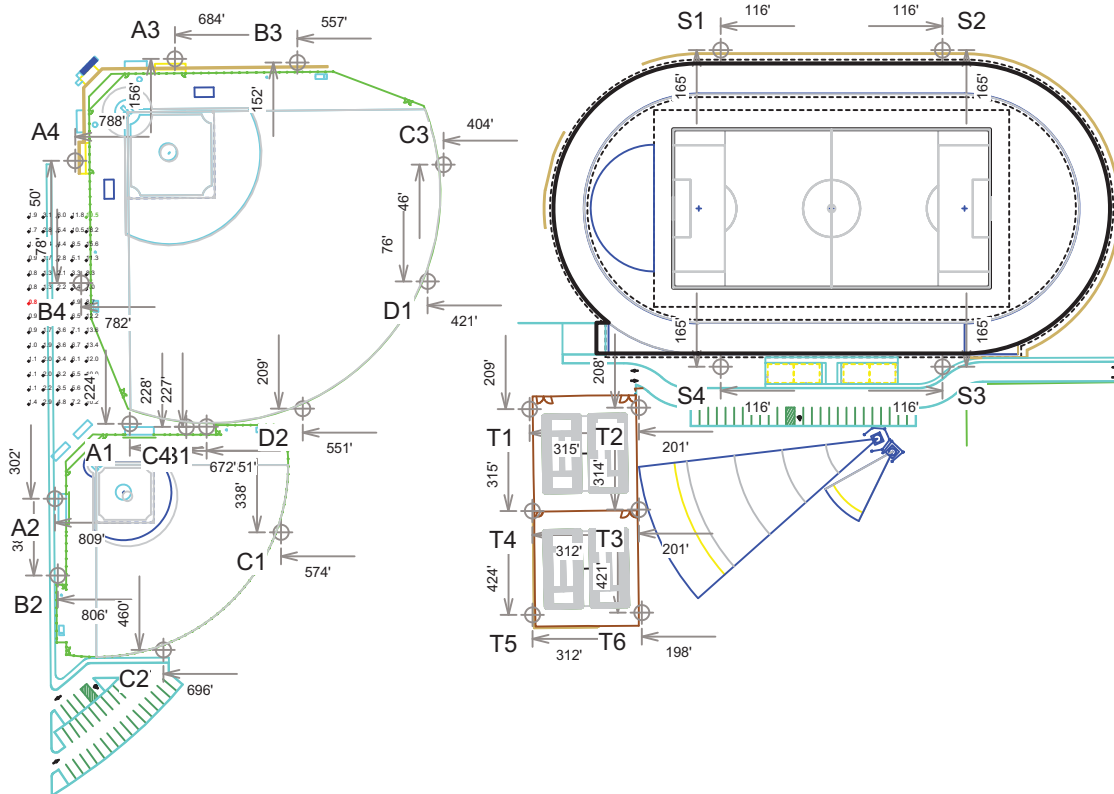

SCALE IN FEET 1 : 200



Pole location(s) ⊕ dimensions are relative to 0,0 reference point(s) ⊗



EQUIPMENT LIST FOR AREAS SHOWN								
Pole				Luminaires				
QTY	LOCATION	SIZE	GRADE ELEVATION	MOUNTING HEIGHT	LAMP TYPE	QTY / POLE	THIS GRID	OTHER GRIDS
6	A1-A2 B1-B2 C1-C2	60'	-	60'	1500W MZ	3	3	0
2	A3-A4	70'	-	70'	1500W MZ	5	5	0
2	B3-B4	80'	-	80'	1500W MZ	8	8	0
4	C3-C4 D1-D2	70'	-	70'	1500W MZ	4	4	0
4	S1-S4	80'	-	80'	1500W MZ	13	13	0
4	T1-T2 T5-T6	50'	-	50'	1000W MZ	2	2	0
2	T3-T4	50'	-	50'	1000W MZ	4	4	0
24	TOTALS					128	128	0

MY PROJECT	
Name:	Peoria Central High School Complex
Location:	Peoria, IL

GRID SUMMARY	
Name:	Spill @ SB 1st Base/Left Field
Size:	330' x 165'
Spacing:	15.0' x 15.0'
Height:	3.0' above grade

CONSTANT ILLUMINATION	
SUMMARY	HORIZONTAL FOOTCANDLES
Entire Grid	
Scan Average:	6.5
Maximum:	26
Minimum:	1
Avg / Min:	6.07
Max / Min:	23.85
UG (adjacent pts):	2.85
CU:	0.01
No. of Points:	57
LUMINAIRE INFORMATION	
Luminaire Type:	Green Generation
Rated Lamp Life:	5,000 / 12,000 hrs
Design Lumens:	134,000 / 88,000
Avg Lamp Tilt Factor:	1.000
No. of Luminaires:	128
Avg KW:	193.09 (211.2 max)

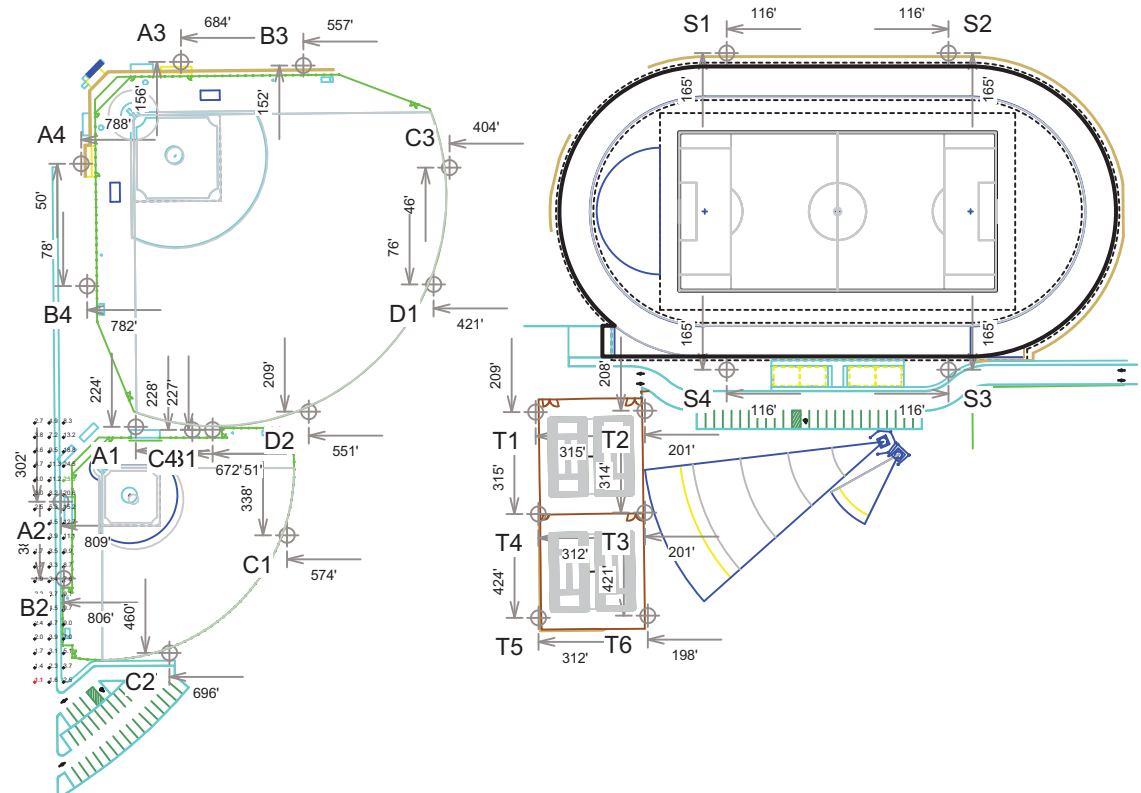

Guaranteed Performance: The CONSTANT ILLUMINATION described above is guaranteed for the rated life of the lamp.

Field Measurements: Illumination measured in accordance with IESNA LM-5-04 and CIBSE LG4. Individual values may vary. See the Warranty document for details.

Electrical System Requirements: Refer to Amperage Draw Chart and/or the "Musco Control System Summary" for electrical sizing.

Installation Requirements: Results assume +/- 3% nominal voltage at line side of the ballast and structures located within 3 feet (1m) of design locations.

ENGINEERED DESIGN		
By:	Eric Svenby	
File # / Date:	167924B	27-Feb-14

Not to be reproduced in whole or part without the written consent of Musco Sports Lighting, LLC. ©1981, 2014 Musco Sports Lighting, LLC.



MY PROJECT
 Name: Peoria Central High School Complex
 Location: Peoria, IL

EQUIPMENT LAYOUT

INCLUDES:

- Baseball
- Soccer
- Softball
- Tennis 1-2
- Tennis 3-4
- Track

Electrical System Requirements: Refer to Amperage Draw Chart and/or the "Musco Control System Summary" for electrical sizing.

Installation Requirements: Results assume +/- 3% nominal voltage at line side of the ballast and structures located within 3 feet (1m) of design locations.

EQUIPMENT LIST FOR AREAS SHOWN

QTY	LOCATION	Pole		Luminaires		QTY / POLE
		SIZE	GRADE ELEVATION	MOUNTING HEIGHT	LAMP TYPE	
6	A1-A2 B1-B2 C1-C2	60'	-	60'	1500W MZ	3
2	A3-A4	70'	-	70'	1500W MZ	5
2	B3-B4	80'	-	80'	1500W MZ	8
4	C3-C4 D1-D2	70'	-	70'	1500W MZ	4
4	S1-S4	80'	-	80'	1500W MZ	13
4	T1-T2 T5-T6	50'	-	50'	1000W MZ	2
2	T3-T4	50'	-	50'	1000W MZ	4
24	TOTALS					128

SINGLE LUMINAIRE AMPERAGE DRAW CHART

Ballast Specifications (.90 min power factor)	Line Amperage Per Luminaire (max draw)						
	208 (60)	220 (60)	240 (60)	277 (60)	347 (60)	380 (60)	480 (60)
Single Phase Voltage	208 (60)	220 (60)	240 (60)	277 (60)	347 (60)	380 (60)	480 (60)
1500 watt MZ	8.6	8.3	7.5	6.5	5.1	4.7	3.7
1000 watt MZ	6.5	6.4	5.8	4.9	4.0	3.6	2.9

ENGINEERED DESIGN
 By: Eric Svenby
 File # / Date: 167924B 27-Feb-14

Not to be reproduced in whole or part without the written consent of Musco Sports Lighting, LLC. ©1981, 2014 Musco Sports Lighting, LLC.

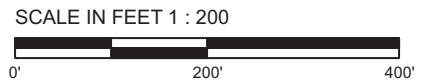
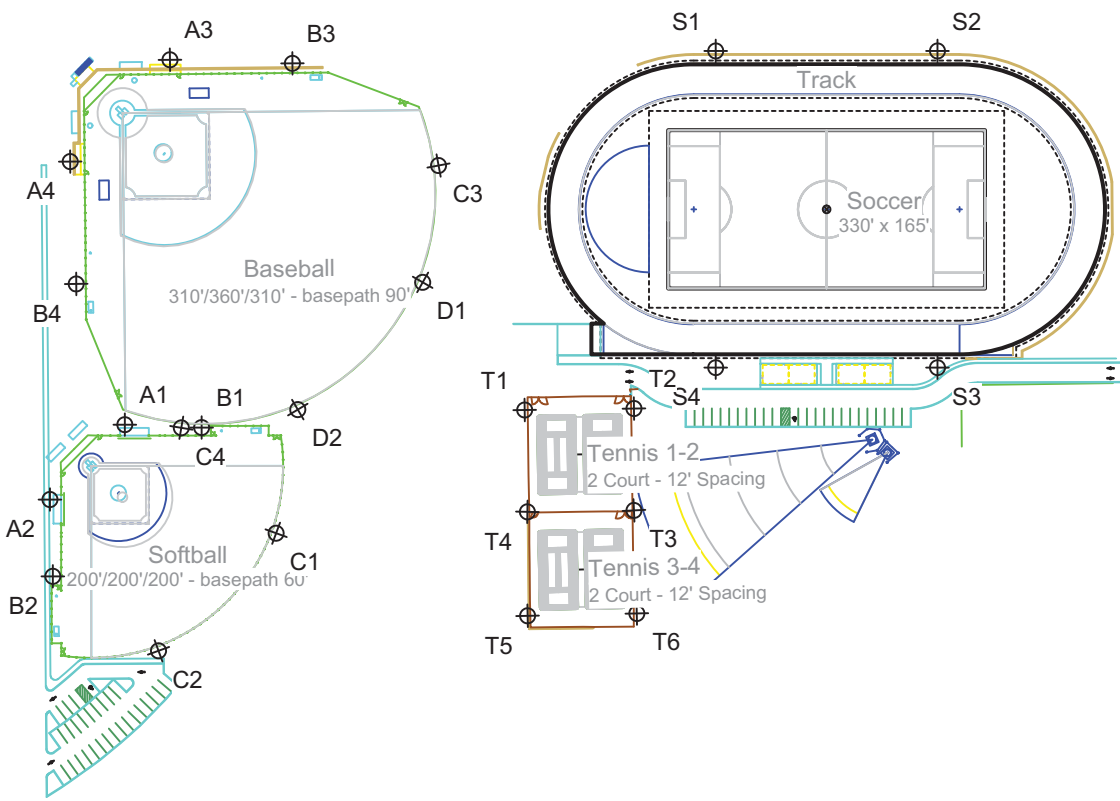

Pole location(s) ⊕ dimensions are relative to 0,0 reference point(s) ⊗