

ORDINANCE NO. 17,737

AN ORDINANCE APPROVING AMENDING AN EXISTING SPECIAL USE ORDINANCE NO. 15,862, AS AMENDED, IN A CLASS C-2 (LARGE SCALE COMMERCIAL) DISTRICT FOR A SHOPPING CENTER TO INCREASE THE SIZE OF THE FREESTANDING AND MENU BOARD SIGNS, FOR THE PROPERTIES LOCATED AT 6820 N PEAR TREE LANE, 6828 N PEAR TREE LANE, 4115 W PARTRIDGE WAY, 4123 W PARTRIDGE WAY, AND W PARTRIDGE WAY, (PARCEL IDENTIFICATION NOS. 13-12-352-003, 13-12-352-004, 13-12-352-007, 13-12-352-008, AND 13-12-352-009), PEORIA IL.

WHEREAS, the property herein described is now zoned in a Class C-2 (Large Scale Commercial) District; and

WHEREAS, said Planning & Zoning Commission has been petitioned to approve an amendment to an existing Special Use for a Shopping Center, under the provisions of Section 2.9 of Appendix A, the Unified Development Code of the City of Peoria; and

WHEREAS said Planning & Zoning Commission held a public hearing on November 7, 2019, pursuant to a notice of the time and place thereof in a newspaper of general circulation in the City of Peoria, not less than fifteen (15) days nor more than thirty (30) days prior to said hearing as required by law; and

WHEREAS, said Planning & Zoning Commission has submitted its report of said hearing and the City Council finds that to permit such special use will not adversely affect the character of the neighborhood, and will not unduly burden the public utility facilities in the neighborhood;

NOW, THEREFORE, BE IT ORDAINED BY THE CITY COUNCIL OF THE CITY OF PEORIA, ILLINOIS, AS FOLLOWS:

Section 1. That a Special Use for a Shopping Center is hereby amended for the following described property:

LEGAL DESCRIPTION OF SHOPPING CENTER PROPERTY
(SPECIAL USE PROPERTY)

LOT 1 IN HOLLOW HILL, BEING A SUBDIVISION OF A PART OF THE SOUTHEAST QUARTER OF SECTION 11, AND PART OF THE SOUTHWEST QUARTER OF SECTION 12, TOWNSHIP 9 NORTH, RANGE 7 EAST, OF THE FOURTH PRINCIPAL MERIDIAN, PEORIA COUNTY, ILLINOIS

LEGAL DESCRIPTION
(TACO BELL PARCEL)

(PER FIRST AMERICAN TITLE INSURANCE COMPANY COMMITMENT NO. 11007.185 WITH AN EFFECTIVE DATE OF MARCH 1, 2007)

PARCEL 1:

A PART OF LOT ONE OF HOLLOW HILL, A SUBDIVISION OF PART OF THE SOUTHEAST QUARTER OF SECTION ELEVEN (11), AND A PART OF THE SOUTHWEST QUARTER OF SECTION TWELVE (12), TOWNSHIP NINE (9) NORTH, RANGE SEVEN (7) EAST OF THE FOURTH PRINCIPAL MERIDIAN BEING MORE PARTICULARLY DESCRIBED AS FOLLOWS:

BEGINNING AT THE SOUTHEAST CORNER OF SAID LOT ONE, THENCE NORTH 88 DEGREES 33 MINUTES 57 SECONDS WEST, (BEARINGS ASSUMED FOR PURPOSE OF DESCRIPTION ONLY), ALONG THE SOUTH LINE OF SAID LOT ONE, 245.20 FEET; THENCE NORTH 00 DEGREES 13 MINUTES 50 SECONDS WEST, 129.00 FEET; THENCE NORTHWESTERLY, ON A CURVE TO THE LEFT, HAVING A RADIUS OF 100.00 FEET FOR AN ARC DISTANCE OF 50.51 FEET, SAID CURVE BEING SUBTENDED BY A CHORD HAVING A BEARING OF NORTH 14 DEGREES 41 MINUTES 06 SECONDS WEST AND A LENGTH OF 49.97 FEET; THENCE NORTH 75 DEGREES 57 MINUTES 30 SECONDS EAST, 135.92 FEET; THENCE SOUTH 68 DEGREES 26 MINUTES 00 SECONDS EAST, 20.24 FEET; THENCE NORTH 86 DEGREES 21 MINUTES 46 SECONDS EAST, 106.98 FEET TO THE EAST LINE OF SAID LOT 1, SAID LINE ALSO BEING THE WEST RIGHT OF WAY LINE OF BIG HOLLOW ROAD (CH 037); THENCE SOUTH 00 DEGREES 13 MINUTES 50 SECONDS EAST, ALONG SAID EAST LINE, 215.80 FEET TO THE POINT OF BEGINNING

PARCEL 2:

A NON-EXCLUSIVE EASEMENT FOR THE BENEFIT OF PARCEL 1 AS CREATED BY RECIPROCAL EASEMENT AGREEMENT DATED OCTOBER 27, 1997, AND RECORDED NOVEMBER 6, 1997, AS DOCUMENT NO. 97-34409 AND RE-RECORDED ON MARCH 19, 1998, AS DOCUMENT 98-09515 FOR THE PURPOSE OF INGRESS AND EGRESS DESCRIBED AS A 24 FOOT WIDE EASEMENT THE CENTERLINE OF WHICH IS MORE PARTICULARLY DESCRIBED AS FOLLOWS: COMMENCING AT THE AFOREMENTIONED SOUTHEAST CORNER OF LOT 1, THENCE NORTH 88 DEGREES 33 MINUTES 57 SECONDS WEST, ALONG THE SOUTH LINE OF SAID LOT 1, 245.20 FEET TO THE POINT OF BEGINNING OF THE CENTERLINE TO BE DESCRIBED; FROM THE POINT OF BEGINNING THENCE NORTH 00 DEGREES 13 MINUTES 50 SECONDS WEST, 129.00 FEET; THENCE NORTHWESTERLY, ON A CURVE TO THE LEFT, HAVING A RADIUS OF 100.00 FEET FOR AN ARC DISTANCE OF 119.04 FEET; THENCE NORTH 68 DEGREES 26 MINUTES 00 SECONDS WEST, 52.65 FEET TO THE POINT OF TERMINATION OF SAID EASEMENT; SITUATED IN THE COUNTY OF PEORIA AND STATE OF ILLINOIS

Said Ordinance is hereby approved per the submitted Site Plan (Attachment A) and Elevation Drawings (Attachment B) and the following waivers and conditions:

Waivers

1. UDC Section 8.3.10: Waiver requested to increase allowable signage from 70 to 82 square feet.
2. UDC Section 8.3.10: Waiver requested to change allowable menu boards from two 30 square foot signs to one 46.8 square foot sign.

Conditions

1. No freestanding sign will be permitted along the Partridge frontage.
2. No additional menu boards will be permitted.

Section 2. All provisions of Appendix A, the Unified Development Code of the City of Peoria, with respect to the Class C-2 (Large Scale Commercial Commercial) District shall remain applicable to the above-described premises, with exception to Special Use herein permitted.

Section 3. This Ordinance shall be in full force and effect from and after its passage and approval according to law.

PASSED BY THE CITY COUNCIL OF THE CITY OF PEORIA, ILLINOIS THIS

10TH DAY DECEMBER, 2019.

APPROVED:

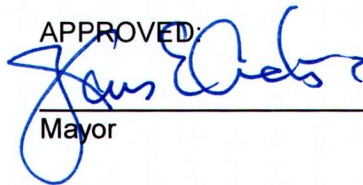

Mayor

ATTEST:



City Clerk

City Clerk

EXAMINED AND APPROVED:

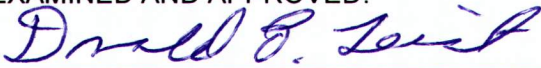

Corporation Counsel

Corporation Counsel

	PROJECT	SYSTEM VIEW	SHEET 1 OF 2
	DATE	SCALE	DESCRIPTION
INITIAL	DATE	DESCRIPTION	DATE
CHECKED	DATE	DESCRIPTION	DATE
APPROVED	DATE	DESCRIPTION	DATE

GENERAL SPECIFICATIONS
 MATERIALS - Aluminum Sheetrock 3003 H14
 6063-T6 Aluminum Extrusion
 ASTM A508
 ASTM A591
 Steel Sheet
 Steel Pipes
 Membrane Area - 469 Sq Ft
 Weight ESTD - 730 lbs (Cabinet)
 449 lbs (Incl. Cabinet)
ELECTRICAL
 Power Supply - III Class 2 Power Supply
 Load Requirement - 1 AMP @ 120VAC-60Hz
CABINETS
 Cabinet - TACO Ball Bronze Powdercoat
 External Support Structure - Satin Black Powdercoat
LEADING
 Distribution - 760 LUM
 Color - 4100K White LEDs
 Distribution - Max 15% Deviation from Mean

FRAME AND EXTERIOR SUPPORT WELDMENTS

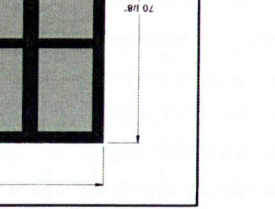
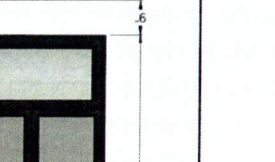
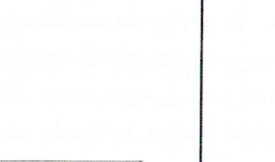
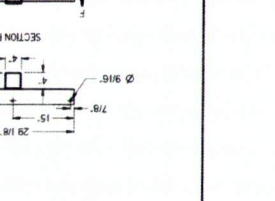
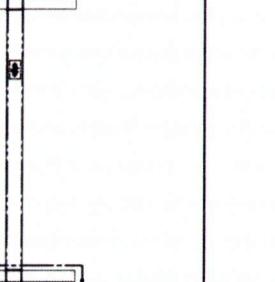
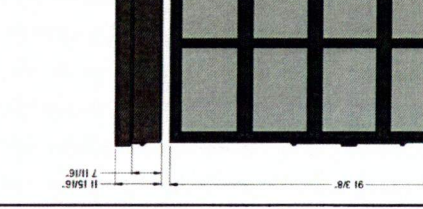
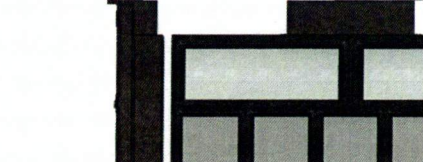
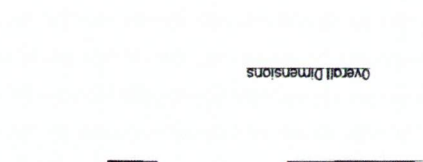
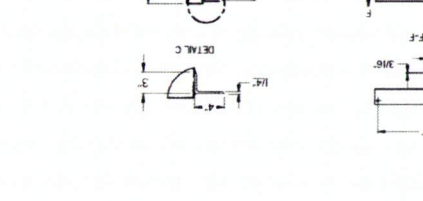
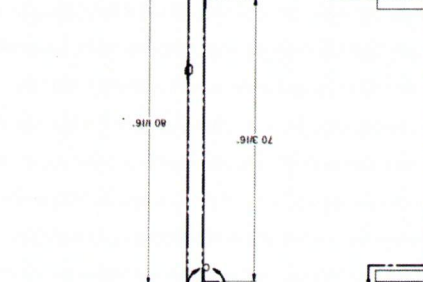
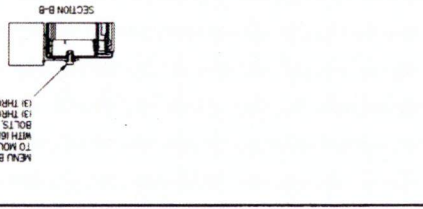
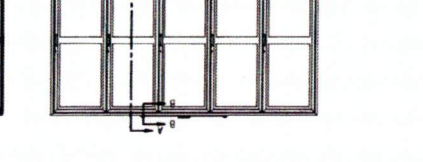
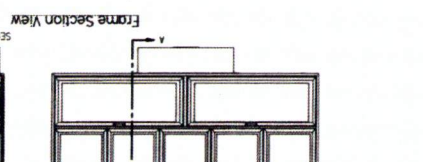
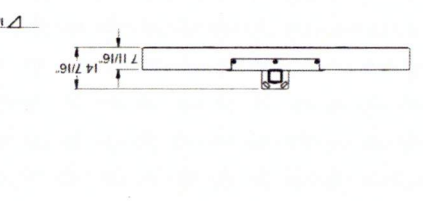
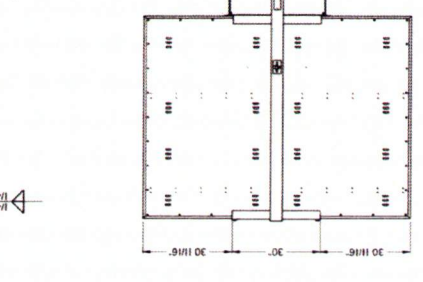
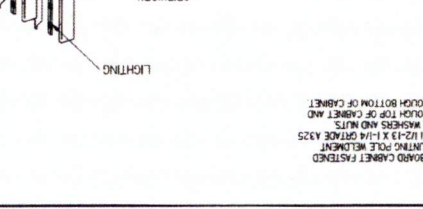
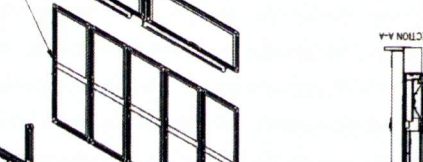
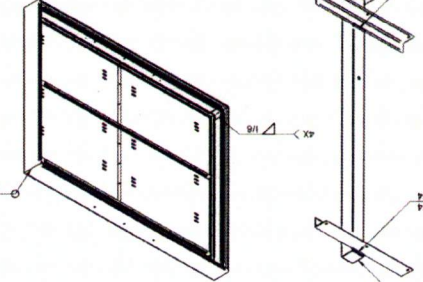
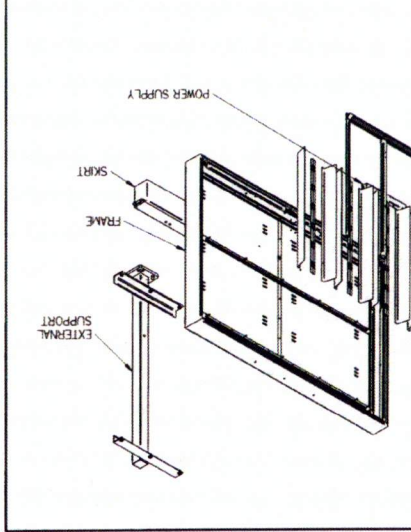

MECH BOARD CABINET FASTENED TO MOUNTING POLE WELDMENT WITH 1/2-13 X 1-1/4 GRADE 4320 BOLTS WAGERS AND NUTS (3) THROUGH TOP OF CABINET AND (3) THROUGH BOTTOM OF CABINET.

PROJECT	TRAVELER
DATE	08/21/17
DRAWN	AL
CHECKED	MS
DESIGNED BY	TRAVELER
DESCRIPTION	TRAVELER
SYSTEM VIEW	0
SCALE	1/2" = 1'-0"
WEIGHT	0.00
SHEET 2 OF 2	

Vertical Door and Graphic Holder System

Vertical Door Graphic Holder Operation

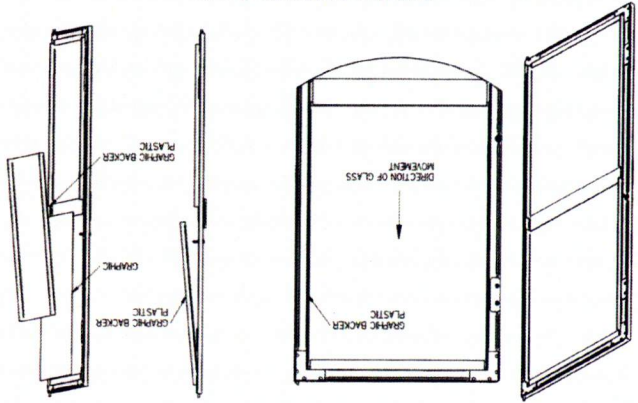

Door Section Top

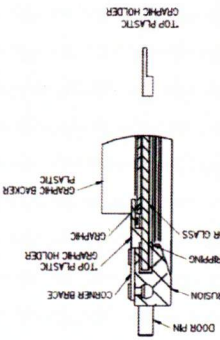

Door Section Middle

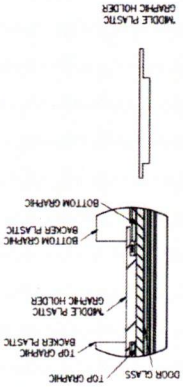

Door Section Bottom

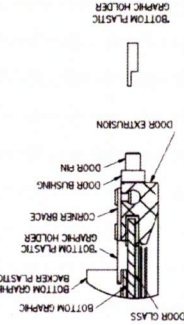

Operation of Horizontal Doors and Graphic Holders

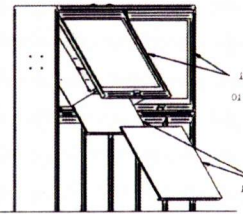

Door Locking and Magnetic Details

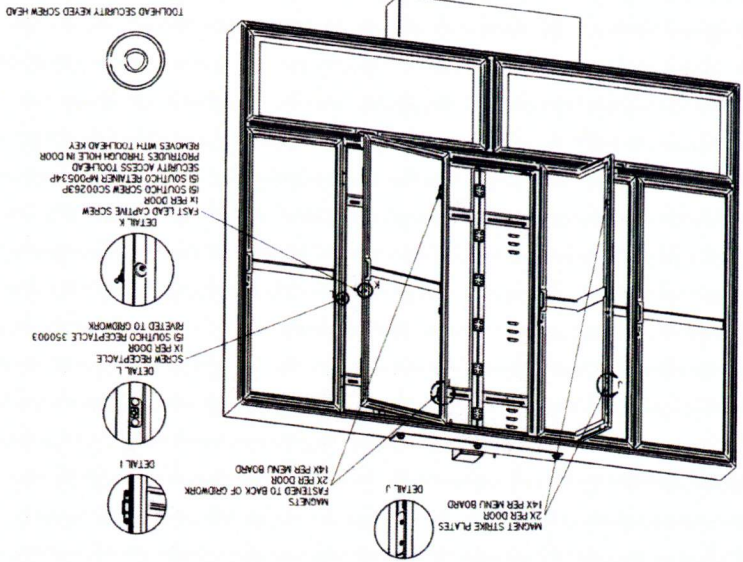

Electrical System

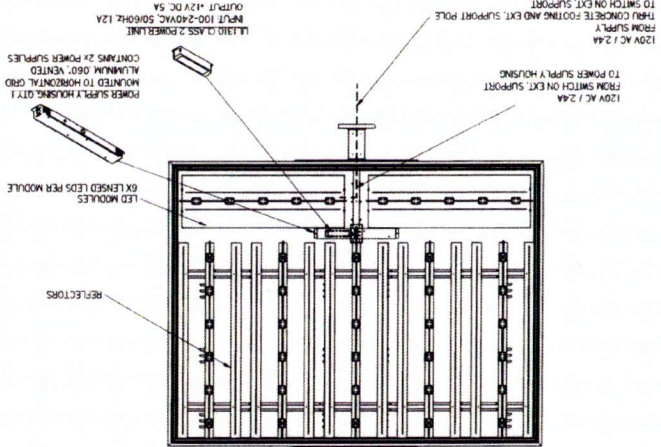

- GENERAL NOTES**
- SEE CONSTRUCTION NOTES ON OTHER SHEETS FOR OTHER CONDITIONS AFFECTING CONSTRUCTION WORK.
 - THE CONTRACTOR SHALL VERIFY THE LOCATION OF ALL UTILITIES IN THE FIELD PRIOR TO CONSTRUCTION.
 - IF THE CONTRACTOR DISCOVERS ANY UTILITIES NOT SHOWN ON THE RECORD DRAWINGS, HE SHALL NOTIFY THE ENGINEER IMMEDIATELY.
 - THE CONTRACTOR SHALL ACQUIRE ALL PERMITS THAT ARE REQUIRED BY THE LOCAL, STATE AND FEDERAL AGENCIES AND ALL CONSTRUCTION WORK SHALL BE PERFORMED IN COMPLIANCE WITH THE REQUIREMENTS OF ALL APPLICABLE LOCAL, STATE, AND FEDERAL LAWS, REGULATIONS AND RULES.
 - ALL CONSTRUCTION WORK SHALL BE IN ACCORDANCE WITH:
 - A CITY OF PEORIA REQUIREMENTS.
 - STATE OF ILLINOIS STANDARDS SPECIFICATIONS FOR ROAD AND BRIDGE CONSTRUCTION.
 - FEDERAL SPECIFICATIONS FOR BRIDGE AND SUPERSTRUCTURE CONSTRUCTION.
 - THE ILLINOIS RECORD MAPS AND CONSENTS TO RECORD REQUIREMENTS.
 - THE ILLINOIS UNIFORM BUILDING CODE.
 - THE ILLINOIS UNIFORM FIRE MARSHAL'S CODE.
 - FEDERAL SPECIFICATIONS FOR BRIDGE AND BRIDGE CONSTRUCTION.
 - CONSTRUCTION AREA IN ACCORDANCE WITH THE STORM WATER POLLUTION PREVENTION PLAN. EROSION CONTROL DETAILS AND SCHEDULES SHOWN ON SHEETS D-1 THROUGH D-4.
 - EXCAVATED AND ALL STRUCTURAL FILL AREAS AND SURFACES IN FINISHED AREAS SHALL BE COMPACTED TO PERMIT TENSILE STRENGTH AS DETERMINED BY STANDARD METHOD.
 - PAVEMENT DESIGN:
 - GRADE PRESERVE FINISH TO BE APPROVED BY THE OWNER.
 - PA VARIATION AS SHOWN.
 - PA SURFACE AS SHOWN.
 - PA SURFACE AS SHOWN.
 - PA SURFACE AS SHOWN.
 - PA SURFACE AS SHOWN.
 - PA SURFACE AS SHOWN.
 - PA SURFACE AS SHOWN.
 - PA SURFACE AS SHOWN.
 - PAVEMENT DESIGN:
 - PA VARIATION AS SHOWN.
 - PA SURFACE AS SHOWN.
 - PA SURFACE AS SHOWN.
 - PA SURFACE AS SHOWN.
 - PA SURFACE AS SHOWN.
 - PA SURFACE AS SHOWN.
 - PA SURFACE AS SHOWN.
 - PA SURFACE AS SHOWN.
 - PA SURFACE AS SHOWN.
 - CONTRACTOR SHALL VERIFY THE LOCATION OF ALL UTILITIES IN THE FIELD PRIOR TO CONSTRUCTION.
 - IF THE CONTRACTOR DISCOVERS ANY UTILITIES NOT SHOWN ON THE RECORD DRAWINGS, HE SHALL NOTIFY THE ENGINEER IMMEDIATELY.
 - THE CONTRACTOR SHALL ACQUIRE ALL PERMITS THAT ARE REQUIRED BY THE LOCAL, STATE AND FEDERAL AGENCIES AND ALL CONSTRUCTION WORK SHALL BE PERFORMED IN COMPLIANCE WITH THE REQUIREMENTS OF ALL APPLICABLE LOCAL, STATE, AND FEDERAL LAWS, REGULATIONS AND RULES.
 - ALL CONSTRUCTION WORK SHALL BE IN ACCORDANCE WITH:
 - A CITY OF PEORIA REQUIREMENTS.
 - STATE OF ILLINOIS STANDARDS SPECIFICATIONS FOR ROAD AND BRIDGE CONSTRUCTION.
 - FEDERAL SPECIFICATIONS FOR BRIDGE AND SUPERSTRUCTURE CONSTRUCTION.
 - THE ILLINOIS RECORD MAPS AND CONSENTS TO RECORD REQUIREMENTS.
 - THE ILLINOIS UNIFORM BUILDING CODE.
 - THE ILLINOIS UNIFORM FIRE MARSHAL'S CODE.
 - FEDERAL SPECIFICATIONS FOR BRIDGE AND BRIDGE CONSTRUCTION.
 - CONSTRUCTION AREA IN ACCORDANCE WITH THE STORM WATER POLLUTION PREVENTION PLAN. EROSION CONTROL DETAILS AND SCHEDULES SHOWN ON SHEETS D-1 THROUGH D-4.
 - EXCAVATED AND ALL STRUCTURAL FILL AREAS AND SURFACES IN FINISHED AREAS SHALL BE COMPACTED TO PERMIT TENSILE STRENGTH AS DETERMINED BY STANDARD METHOD.
 - PAVEMENT DESIGN:
 - GRADE PRESERVE FINISH TO BE APPROVED BY THE OWNER.
 - PA VARIATION AS SHOWN.
 - PA SURFACE AS SHOWN.
 - PA SURFACE AS SHOWN.
 - PA SURFACE AS SHOWN.
 - PA SURFACE AS SHOWN.
 - PA SURFACE AS SHOWN.
 - PA SURFACE AS SHOWN.
 - PA SURFACE AS SHOWN.
 - PAVEMENT DESIGN:
 - PA VARIATION AS SHOWN.
 - PA SURFACE AS SHOWN.
 - PA SURFACE AS SHOWN.
 - PA SURFACE AS SHOWN.
 - PA SURFACE AS SHOWN.
 - PA SURFACE AS SHOWN.
 - PA SURFACE AS SHOWN.
 - PA SURFACE AS SHOWN.
 - PA SURFACE AS SHOWN.
 - CONTRACTOR SHALL VERIFY THE LOCATION OF ALL UTILITIES IN THE FIELD PRIOR TO CONSTRUCTION.
 - IF THE CONTRACTOR DISCOVERS ANY UTILITIES NOT SHOWN ON THE RECORD DRAWINGS, HE SHALL NOTIFY THE ENGINEER IMMEDIATELY.
 - THE CONTRACTOR SHALL ACQUIRE ALL PERMITS THAT ARE REQUIRED BY THE LOCAL, STATE AND FEDERAL AGENCIES AND ALL CONSTRUCTION WORK SHALL BE PERFORMED IN COMPLIANCE WITH THE REQUIREMENTS OF ALL APPLICABLE LOCAL, STATE, AND FEDERAL LAWS, REGULATIONS AND RULES.
 - ALL CONSTRUCTION WORK SHALL BE IN ACCORDANCE WITH:
 - A CITY OF PEORIA REQUIREMENTS.
 - STATE OF ILLINOIS STANDARDS SPECIFICATIONS FOR ROAD AND BRIDGE CONSTRUCTION.
 - FEDERAL SPECIFICATIONS FOR BRIDGE AND SUPERSTRUCTURE CONSTRUCTION.
 - THE ILLINOIS RECORD MAPS AND CONSENTS TO RECORD REQUIREMENTS.
 - THE ILLINOIS UNIFORM BUILDING CODE.
 - THE ILLINOIS UNIFORM FIRE MARSHAL'S CODE.
 - FEDERAL SPECIFICATIONS FOR BRIDGE AND BRIDGE CONSTRUCTION.
 - CONSTRUCTION AREA IN ACCORDANCE WITH THE STORM WATER POLLUTION PREVENTION PLAN. EROSION CONTROL DETAILS AND SCHEDULES SHOWN ON SHEETS D-1 THROUGH D-4.
 - EXCAVATED AND ALL STRUCTURAL FILL AREAS AND SURFACES IN FINISHED AREAS SHALL BE COMPACTED TO PERMIT TENSILE STRENGTH AS DETERMINED BY STANDARD METHOD.
 - PAVEMENT DESIGN:
 - GRADE PRESERVE FINISH TO BE APPROVED BY THE OWNER.
 - PA VARIATION AS SHOWN.
 - PA SURFACE AS SHOWN.
 - PA SURFACE AS SHOWN.
 - PA SURFACE AS SHOWN.
 - PA SURFACE AS SHOWN.
 - PA SURFACE AS SHOWN.
 - PA SURFACE AS SHOWN.
 - PA SURFACE AS SHOWN.
 - PAVEMENT DESIGN:
 - PA VARIATION AS SHOWN.
 - PA SURFACE AS SHOWN.
 - PA SURFACE AS SHOWN.
 - PA SURFACE AS SHOWN.
 - PA SURFACE AS SHOWN.
 - PA SURFACE AS SHOWN.
 - PA SURFACE AS SHOWN.
 - PA SURFACE AS SHOWN.
 - PA SURFACE AS SHOWN.

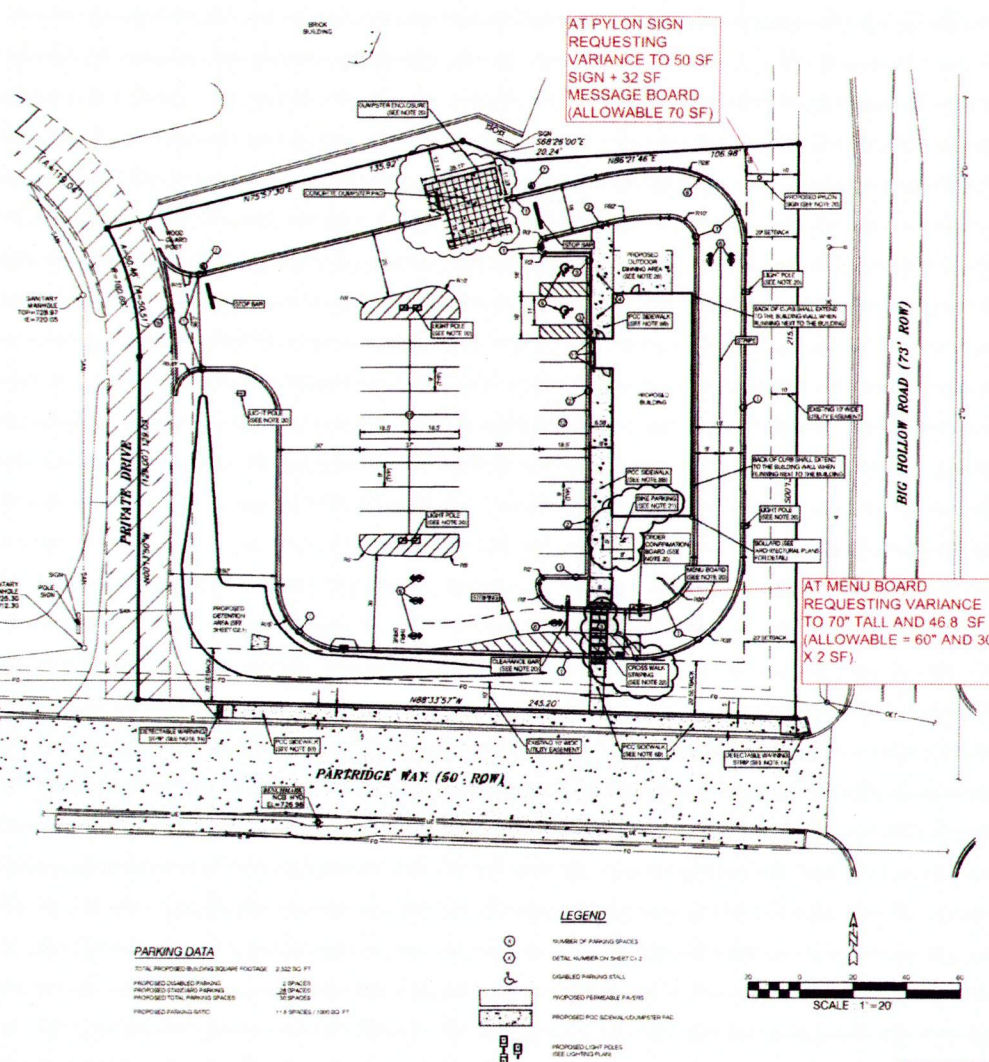

AT PYLON SIGN REQUESTING VARIANCE TO 50 SF SIGN + 32 SF MESSAGE BOARD (ALLOWABLE 70 SF)

AT MENU BOARD REQUESTING VARIANCE TO 70" TALL AND 46 8" SF (ALLOWABLE = 60" AND 30 X 2 SF)

Rationale:

Menu Board: Single menu board in lieu of two provides less total square footage of menu board.

Pole Sign: The smallest pole sign option available from corporate is being used.

PROJECT MANAGER: TWA	REVISIONS:	ZUMWALT & ASSOCIATES, INC. PROFESSIONAL ENGINEERS & REGISTERED LAND SURVEYORS 1640 N. COLVILLE DRIVE PEORIA, ILLINOIS • (309) 692-6100 DESIGN FIRM REGISTRATION NO. 084-082589	TACO BELL - BIG HOLLOW ROAD PEORIA, ILLINOIS	SITE LAYOUT PLAN AND GENERAL NOTES C1.1	
APPROVED BY: GIZ	NO. 1719 - REVISIONS PER CITY OF PEORIA REVIEW COMMENTS - CSR				
DATE: FEBRUARY 15, 2018	NO. 1818 - REVISIONS TO COMPUTER AIDED PER ARCH COMMENTS - TWA				
DWG: 18553-C1.1 LAYOUT	120718 - PARKING STALLS DELETED ON NORTH AND WEST SIDE PER OWNER'S COMMENTS - TWA				
SURVEY BY: MAT					

Copyright 2017, Jason A. Hildebrand, Inc. This document is the property of Zumwalt & Associates, Inc. All rights reserved. No part of this document may be reproduced without the express written permission of Zumwalt & Associates, Inc.

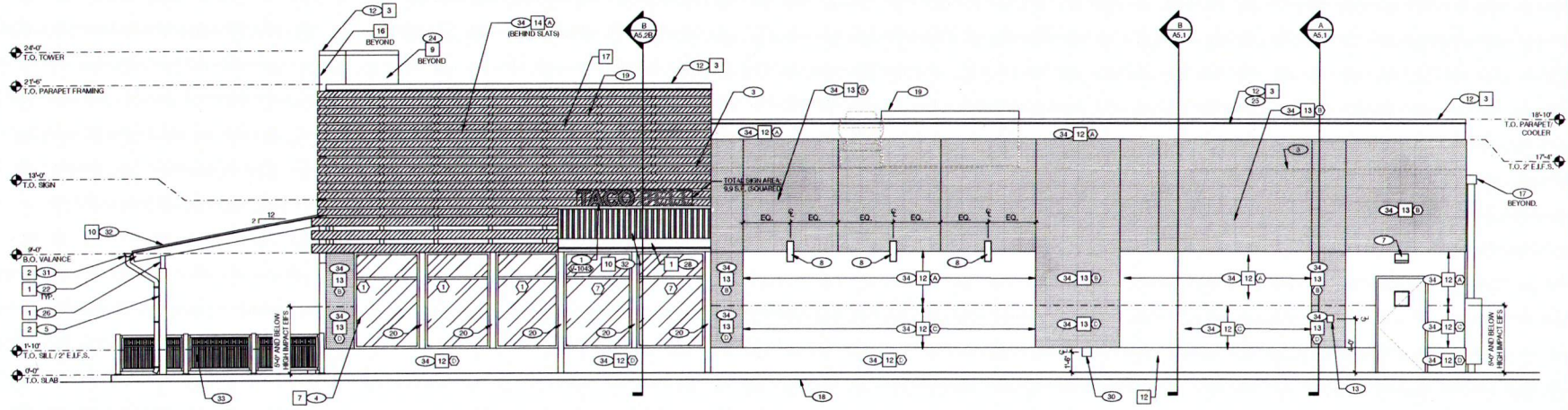

RIGHT SIDE ELEVATION 1/4" = 1'-0" **A**

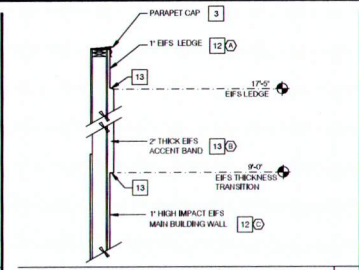
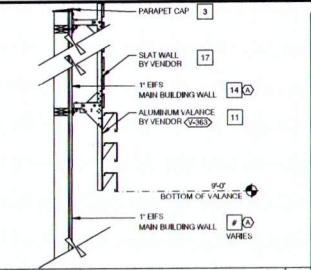

MISCELLANEOUS
 A. SEE SHT A.1.1 'WINDOW TYPES' FOR WINDOW ELEVATIONS.
SEALERS REFER TO SPEC:
 A. SEALANT AT ALL WALL AND ROOF PENETRATIONS.
 B. SEALANT AT ALL WINDOW AND DOOR FRAMES AT HEAD AND JAMB, DO NOT SEAL SILL @ WINDOWS.
 C. APPLY NEOPRENE GASKET (CONT.) BETWEEN BUILDING & CANOPY.
'CRITICAL DIMENSIONS'
 X. REQUIRED CLEAR OPENING WIDTH TO ENSURE COORDINATION WITH STANDARD SIGNAGE, BUILDING ELEMENTS DIMENSIONS.
 NOTE: NO EXTERIOR SIGNS ARE WITHIN THE SCOPE OF WORK COVERED BY THE BUILDING PERMIT APPLICATION. THE GENERAL CONTRACTOR SHALL BE RESPONSIBLE FOR COORDINATING THE INSTALLATION OF ALL EXTERIOR SIGNS AND INSTALLATION OF REQUIRED BLOCKING AND ELECTRICAL CONNECTIONS FOR FINAL APPROVED SIGNS.

PAINING OVER EIFS/STUCCO
 APPLICATOR MUST DO THEIR DUE DILIGENCE WITH PREPARATION. PRIMER: 1 COAT SW ADMISSIO. LOOKIN' CONCRETE & MASONRY PRIMER. FINISH: 2 COATS SW ADMISSIO. SERIES, A-100 EXTERIOR LATEX SATIN.

SLAT WALL COLOR TRANSITION		EIFS THICKNESS COLOR TRANSITION		GENERAL NOTES	
SYMBOL	AREA	MANUFACTURER	COLOR	ALTERNATE MFR.	ALTERNATE COLOR
1	CANOPY RAFTER BEAM PAINT	SHERWIN WILLIAMS	SW9022 'WOODSCAPES BLACK ALDER'		
2	CANOPY COLUMN PAINT	SHERWIN WILLIAMS	SW 7042 'ROCK BOTTOM'		
3	PARAPET CAP (TOWER)	DURALAST	MEDIUM BRONZE (FACTORY FINISH)	SHERWIN WILLIAMS	SW 7069 'ROCK ORE'
4	PARAPET CAP (RIGHT)	DURALAST	SHERWIN WILLIAMS SW6832 'IMPULSE PURPLE' EGGSMELL (P-4)		
5	PARAPET CAP COLOR	DURALAST	GALVALUME PLUS (FACTORY FINISH)		
6	PARAPET CAP (COOLER)	DURALAST	GALVALUME PLUS (FACTORY FINISH)		
7	STOREFRONT WINDOWS	TBD	CLEAR ANODIZED		
8	PIPE BOLLARDS	STREET SMART	YELLOW - 1/4" THICK PLASTIC COVER (US.POSTMAN.COM) OR EQUAL		
9	PARAPET BACK ROOFING	DURALAST	THE COLOR SHALL BE FACTORY COLORED 'TAN'. EQUAL ALTERNATE ALLOWED.	DUR-LAST, LEE COBB, 800-434-3876 (PHONE)	
10	AWNING PATIO ROOF, COOLER WALL	BERRIDGE	S-DECK PREWEATHERED GALVALUME		
11	VALANCE COLOR	SKIN VENDOR	SW 7834 'STATUS BRONZE' (EQUAL)		
12	MAIN BUILDING COLOR	SHERWIN WILLIAMS	SW 7067 'CITYSCAPE'	STO LOTUSAN	NA170014
13	ACCENT COLOR	SHERWIN WILLIAMS	SW 6968 'PACER WHITE'	STO LOTUSAN	NA170008
14	WALL COLOR BEHIND SCREEN WALL	SHERWIN WILLIAMS	SW 6831 'CLEMATIS'	STO LOTUSAN	NA140004
15	NOT USED				
16	METAL PANELS	WESTERN STATES METAL ROOFING	1/8" A806-4 RUSTWALL PANELS		WESTERN METAL DECK, RUSTY FALS - RUSTY@METALDECK.COM - WWW.METALDECK.COM
17	SLAT WALL	OTC	ALUMAWOOD BARN WOOD, MUSTONE HIGH IMPACT EMBOSSED WOOD GRAIN TEXTURE		

EXTERIOR FINISH SCHEDULE **H**

E.I.F.S. THICKNESS N.T.S. **B**

NOTE: SIGNAGE UNDER SEPARATE PERMIT

QTY	ITEM DESCRIPTION	ELEC
2	18 3/4" x 4-7 LOGO BELL - FACE UP	X
3	1R 14" CHANNEL LETTER - WHITE	X
1	DRIVE-THRU CANOPY - 6-6PD x 9-0PW x 6H	X

EIFS NOTES **E**

- BUILDING SIGN BY VENDOR. SEE STRUCTURAL BLOCKING ELEVATIONS, SHEET 18.0 FOR MORE INFORMATION. SEE ELECTRICAL PLANS FOR POWER REQUIREMENTS.
- DRIVE THRU WINDOW, SEE SHEET A.1.0 AND A.1.1.
- DASHED LINE INDICATES ROOF BEYOND.
- STOREFRONT, TYPICAL.
- TUBE STEEL POST, SEE STRUCTURAL DWGS.
- SWITCH GEAR, PAINT TO MATCH WALL.
- WALL PACK LIGHT FIXTURE.
- LIGHT SOURCE, ALIGN BOTTOM OF FIXTURE'S MOUNTING BRACKET WITH EIFS REVEAL / CHANGE IN EIFS THICKNESS.
- ASSUME DT LANE SURFACE IS @ BELOW THE FINISH FLOOR. REFER TO SIGNAGE & SEE PLAN.
- NOT USED.
- TOWER WITH METAL PANEL FINISH.
- PARAPET CORNING, IF DURALAST EDGE TRIM IS USED, USE THE DURALAST PRE-FINISHED EDGE TRIM. SEE DETAIL 216.0.
- CO2 FILTER VALVE & COVER, SEE DETAIL 516.2 S.M.
- DRIVE-THRU CANOPY BY OTHERS.
- GAS SERVICE.
- WALL SHALL BE FINISHED PRIOR TO INSTALLATION OF SWITCHGEAR.
- SCUPPER, COLLECTOR, AND VERTICAL DOWNSPOUT @ MIN. PAINT TO MATCH ADJACENT WALL.
- CONCRETE CURB.
- RTU BEHIND, PAINT TO MATCH MAIN BUILDING COLOR.
- BREAK METAL COVER OVER WOOD STUDS TO MATCH STOREFRONT. SEE 316.1.
- OVERFLOW SCUPPER, SEE ROOF PLAN.
- WOOD RAFTERS, SEE STRUCTURAL DWGS.
- BOLLARD.
- DURALAST SINGLE MEMBRANE ROOFING OR EQUAL.
- IF THE DURALAST PARAPET CAP TRIM IS USED IT SHALL NOT BE PAINTED.
- WOOD HEADER BEAM, SEE STRUCTURAL DWGS.
- NOT USED.
- STAIN COLOR FOR FASCIA AND SOFFIT.
- STOREFRONT DOOR, REFER TO DOOR SCHEDULE.
- HOSE REEL LOCATION, REFER TO PLUMBING AND DETAIL 8-16.2.
- GUTTER AND DOWNSPOUT, PAINT TO MATCH COLUMN.
- METAL ROOFING.
- PATIO RAILING.
- EIFS (TYP), SEE 2 & 4.16.2.

KEY NOTES **D**



www.keitheng.com
 6700 W. Parkcenter Blvd. Suite 100
 Denver, CO 80231
 Phone: 303.440.8822
 Fax: 303.440.8823
 keith@keitheng.com



TACO BELL
 4115 W. Parkcenter Way
 Denver, CO 80231

CONTRACT DATE: XXXXXX
 BUILDING TYPE: EXPLORER LITE LG
 PLAN VERSION: DECEMBER 2016
 BRAND DESIGNER: XXXXX
 SITE NUMBER: 312921
 STORE NUMBER: XXXXX



EXTERIOR ELEVATIONS

A4.0B

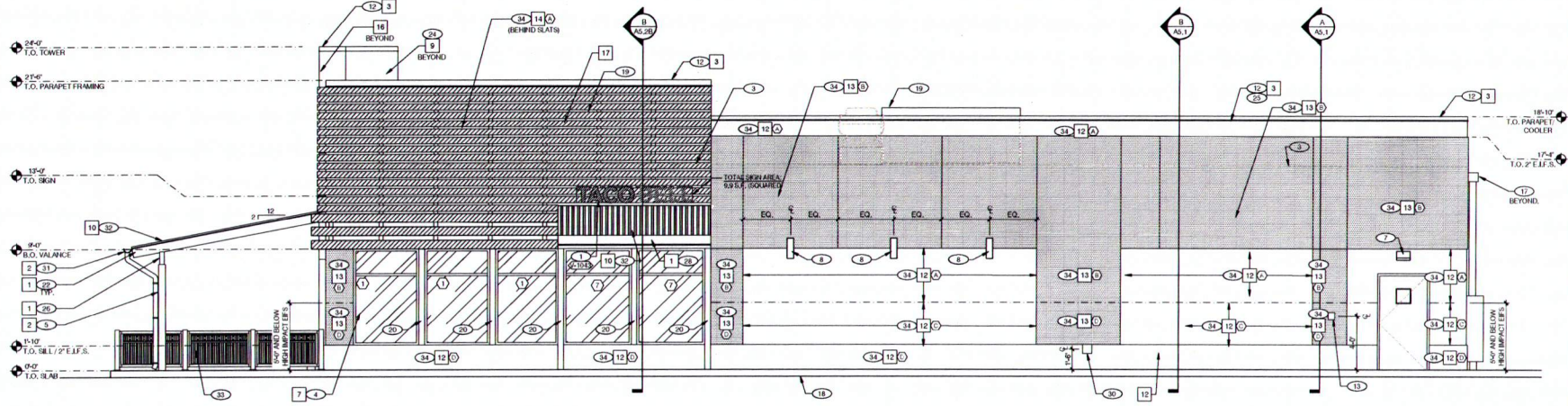

RIGHT SIDE ELEVATION 1/4" = 1'-0" A

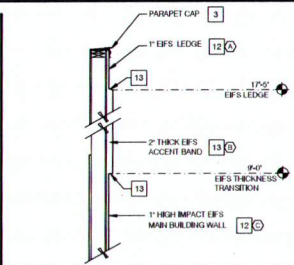
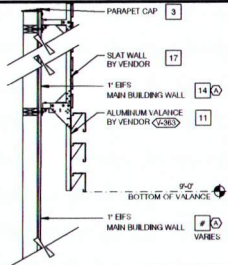

MISCELLANEOUS
 A. SEE SHT A.1. WINDOW TYPES FOR WINDOW ELEVATIONS.
SEALERS (REFER TO SPEC):
 A. SEALANT AT ALL WALL AND ROOF PENETRATIONS.
 B. SEALANT AT ALL WINDOW AND DOOR FRAMES AT HEAD AND JAMB DO NOT SEAL SILL @ WINDOWS.
 C. APPLY NEOPRENE GASKET (CONT.) BETWEEN BUILDING & CANOPY.
CERTECAL DIMENSIONS:
 A. REQUIRED CLEAR OPENING WIDTH TO ENSURE COORDINATION WITH STANDARD SIGNAGE / BUILDING ELEMENTS DIMENSIONS.
NOTE: NO EXTERIOR SIGNS ARE WITHIN THE SCOPE OF WORK COVERED BY THE BUILDING PERMIT APPLICATION. THE GENERAL CONTRACTOR SHALL BE RESPONSIBLE FOR COORDINATING THE INSTALLATION OF ALL EXTERIOR SIGNS AND INSTALLATION OF REQUIRED BLOCKING AND ELECTRICAL CONNECTIONS FOR FINAL APPROVED SIGNS.

PAINTING OVER EIFS/STUCCO:
 APPLICATOR MUST DO THEIR DUE DILIGENCE WITH PREPARATION
 PRIMER: 1 COAT SW 900 SERIES LOGIC CONCRETE & MASONRY PRIMER.
 FINISH: 2 COATS SW 600-100 SERIES; A-100 EXTERIOR LATEX SATIN.

- ⊙ BASE THICKNESS - 1" THICK EIFS.
- ⊙ BASE THICKNESS - 2" THICK EIFS.
- ⊙ BASE THICKNESS - 1" THICK EIFS WITH HIGH IMPACT MESH (ONLY WHERE NOTED; SEE DETAIL 2/A&2.)
- ⊙ BASE THICKNESS - 2" THICK EIFS WITH HIGH IMPACT MESH (ONLY WHERE NOTED; SEE DETAIL 2/A&2.)

E.I.F.S. THICKNESS N.T.S. B

NOTE: SIGNAGE UNDER SEPARATE PERMIT

QTY	ITEM DESCRIPTION	ELEC
2	1/8" x 4" x 4" LOGO BELL - FACE LIT	X
3	1/8" x 4" CHANNEL LETTER - WHITE	X
1	DRIVE-THRU CANOPY - 4'-0" x 9'-0" x 6'-0"	X

SIGN SCHEDULE N.T.S. C

SYMBOL	AREA	MANUFACTURER	COLOR	ALTERNATE MFR.	ALTERNATE COLOR	CONTACT INFORMATION
1	CANOPY RAFTER / BEAM PAINT	SHERWIN WILLIAMS	SW602 'WOODSCAPE'S BLACK ALDER'			SHERWIN WILLIAMS, BRAD HARRINGTON, 216-229-5488 (PHONE), BRAD.HARRINGTON@SHERWIN.COM (EMAIL)
2	CANOPY COLUMN PAINT	SHERWIN WILLIAMS	SW 792 ROCK BOTTOM			
3	PARAPET CAP (TOWER)	DURALAST	MEDIUM BRONZE (FACTORY FINISH)	SHERWIN WILLIAMS	SW 7069 'IRON ORE'	DURALAST, LEE COBB, 800-434-3876 (PHONE)
4	PARAPET CAP (FRONT)	DURALAST	SHERWIN WILLIAMS SW6832 'IMPULSE PURPLE' EGGSHELL (P=4)			
5	PARAPET CAP (COOLER)	DURALAST	GALVALUME PLUS (FACTORY FINISH)			
6	PARAPET CAP (COOLER)	DURALAST	GALVALUME PLUS (FACTORY FINISH)			
7	STOREFRONT WINDOWS	TBD	CLEAR ANODIZED			
8	PIPE BOLLARDS	STREET SMART	YELLOW - 1/4" THICK PLASTIC COVER (US POSTMAN.COM) OR EQUAL			
9	PARAPET BACK ROOFING	DURALAST	THE COLOR SHALL BE FACTORY COLORED 'TAN'. EQUAL ALTERNATE ALLOWED.			DURALAST, LEE COBB, 800-434-3876 (PHONE)
10	AWNING, PATIO ROOF, COOLER WALL	BERNEDGE	5-DECK PREWEATHERED GALVALUME			
11	VALANCE COLOR	SKIN VENDOR	SW 7034 'STATUS BRONZE' (EQUAL)			
12	MAIN BUILDING COLOR	SHERWIN WILLIAMS	SW 7067 'CITYSCAPE'	STO LOTUSAN	NA17-0014	SHERWIN WILLIAMS, BRAD HARRINGTON, 216-341-5568 X115 (PHONE), BRAD.HARRINGTON@SHERWIN.COM
13	ACCENT COLOR	SHERWIN WILLIAMS	SW 6968 'PACER WHITE'	STO LOTUSAN	NA17-0006	EIFS CONTACT: STO CORP., CHUCK DUFFIN, 940-894-2992 (PHONE), 940-894-2995 (FAX), CDUFFIN@STOCORP.COM
14	WALL COLOR BEHIND SCREEN WALL	SHERWIN WILLIAMS	SW 6831 'CLEMATIS'	STO LOTUSAN	NA14-0004	
15	HOT USED					
16	METAL PANELS	WESTERN STATES METAL ROOFING	1/4" A606-4 RUST WALL PANELS			WESTERN METAL DECK, RUSTY FAY - RUSTY@METALDECK.COM - WWW.METALDECK.COM
17	SLAT WALL	GIC	ALUMINUM BARN WOOD, HUSTONE HIGH IMPACT EMBOSSED WOOD GRAIN TEXTURE			

EXTERIOR FINISH SCHEDULE H

GENERAL NOTES F

EIFS NOTES E

1. BUILDING SIGN BY VENDOR. SEE STRUCTURAL BLOCKING ELEVATIONS SHEET 15.0 FOR MORE INFORMATION. SEE ELECTRICAL PLANS FOR POWER REQUIREMENTS.
2. DRIVE THRU WINDOW. SEE SHEET A1.6 AND A1.1.
3. DASHED LINE INDICATES ROOF BEYOND.
4. STOREFRONT, TYPICAL.
5. TUBE STEEL POST. SEE STRUCTURAL DWGS.
6. SWITCH GEAR PAINT TO MATCH WALL.
7. WALL PACK LIGHT FEATURE.
8. LIGHT SOURCE, ALIGN BOTTOM OF FIXTURE'S MOUNTING BRACKET WITH EIFS REVEAL / CHANGE IN EIFS THICKNESS.
9. ASSUME D/LANE SURFACE IS @ BELOW THE FINISH FLOOR. REFER TO GRADING & SITE PLAN.
10. NOT USED.
11. TOWER WITH METAL PANEL FINISH.
12. PARAPET COPING. IF DURALAST EDGE TRIM IS USED, USE THE DURALAST PRE-FINISHED EDGE TRIM. SEE DETAIL 3/A&2.
13. COP FILLER VAIL & COVER. SEE DETAIL 3/A&2 3/B.
14. DRIVE-THRU CANOPY BY OTHERS.
15. GAS SERVICE.
16. WALL SHALL BE FINISHED PRIOR TO INSTALLATION OF SWITCHGEAR.
17. SCRAPER, COLLECTOR, AND VERTICAL DOWNSPOUT @ MIN. PAINT TO MATCH ADJACENT WALL.
18. CONCRETE CURB.
19. RTU BEYOND. PAINT TO MATCH MAIN BUILDING COLOR.
20. BREAK METAL COVER OVER WOOD STUDS TO MATCH STOREFRONT. SEE 3/A&1.
21. OVERFLOW SLOOPER, SEE ROOF PLAN.
22. WOOD RAFTERS, SEE STRUCTURAL DWGS.
23. BOLLARD.
24. DURALAST SINGLE MEMBRANE ROOFING OR EQUAL.
25. IF THE DURALAST PARAPET CAP TRIM IS USED IT SHALL NOT BE PAINTED.
26. WOOD HEADER BEAM, SEE STRUCTURAL DWGS.
27. NOT USED.
28. STAIN COLOR FOR FASCIA AND SOFFIT.
29. STOREFRONT DOOR. REFER TO DOOR SCHEDULE.
30. HOSE BIBS LOCATION. REFER TO PLUMBING AND DETAIL 8/A&2.
31. GUTTER AND DOWNSPOUT. PAINT TO MATCH COLUMN.
32. METAL ROOFING.
33. PATIO RAILING.
34. EIFS (TYP). SEE 2 & 4/A&2.

KEY NOTES D

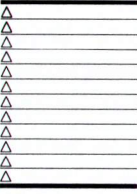

CONTRACT DATE: XXXXXX
 BUILDING TYPE: EXPLORER LITE LG
 PLAN VERSION: DECEMBER 2016
 BRAND/DESIGNER: XXXXX
 SITE NUMBER: 312921
 STORE NUMBER: XXXXX

TACO BELL
 4115 W. Partridge Way
 Peoria, IL 61615

EXPLORER LITE LARGESO

EXTERIOR ELEVATIONS
A4.0B