

PROPOSED ZONING: I1

PARCELS

18-18-254-012	2400 W MALONE AVE
18-18-254-010	2404 W MALONE AVE
18-18-254-009	2406 W MALONE AVE
18-18-258-001	2330 W MALONE AVE
18-18-254-020	2407 W STARR ST
18-18-254-021	2403 W STARR ST
18-18-254-022	2401 W STARR ST
18-18-258-001	2330 W MALONE AVE & 1106 S STANLEY AVE

GENERAL NOTES
PROPERTY LINES, BUILDING LOCATIONS AND SITE DIMENSIONS WERE BASED ON DATA DERIVED FROM THE PEORIA GIS SYSTEM. PROPERTY LINES AS SHOWN ARE APPROXIMATE.

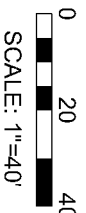
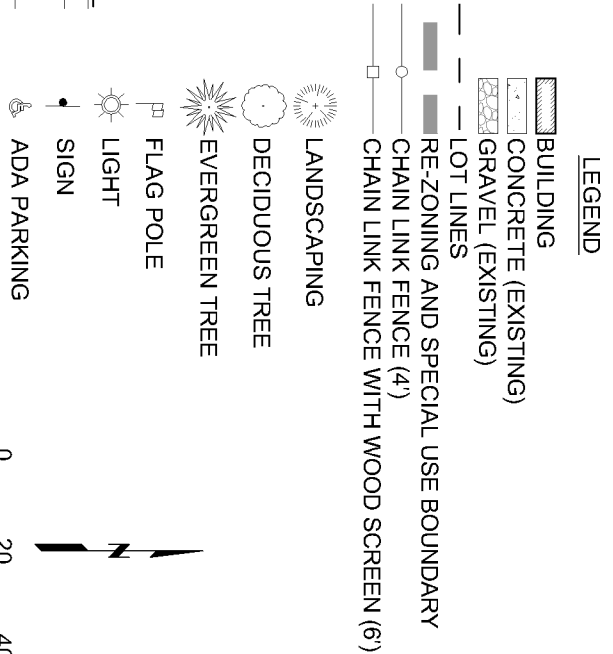

FARMINGTON ROAD TOWING
1107 S STANLEY ST, PEORIA
SITE PLAN