

# PRELIMINARY PLAT OF TAFT HOMES

THAT PART OF LOTS 6 THRU 12, BLOCK 26, LOTS 1 THRU 12, BLOCK 43, MORTON, VORIS & LAVERILLE'S FIRST ADDITION, RECORDED IN BOOK H, PAGE 455, LOCATED IN THE SOUTHWEST QUARTER OF THE SOUTHWEST QUARTER OF SECTION 03 AND PART OF LOTS 4, 5, 6 AND 16, ALL OF LOTS 7 THRU 15, RANGE 1, LOTS 5 THRU 15, AND PART OF LOT 16, RANGE 2, LOTS 1 THRU 18, RANGE 3, LOTS 1 THRU 16, RANGE 4, LOTS 1 THRU 12, RANGE 5, LOTS 1 THRU 9, RANGE 6, MILLS ADDITION, RECORDED IN BOOK L, PAGE 26, VACATED HANCOCK STREET, GREEN STREET, BOND AVENUE AND ALLEYS BETWEEN EATON STREET AND IRVING STREET PER ORDINANCE NUMBER 6238, FILED FEBRUARY 24, 1953, LOCATED IN THE NORTHWEST QUARTER OF THE NORTHWEST QUARTER OF SECTION 10, TOWNSHIP 08 NORTH, RANGE 08 EAST OF THE 4th P.M., CITY OF PEORIA, PEORIA COUNTY, ILLINOIS

## PROPOSED CONDITIONS

CURVE TABLE							
CURVE	ARC LENGTH	RADIUS	DELTA	CHORD BEARING	CHORD	TANGENT IN	TANGENT OUT
C-1	52.52'	62.00'	48°31'57"	N25°45'04"E	50.96'	N01°29'06"E	N50°01'03"E
C-2	44.57'	62.00'	41°11'20"	N70°36'43"E	43.62'	N50°01'03"E	S88°47'38"E

### LEGEND

- GOVERNMENT CORNER
- 1" IRON PIPE FOUND
- 3/4" REBAR FOUND
- CHISELED 'X' FOUND
- PK/MAG NAIL FOUND
- 3/4" x 24" REBAR SET (1.50 LBS/LF)
- BENCHMARK
- FLAG POLE
- SIGN
- SANITARY MANHOLE
- CLEAN OUT
- HYDRANT
- WATER VALVE
- SPRINKLER VALVE BOX
- STORM MANHOLE
- ROUND CASTED INLET
- SQUARE CASTED INLET
- CURB INLET
- GAS REGULATOR/METER
- GAS VALVE
- MANHOLE - UNVERIFIED TYPE
- ELECTRIC METER
- LIGHT POLE
- POWER POLE W/GUY
- TRAFFIC SIGNAL
- PULL BOX
- TELEPHONE MANHOLE
- TELEPHONE PESTAL
- DECIDUOUS TREE
- HANDICAP PARKING
- PARCEL BOUNDARY
- RIGHT-OF-WAY LINE
- CENTERLINE
- PLATTED LOT LINE
- EASEMENT LINE
- FENCE LINE
- CONCRETE CURB & GUTTER
- FENCE POST COLUMN
- SANITARY SEWER
- WATER LINE
- STORM SEWER
- NATURAL GAS
- OVERHEAD LINE
- UNDERGROUND ELECTRIC
- UNDERGROUND TELEPHONE
- BUILDING
- INDEX CONTOUR
- INTERMEDIATE CONTOUR
- RETAINING WALL
- CONCRETE PAVEMENT
- PAVEMENT STRIPING
- END OF FLAGGED UTILITIES
- DENOTES RECORD DATA DEPICTING THE SAME LINE ON THE GROUND AS RETRACED BY THIS SURVEY

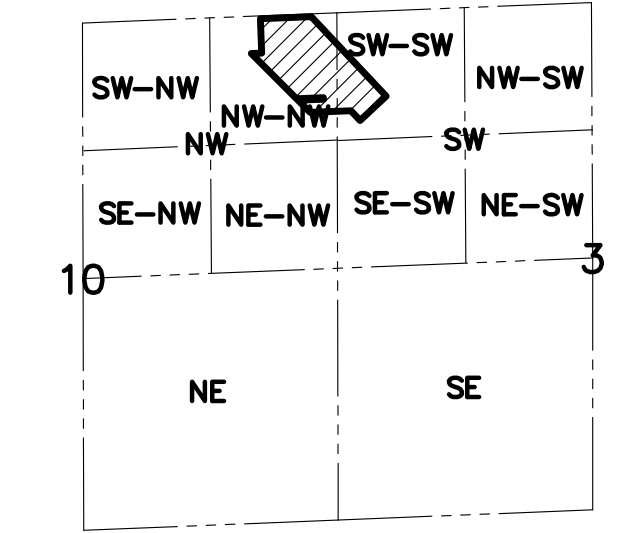

LOCATION SKETCH  
SECTION 10, T08N, R08E,  
PEORIA COUNTY, ILLINOIS

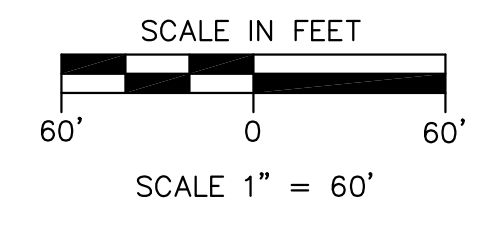
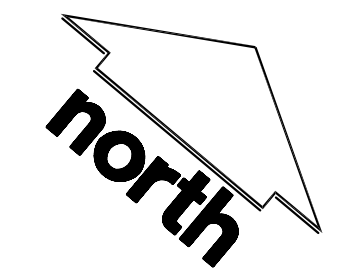

**OWNER:**  
PEORIA HOUSING AUTHORITY  
419 FULTON STREET  
PEORIA, IL 62602

**ENGINEER:**  
MANHARD CONSULTING  
116 WEST ILLINOIS STREET, FLOOR 7  
CHICAGO, IL 60654  
LICENSE No. 184-003350-0010  
(312) 824-3809

**SURVEYED FOR:**  
BEAR REAL ESTATE GROUP  
4011 80th STREET, SUITE A  
KENOSHA, WI 53142  
(262) 694-2327

**SURVEYED BY:**  
JSD PROFESSIONAL SERVICES, INC.  
160 HORIZON DRIVE, SUITE 101  
VERONA, WI 53593  
ILLINOIS DESIGN FIRM #184-005339  
(608) 848-5060

PROJECT LOCATION:  
SECTION 03 & 10  
TOWNSHIP 08 NORTH  
RANGE 08 EAST  
CITY OF PEORIA  
PEORIA COUNTY, ILLINOIS

CREATE THE VISION TELL THE STORY  
MADISON BELMONT  
KENOSHA APPLETON WAUSAU

**TAFT HOUSING**

PROJECT NO: 20-9951	DRAWN BY: JJK	INITIAL SUBMITTAL DATE: MARCH 15, 2021
FIELDBOOK/PG: -	CHECKED BY: TJB	REVISION RESUBMITTAL DATE: - APRIL 26, 2021
SURVEYED BY: DT	APPROVED BY: TJB	REVISION RESUBMITTAL DATE: -
		REVISION RESUBMITTAL DATE: -

LINE TABLE			RECORD LINE TABLE		
LINE	BEARING	DISTANCE	LINE	BEARING	DISTANCE
L-1	S89°00'04"E	2.33'	L-1	S89°57'48"E	2.33'
L-2	N04°26'11"E	100.18'	L-2	N03°24'03"E	100.18'
L-3	N00°59'56"E	72.73'	L-3	N00°02'12"E	72.73'
L-4	N13°17'49"E	44.30'	L-4	N12°15'41"E	44.30'
L-5	N37°52'51"E	44.30'	L-5	N36°50'43"E	44.30'
L-6	N50°11'01"E	100.00'	L-6	N49°08'53"E	100.00'
L-7	N45°17'00"E	150.54'	L-7	N44°34'25"E	150.47'
L-8	N39°58'57"W	0.70'	L-8	N30°51'07"W	0.70'

File: I:\2020\209951\Drawings\Survey\Sheets\209951\_P\Prop\Prop\_Legend\_Sheet\_4 User: J.K. Modified: Jun 02, 2021 8:35am