

## AXIS T98A-VE Surveillance Cabinet Series

A robust cabinet for easy installation of critical system equipment.



- > Outdoor-ready
- > IP66- and NEMA 4X-rated
- > IK10-rated
- > Ease of installation
- > Compatible with Axis network video cameras

AXIS T98A-VE Surveillance Cabinet Series is a unique, outdoor-ready cabinet, specially designed for Axis outdoor network cameras. AXIS T98A-VE Surveillance Cabinet Series protects mains power and low-voltage units from tough weather and vandalism.

AXIS T98A-VE Series is a system solution that saves time and money in the field. AXIS T98A-VE Surveillance Cabinet Series is designed for electrical safety and to enable installation in steps, with a compartment that fits many accessories such as midspan, power supply and media converter switches used for a network camera installation.

AXIS T98A-VE Surveillance Cabinet Series comes with a mounting plate to simplify installation and cable protection attachment. An optional electrical safety kit is available, which includes surge protection, a fuse and a

door switch to detect intrusion or vandalism of the cabinet.

AXIS T98A-VE Series comes in four versions for flexibility, dependent on whether fixed, fixed dome, or PTZ dome cameras are used, or if the cabinet is used as stand-alone unit. The camera can be mounted on the door of the cabinet for a sleek design and easy installation. AXIS T98A-VE cabinet is ideal in city surveillance or critical infrastructure installations where a sturdy, vandal resistant and water-protected box is a must.



## Versatile, outdoor-ready cabinets for easy and sleek installation

AXIS T98A-VE Series combines and protects mains-powered and low-voltage components in an easy-to-install, sleek design that blends together with outdoor-ready PTZ, fixed and fixed dome IP cameras.

### Ease-of-installation

AXIS T98A-VE offers several ease of installation features to simplify the work for the installers. With a selection of optional mounting brackets, AXIS T98A-VE can be installed on wall, pole or building corner. The polycarbonate cabinet base is extremely lightweight and can easily be carried in one hand. For maximum installation flexibility the cabinet door can

be left or right hinged. To facilitate cable routing the cabinet is fitted with a specially designed mounting plate allowing the cabinet base to temporarily be mounted in a higher position and the hinges have a stop that locks the cabinet door at 105°. The cabinet is also designed with pre-mounted DIN rails to make it easy to connect components.



Left: Lightweight polycarbonate surveillance cabinet  
Middle: Hinge stop at 105°  
Right: Pre-mounted and molded DIN rails



### Vandal-resistant to withstand adversities

The polycarbonate cabinet is IP66-rated for protection against the ingress of dust and high pressure water jets from any direction. The NEMA 4X rating protects against windblown dust, salt spray, rain, hose-directed water, and damage from external ice formation. It provides also IK10-rated material for protection against impact and vandalism. The surveillance cabinets support vibration rating 4M4 and 4M3 (AXIS T98A18-VE/T98A19-VE).

### Separated compartments to enhance security

For better installation and improve cost efficiency, the inner compartment with a DIN rail can be split into two sections: one to fit mains power units and a second for low-voltage units that do not require installation by a certified electrician. An optional electrical safety kit is available, which includes surge protection, a fuse and an alarm-door switch to detect cabinet intrusion or damage.

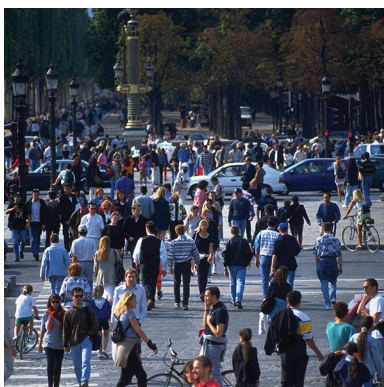

# Dimensions

- 1. Cabinet outer dimensions
- 2. Cabinet inner dimensions
- 3. AXIS T98A-VE Mounting Plate

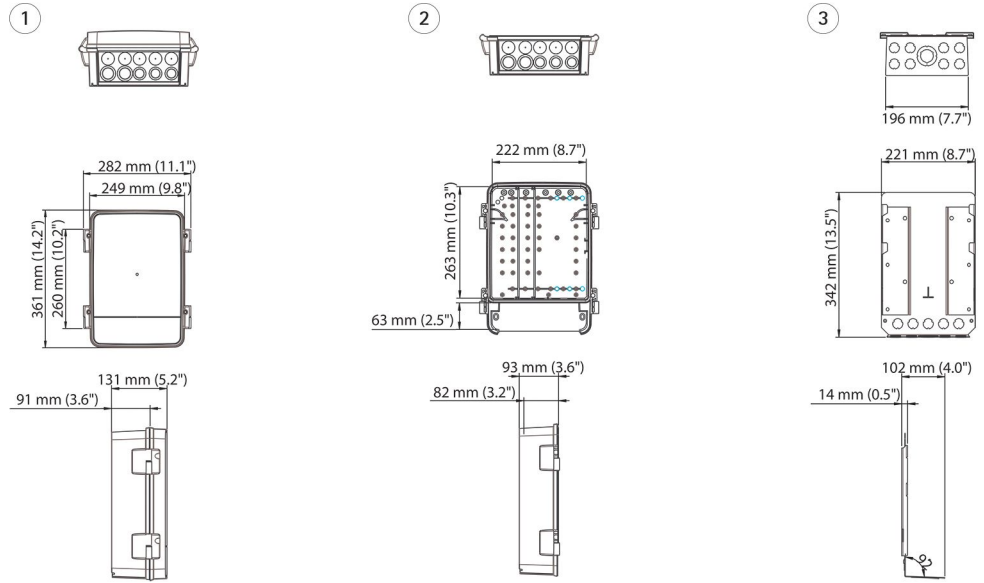

# Optional accessories

- 1. AXIS T98A Sunshield
- 2. AXIS Electrical Safety kits
- 3. AXIS Door Switch A
- 4. AXIS T95A67
- 5. AXIS T95A64

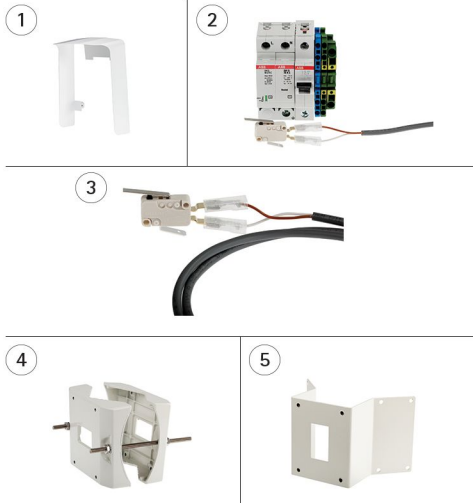

# Camera accessories

- 1. AXIS T8604  
AXIS T8605
- 2. AXIS T8006 PS12
- 3. AXIS T8008 PS12
- 4. AXIS T81B22

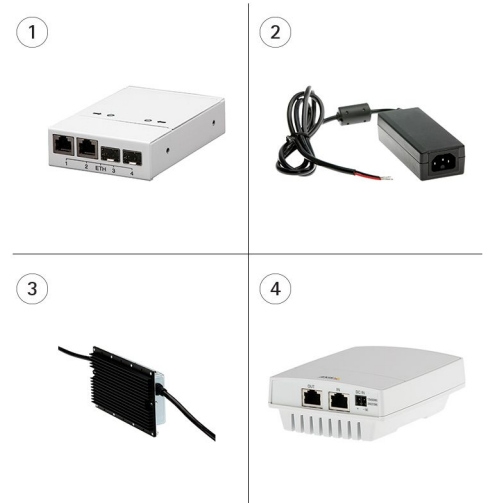

## Technical Specifications - AXIS T98A-VE Surveillance Cabinet Series

<b>Models</b>	AXIS T98A15-VE Surveillance Cabinet AXIS T98A16-VE Surveillance Cabinet AXIS T98A17-VE Surveillance Cabinet AXIS T98A18-VE Surveillance Cabinet AXIS T98A19-VE Surveillance Cabinet	<b>Operating conditions</b>	-40 °C to 75 °C (-40 °F to 167 °F) <sup>a</sup> Humidity 10–100% RH (non-condensing)
<b>General</b>		<b>Approvals</b>	IEC/EN/UL 60950-1, IEC/EN/UL 60950-22, UL 50, UL 50E, IEC 60529 IP66, NEMA 250 Type 4X, IEC 60068-2-6, IEC 60068-2-27, IEC/EN 62262 IK10, Vibration 4M4 AXIS T98A18-VE/T98A19-VE: Vibration 4M3
<b>Supported cameras</b>	AXIS T98A15-VE: Standalone AXIS T98A16-VE: AXIS Q19-E, AXIS Q17-E, AXIS Q16-E, AXIS P13-E, AXIS M11-E, AXIS T92E/T93E05 Housings AXIS T98A17-VE: AXIS P33-VE Network Cameras AXIS T98A18-VE: AXIS T91A61 Wall bracket, supporting AXIS Q60, AXIS P55 and AXIS P33/M32 Series with pendant kit AXIS T98A19-VE: AXIS P54-E Series	<b>Weight</b>	3.5 kg (7.7 lb)
<b>Casing</b>	Polycarbonate cabinet and stainless steel mounting plate IP66- and NEMA 4X-rated, IK10 impact-resistant Color: White NCS S 1002-B and stainless steel	<b>Included accessories</b>	Installation Guide, Pre-mounted cable gaskets, Pre-mounted DIN rail, Cable clamps, Cable straps, Power cover, Device mounting bracket AXIS T98A16-VE/T98A17-VE/T98A18-VE/T98A19-VE: Additional screws for mounting the camera
<b>Environment</b>	Indoor/Outdoor	<b>Warranty</b>	Axis 3-year warranty, <a href="http://www.axis.com/warranty">www.axis.com/warranty</a>

a. Temperature range may vary with the network camera and its accessories. Please visit [www.axis.com/products/cam\\_housing/t98ae/combinations.htm](http://www.axis.com/products/cam_housing/t98ae/combinations.htm) for specific details.

## Technical Specifications - AXIS Electrical Safety kits

<b>Models</b>	AXIS Electrical safety kit A 120 V AC AXIS Electrical safety kit B 230 V AC	<b>Dimensions</b>	MCB fuse: 92 x 17.5 x 72 mm (3.6 x 0.7 x 2.9 in) Surge protector: 85 x 35 x 65 mm (3.3 x 1.4 x 2.6 in) Terminal block 4X2.5MM2 (L): 80 x 6 x 37 mm (3.1 x 0.2 x 1.5 in) Terminal block 4X2.5MM2 (GND): 80 x 6 x 37 mm (3.1 x 0.2 x 1.5 in) Terminal block 2X6MM2 (GND): 67 x 8 x 37 mm (2.6 x 0.3 x 1.5 in) Door switch: 41 x 10 x 30 mm (1.6 x 0.4 x 1.2 in) Door switch cable: 1000 mm (40 in) Screw: 30 mm (1.2 in)
<b>General</b>		<b>Included accessories</b>	MCB fuse, Surge protector class 2, Terminal block 4X2.5MM2 (L), Terminal block 4X2.5MM2 (GND), Terminal block 2X6MM2 (GND), Door switch, Door switch cable, Screw
<b>Operating conditions</b>	MCB fuse: -40 °C to 75 °C (-40 °F to 167 °F) Surge protector: -40 °C to 80 °C (-40 °F to 176 °F) Terminal block 4X2.5MM2 (L), Terminal block 4X2.5MM2 (GND), Terminal block 2X6MM2 (GND) Door switch: -40 °C to 85 °C (-40 °F to 185 °F)		
<b>Approvals</b>	MCB fuse: IEC/EN 60947-2, UL 489, CSA 22.2 No. 5 Surge protector: IEC 61643-1 Ed2, UL 1449 Ed3 Door switch: EN 61058, UL 1054		
<b>Weight</b>	390 g (0.9 lb) Door switch: 10 g (0.02 lb)		

More information is available at [www.axis.com](http://www.axis.com)



AXIS T98A15-VE  
Surveillance Cabinet



AXIS T98A16-VE  
Surveillance Cabinet



AXIS T98A17-VE  
Surveillance Cabinet

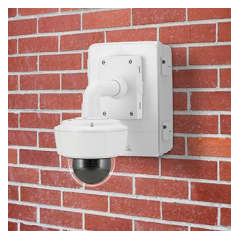

AXIS T98A18-VE  
Surveillance Cabinet



AXIS T98A19-VE  
Surveillance Cabinet



More information is available at:  
[www.axis.com/products/cam\\_housing/t98ae/](http://www.axis.com/products/cam_housing/t98ae/)