



# PEORIA RIVERFRONT

JULY 25, 2023





# PEORIA RIVERFRONT

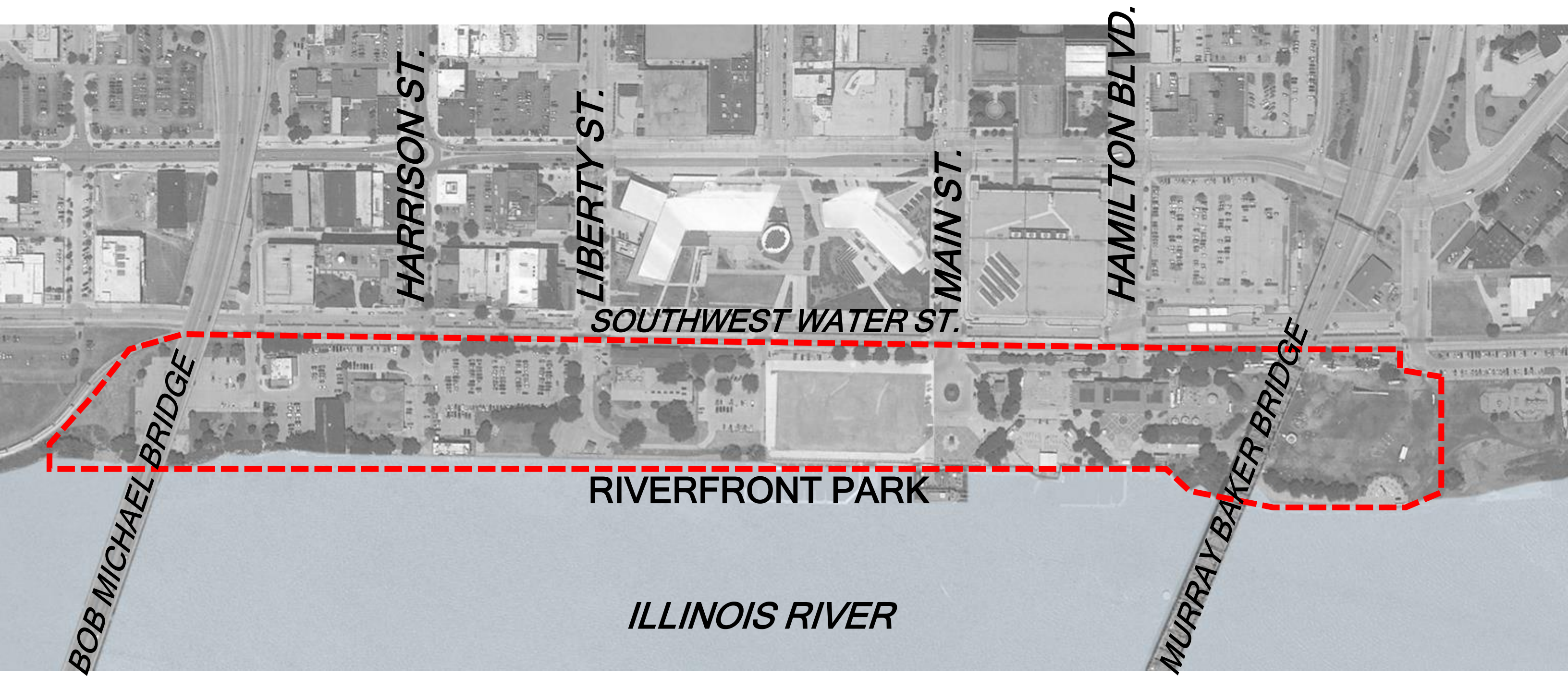



# RIVERFRONT VILLAGE STRUCTURE



Riverfront Village Structure



Demolition



Demolition



***SOUTHWEST WATER ST.***

***RIVER  
STATION***

***ILLINOIS RIVER***

Parking lot

Stage with  
Overhead  
Structure

Playground

2018 preliminary plans after demolition



# PUBLIC ENGAGEMENT TIMELINE

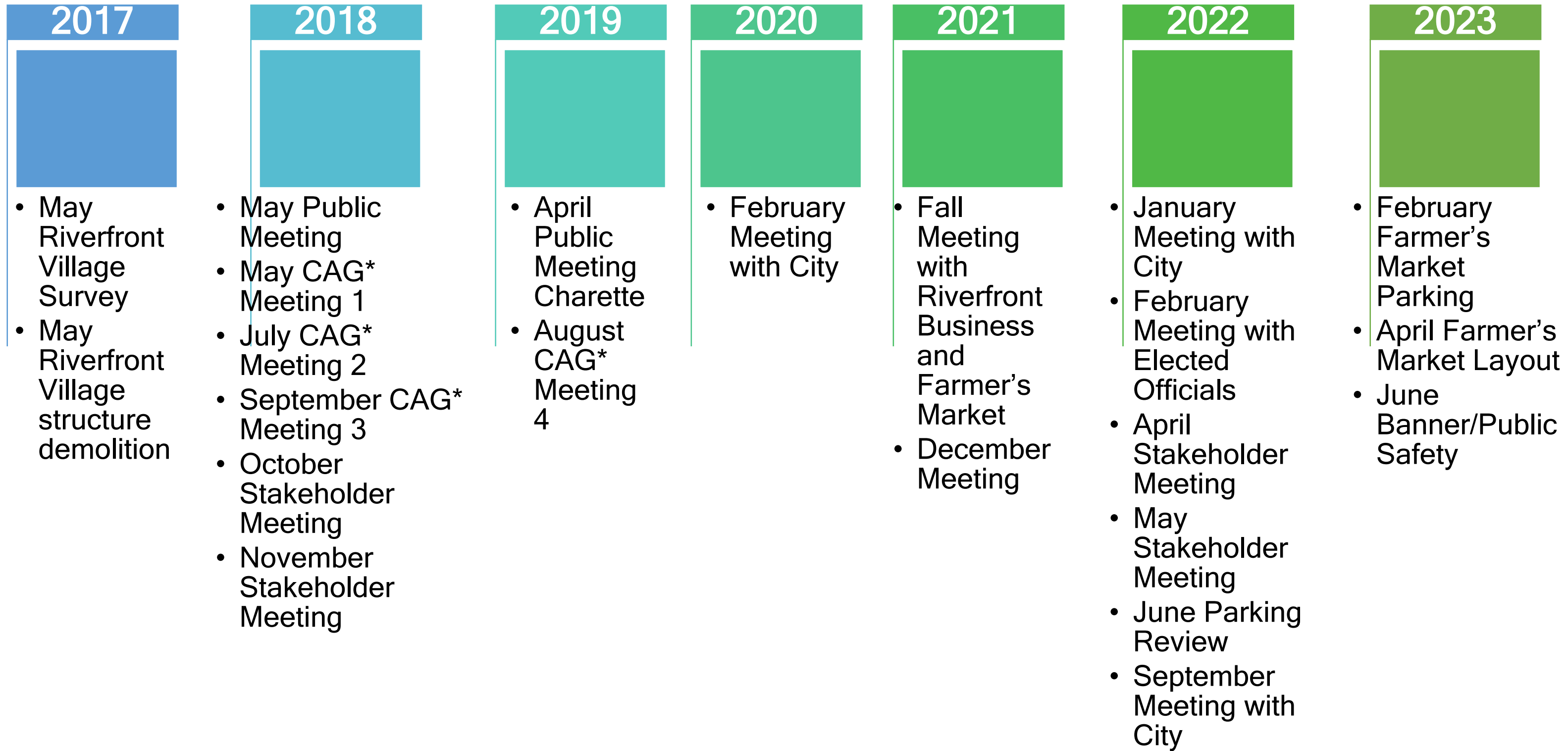

\*CAG (Community Advisory Group)



# RESILIENCY

## LAND



- Land efficiency / preservation
- New land dedicated to open space
- Open space dedicated for pedestrians

## WATER



- Stormwater management
- Water conservation
- Water quality
- Flood protection

## HABITAT



- Habitat creation, preservation, & restoration
- Habitat quality
- Population & species richness

## MATERIALS & WASTE



- Reused & recycled materials
- Waste reduction / management

## CARBON, ENERGY, & AIR QUALITY



- Energy use / efficiency
- Air quality
- Temperature & urban heat island effect
- Carbon sequestration & avoidance

## SOCIAL



- Recreational & social value
- Cultural preservation
- Health & well-being
- Safety / security
- Scenic quality & views
- Access & equality

## ECONOMIC



- Operations & maintenance plan
- Job creation
- Visitor spending
- Increased downtown tax revenue
- Economic development potential



# PEORIA RIVERFRONT PROGRAM

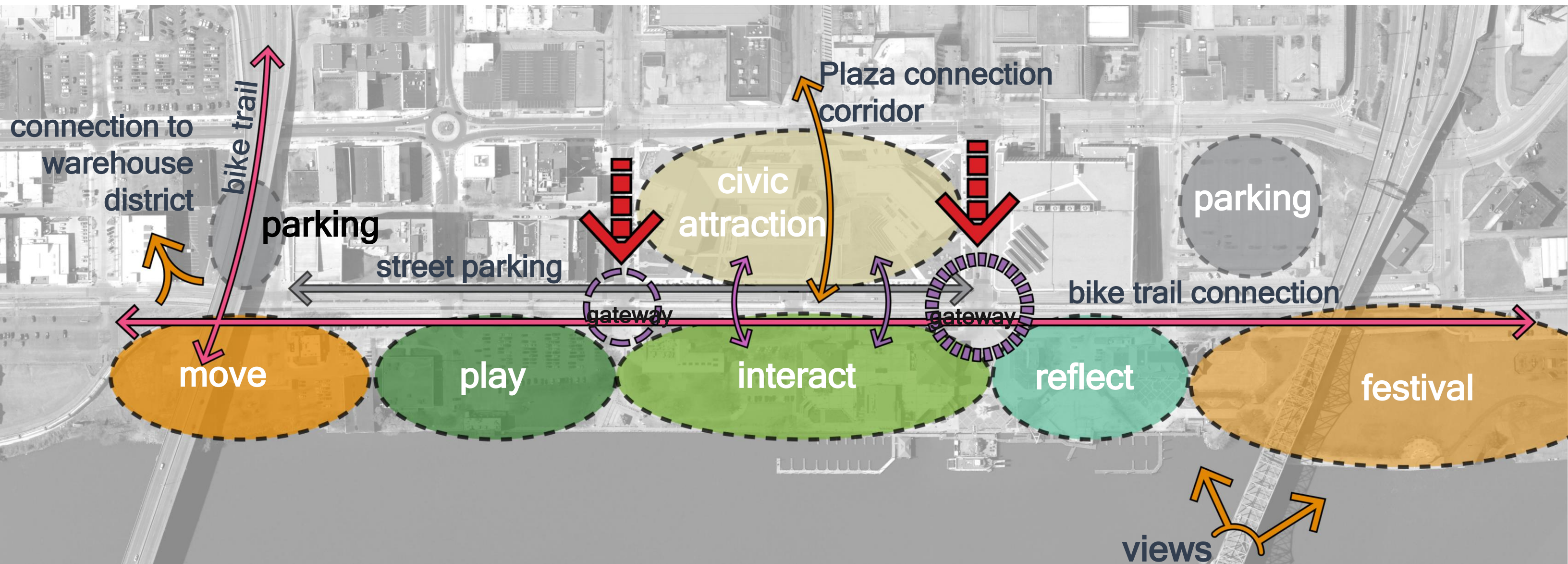



# PEORIA RIVERFRONT PROGRAM

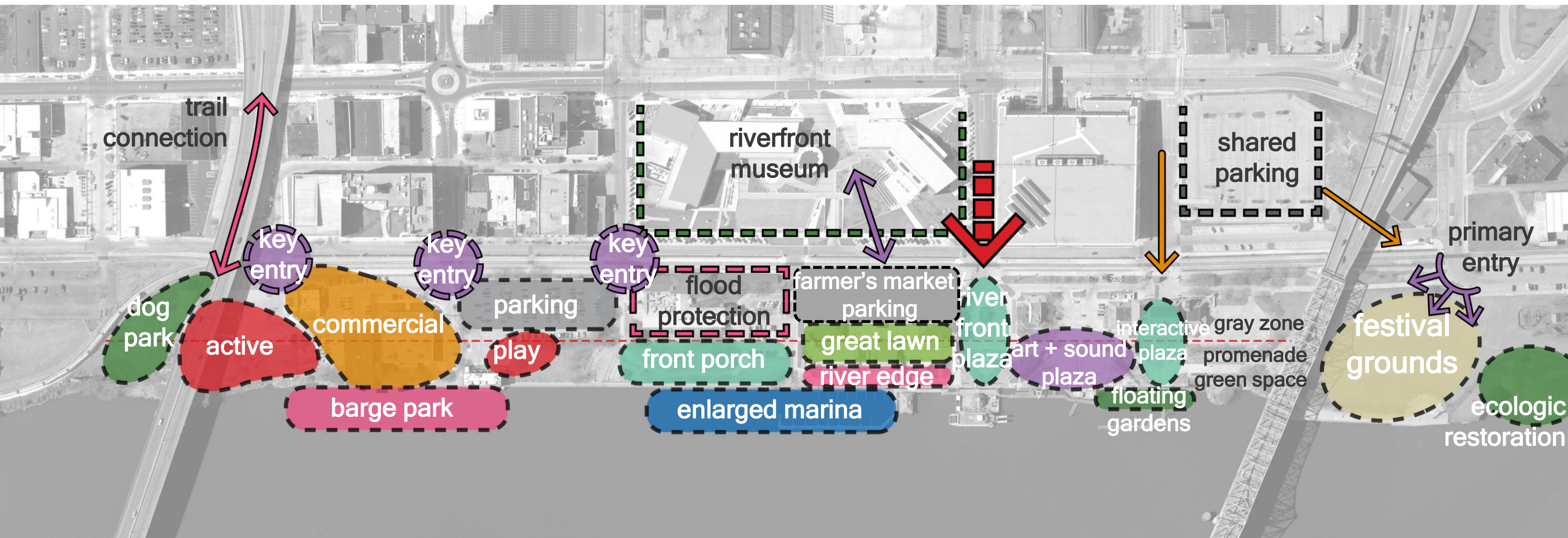



# PEORIA'S NEW RIVERFRONT PARK

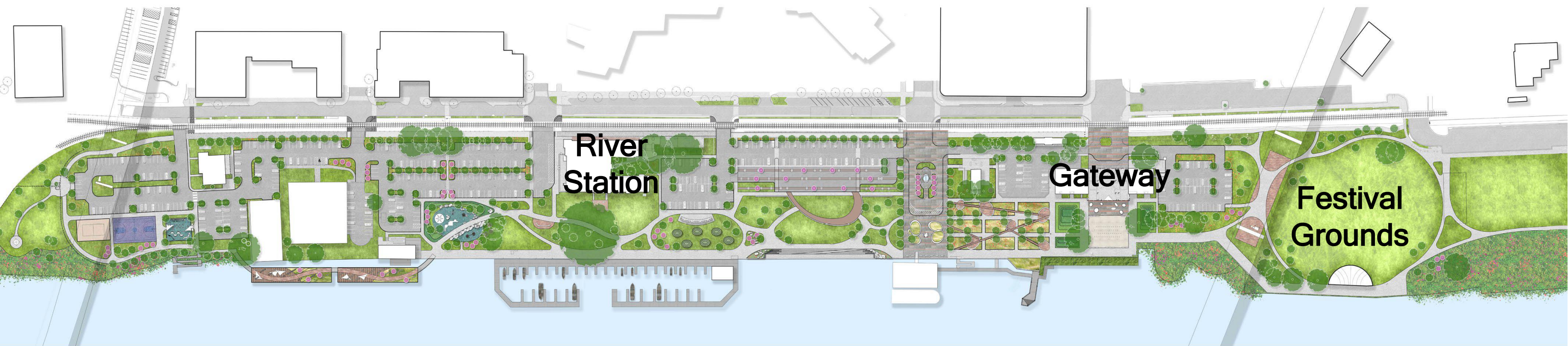



# PEORIA'S NEW RIVERFRONT PARK

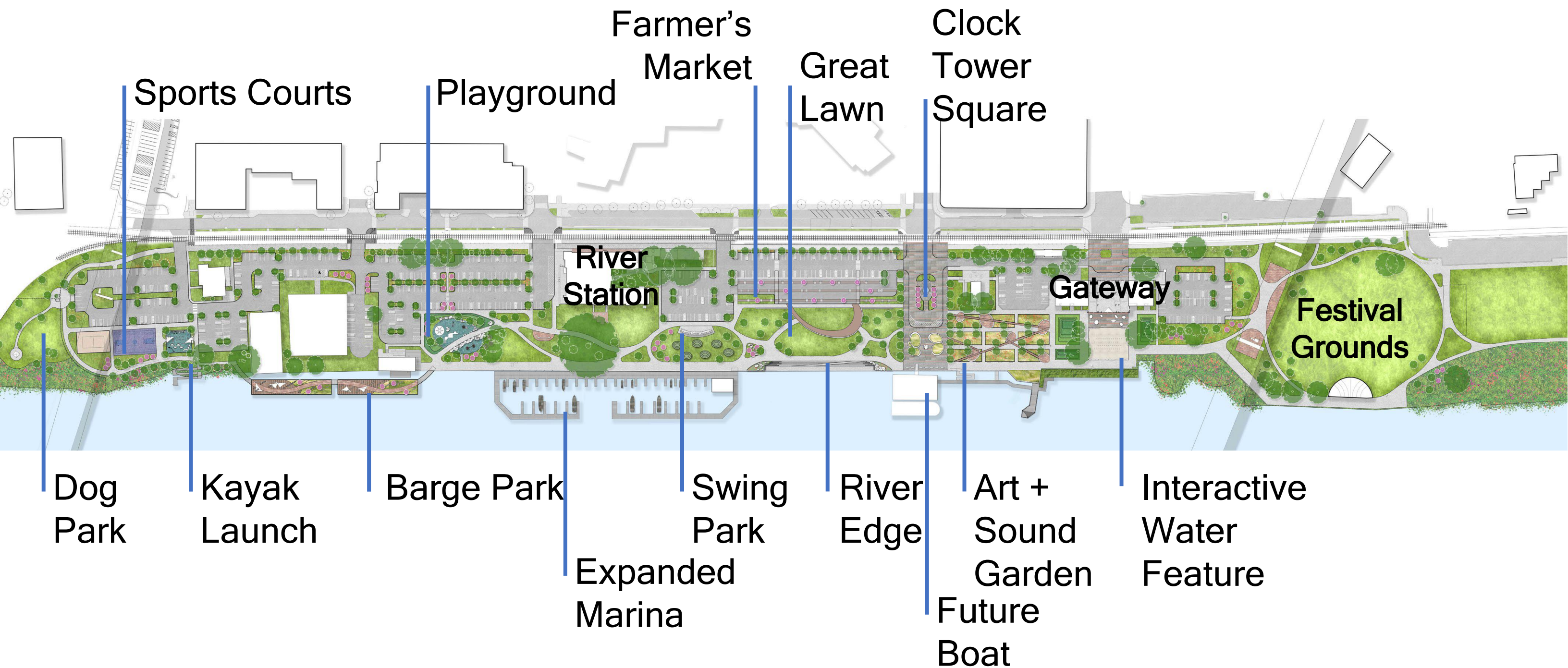



# 'INTERACT + PLAY' ENLARGEMENT VIEW

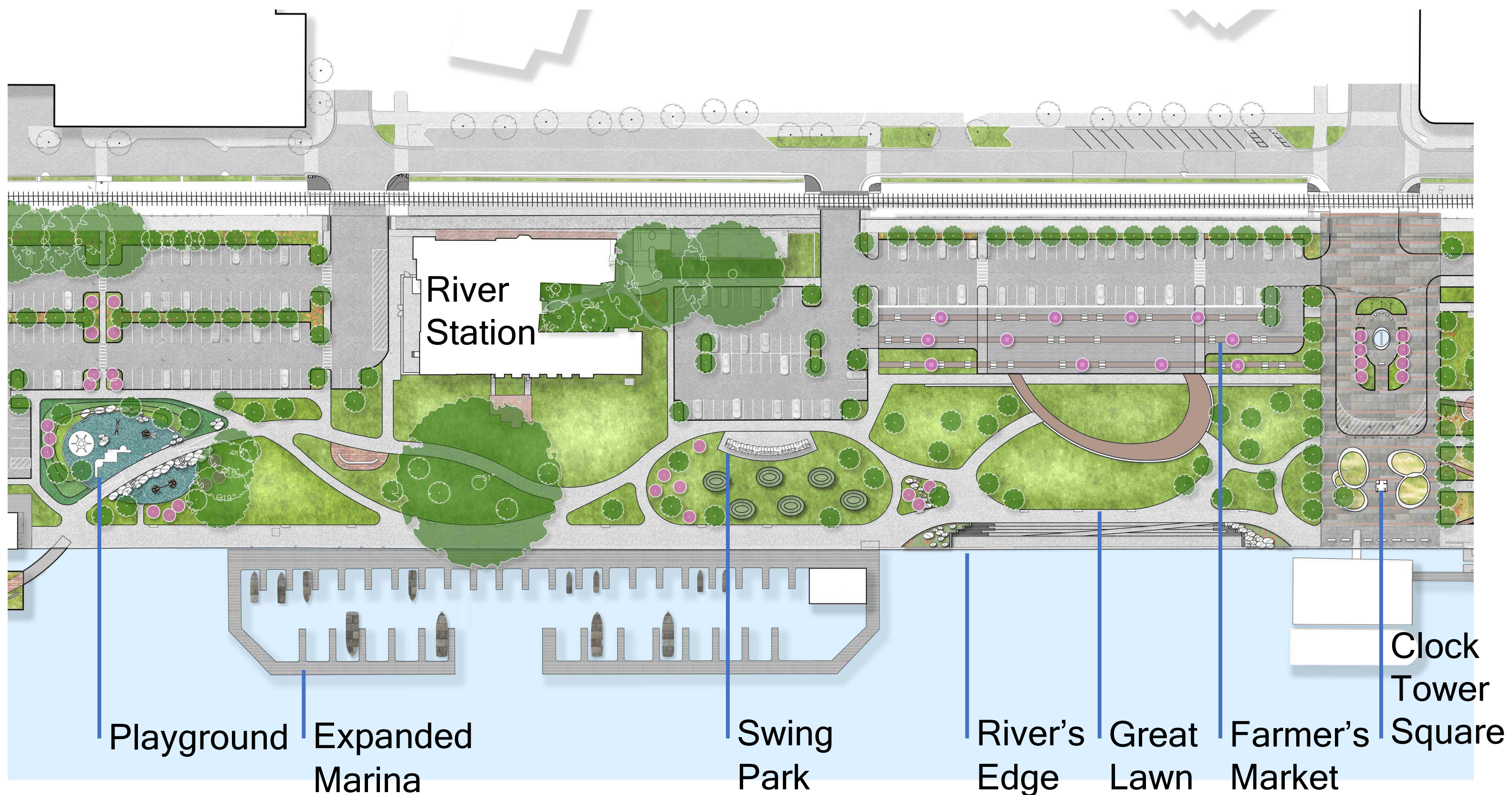



# GREAT LAWN & RIVER'S EDGE BIRD'S EYE VIEW





# RIVER'S EDGE VIEW





# FLEXIBLE RIVER PLAZA VIEW





# RIVER PLAZA WITH FARMERS MARKET VIEW





# FLEXIBLE RIVER PLAZA TABLES OUT

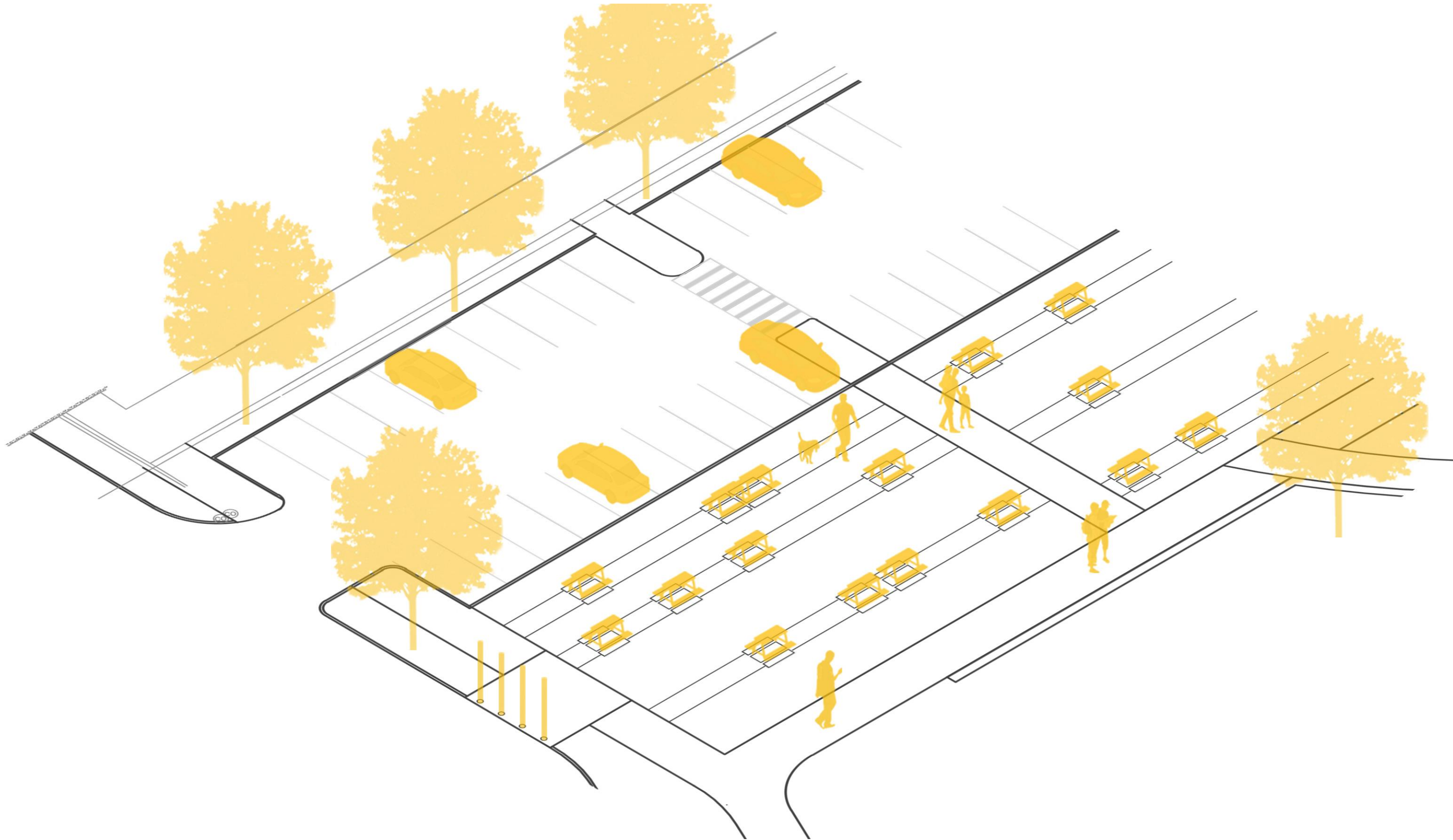



# FLEXIBLE RIVER PLAZA TABLES IN

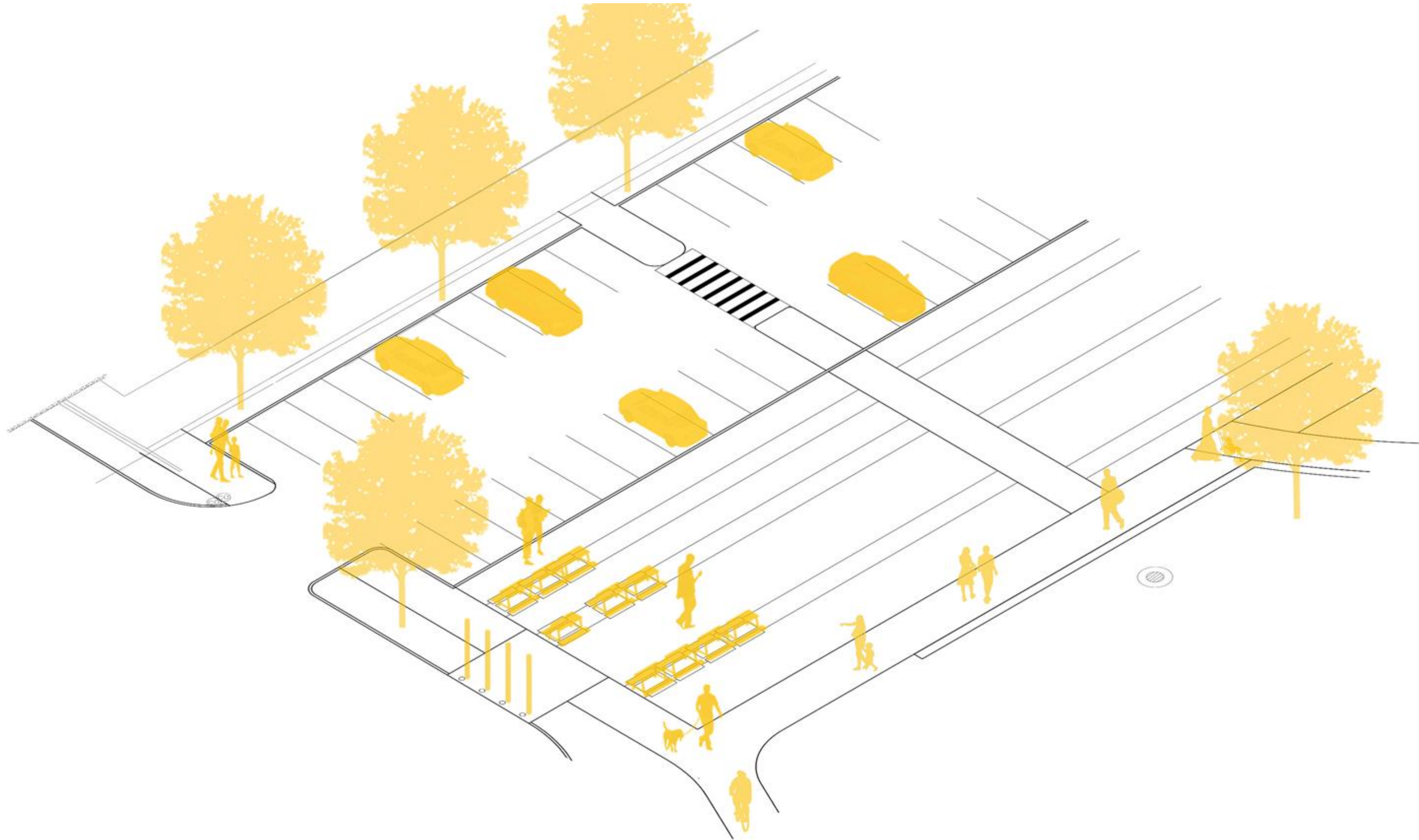



# SWING SEATING AT GREAT LAWN VIEW





# CLOCK TOWER PLAZA VIEW





# CLOCK TOWER PLAZA VIEW





# 'REFLECT' ENLARGEMENT PLAN

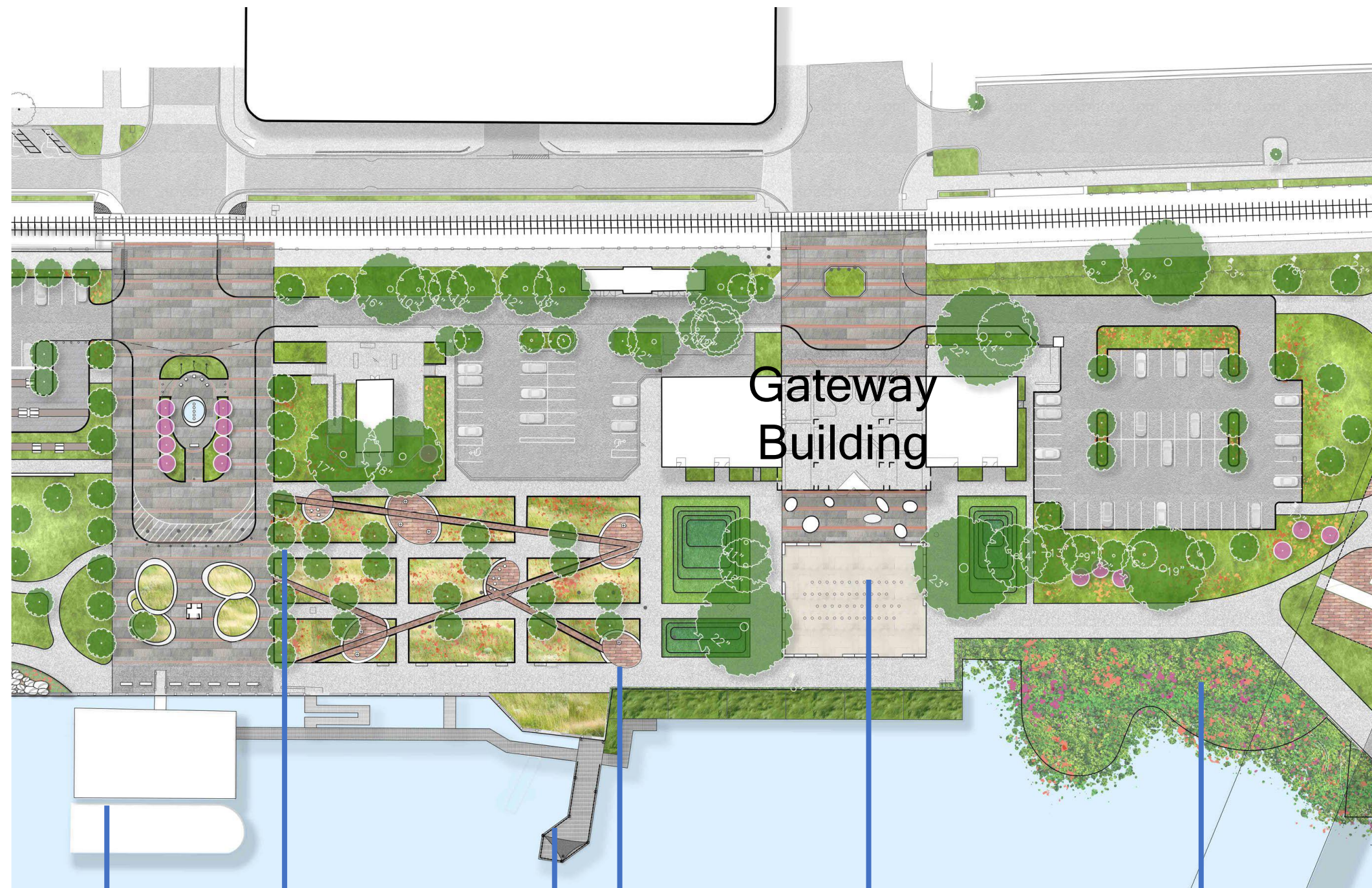

Future  
River  
Boat

Art +  
Sound  
Garden

Floating  
Island  
  
Observation Deck  
+ Protection Wall

Interactive  
Water Feature

Habitat  
Restoration



# ART + SOUND GARDEN VIEW





# INTERACTIVE FOUNTAIN VIEW





# 'FESTIVAL' ENLARGEMENT PLAN





# BAND SHELL VIEW

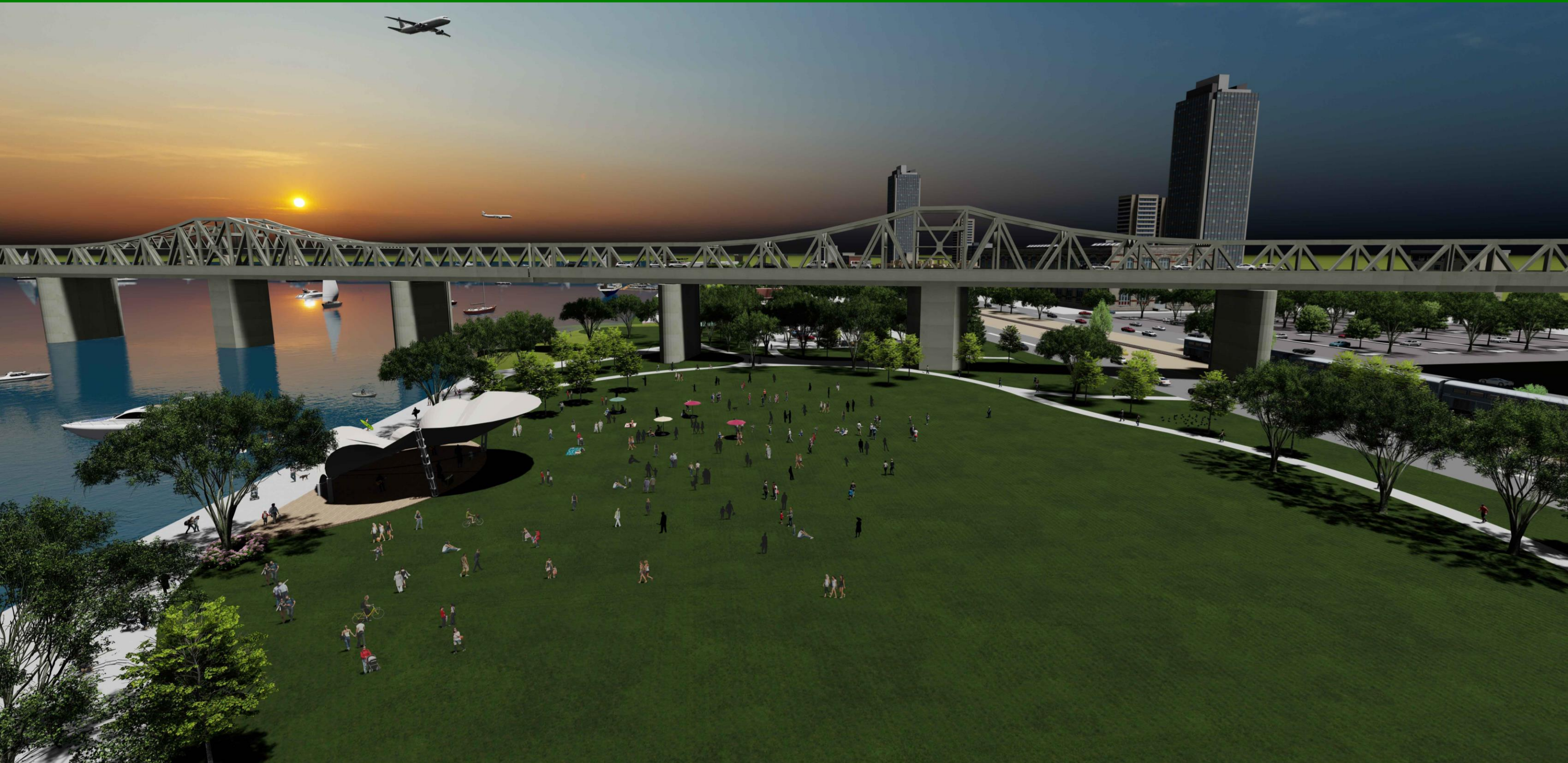



# 'MOVE' ENLARGEMENT PLAN

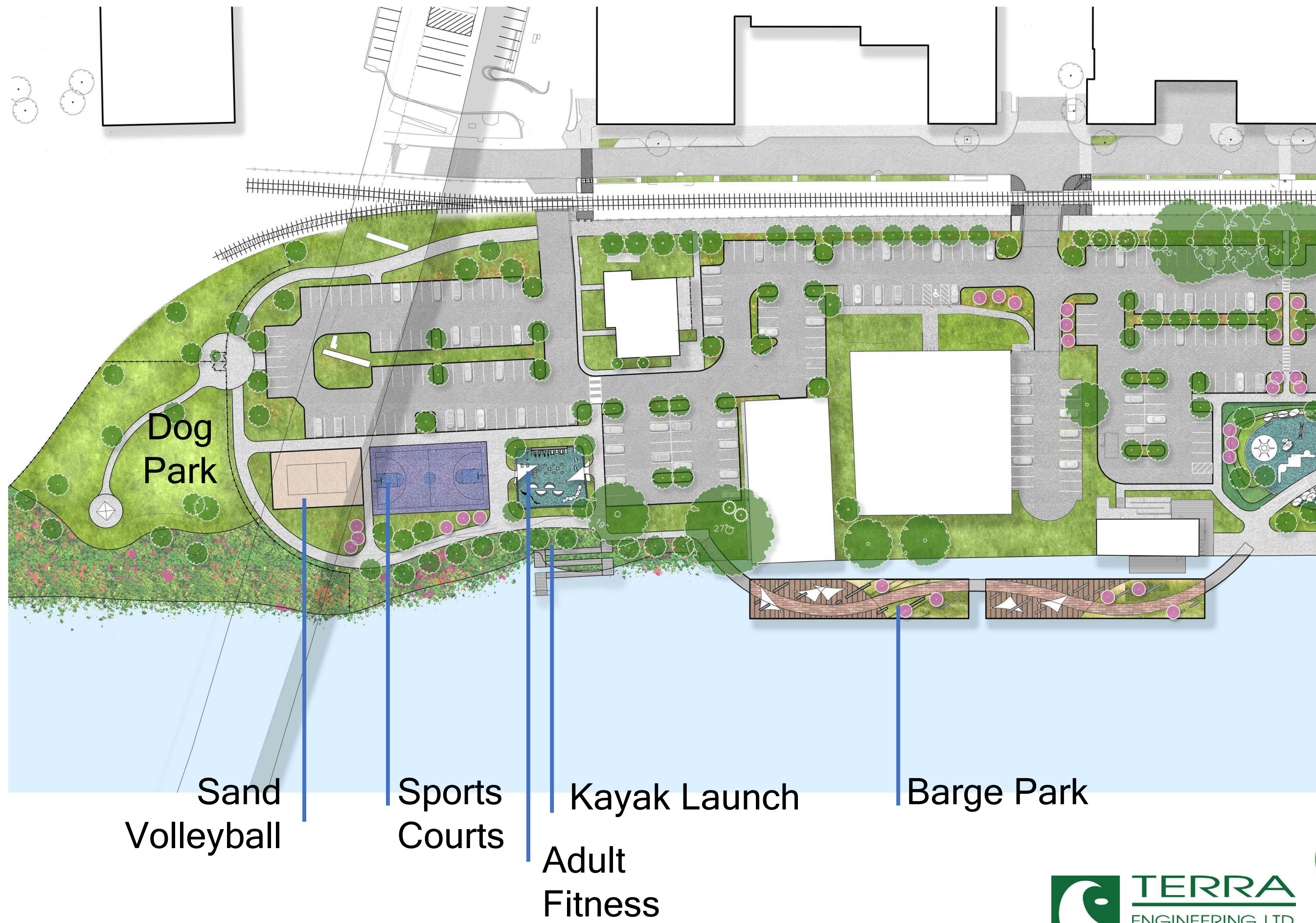



# PLAYGROUND VIEW





# BARGE PARK VIEW





# ADULT OUTDOOR FITNESS STATION





# BIRD'S EYE VIEW OF PEORIA RIVERFRONT PARK





# FLOOD WALL PROTECTION

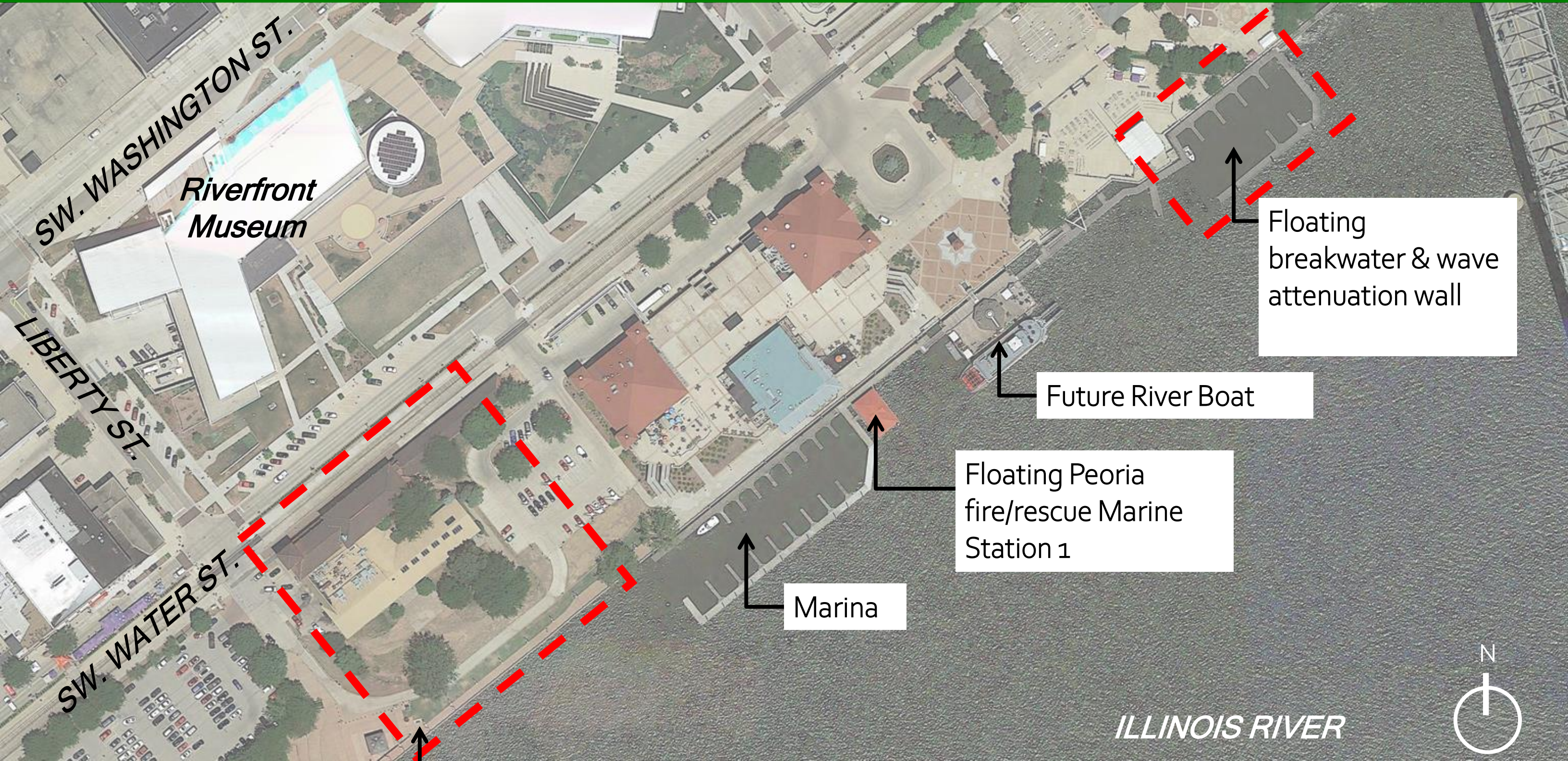

Removable flood wall to protect historic railroad Depot Building



# FLOOD WALL PROTECTION

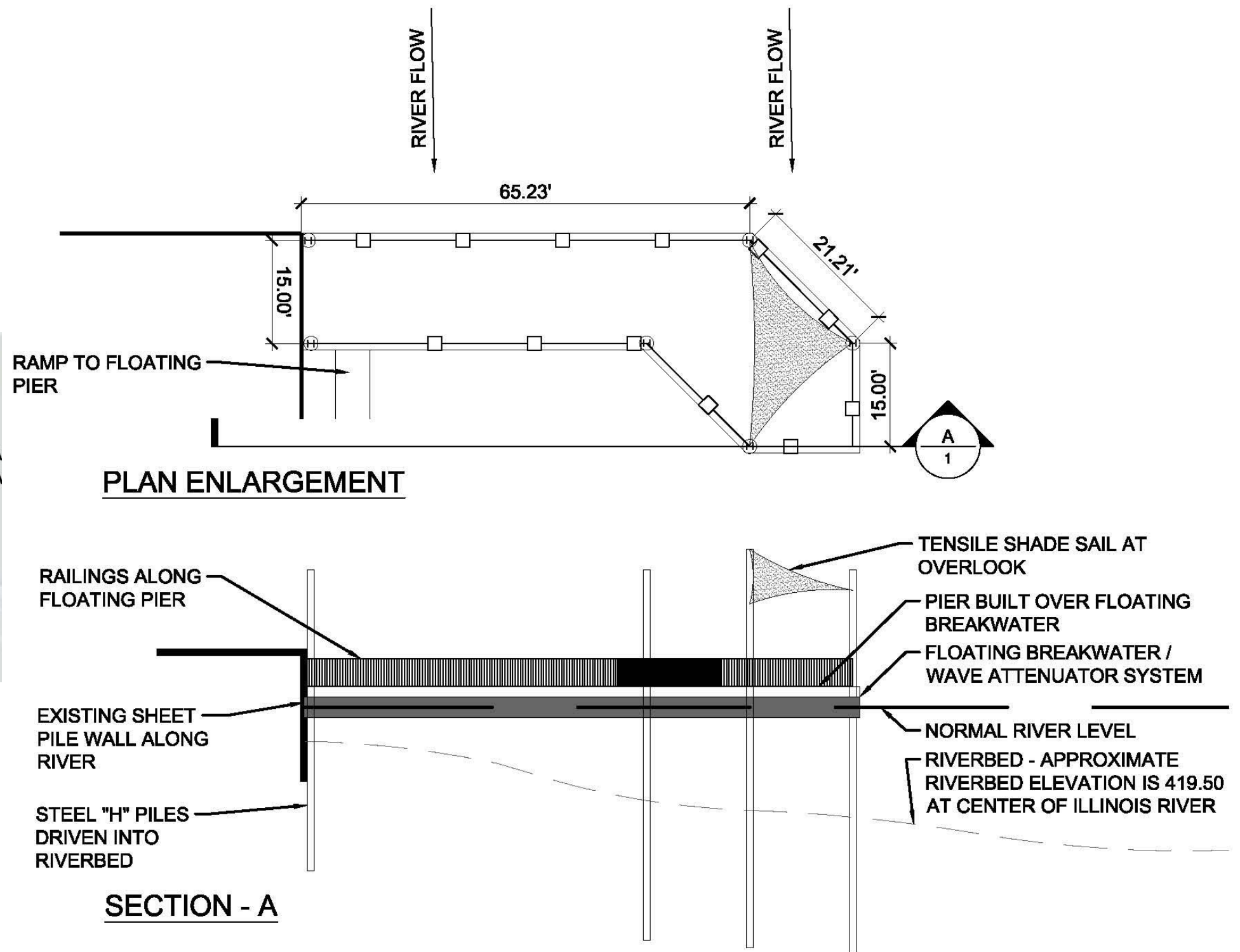
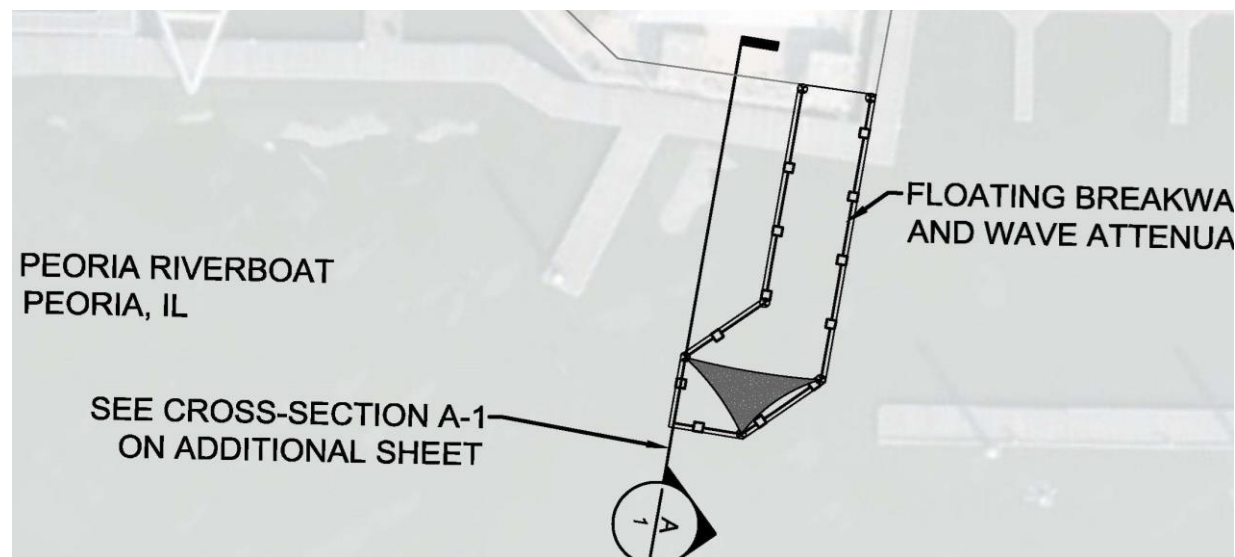



# FLOOD WALL PROTECTION









# PARKING STUDY - RIVERFRONT PARKING

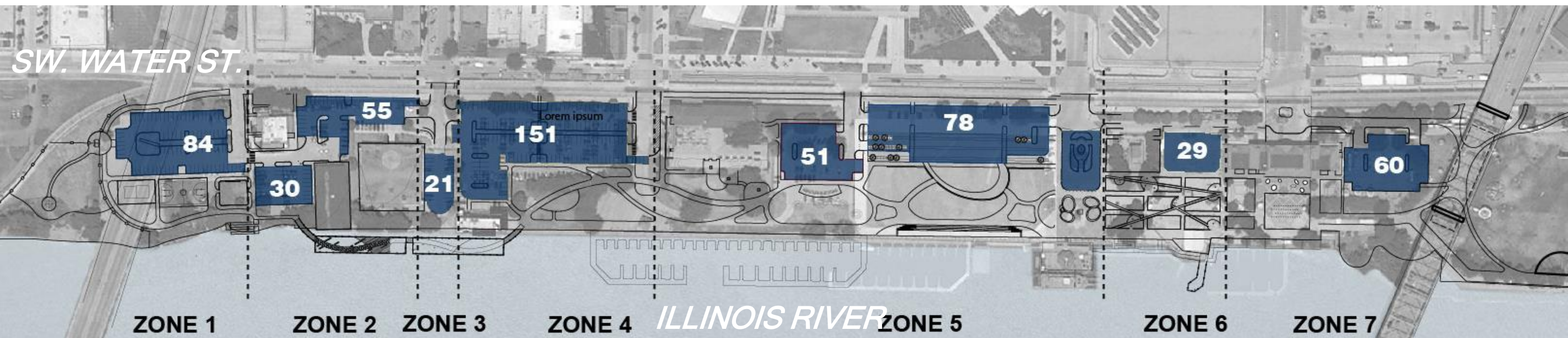

## Riverfront Parking Count

<u>Parking Zone</u>	<u>Existing</u>	<u>Proposed</u>	<u>Net Change</u>
Zone 1	103	84	-19
Zone 2	89	85	-4
Zone 3	21	21	0
Zone 4	171	151	-20
Zone 5**	136	129	-7
Zone 6	29	29	0
Zone 7*	0	60	60
Total	549	559	10



# PARKING STUDY MAY 2022

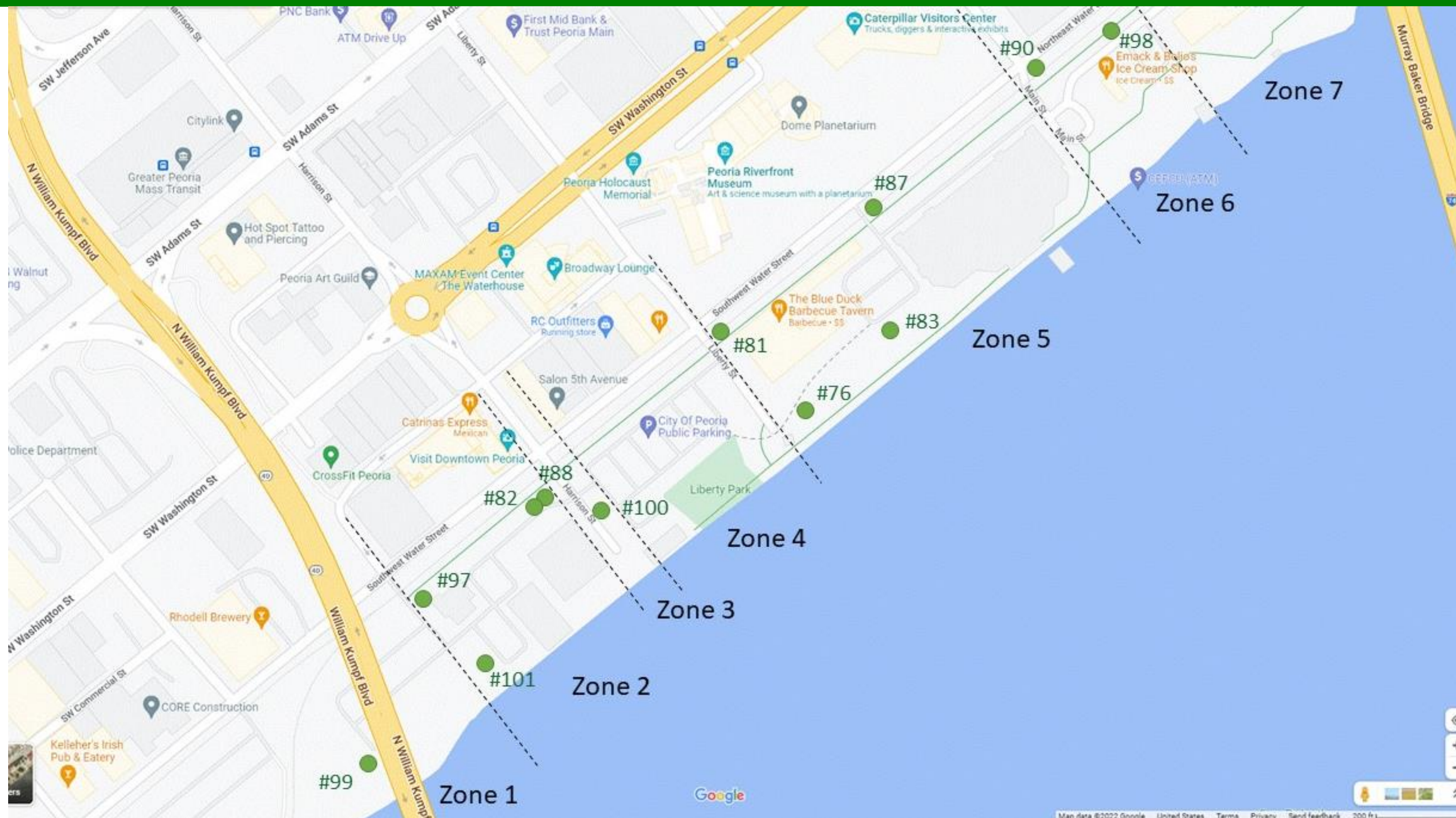

● Camera locations for riverfront market



# SAFETY AND SECURITY

“

According to a systematic review of research on the relationship between violent crime and urban green space, the presence of parks and other green space reduces urban crime.

Potential causes include the role of green spaces in social interaction and recreation, their ability to affect community perception, their role in biophilic stress reduction and climate modulation, and their ability to indicate community ownership.

*-International Journal of Environmental Research and Public Health*

Studies support  
green parks to  
reduce crime

Improved  
lighting

Security  
cameras

Contact with nature reduces precursors to crime like stress and aggression, making people feel happier and less inclined to engage in criminal acts.

*-Can Parks Help Fight Crime? NC State University*

”





# BIRD'S EYE VIEW OF PEORIA RIVERFRONT PARK



Resilient design to withstand seasonal flooding



18.5 acres green amenity space



4 miles of walking/running paths



+900 trees for cooling & air quality



Green infrastructure for improved water quality





# PEORIA RIVERFRONT

COMMENTS & QUESTIONS?



**TERRA**  
ENGINEERING LTD.





# EXISTING BUILDING & PARKING COVERAGE

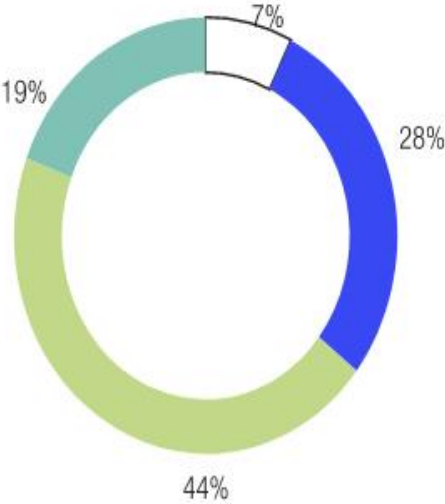
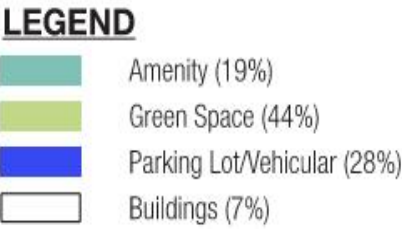



PROPOSED BUILDING & PARKING COVERAGE



- LEGEND**
- Amenity (26%)
  - Green Space (43%)
  - Parking Lot/Vehicular (20%)
  - Buildings (7%)

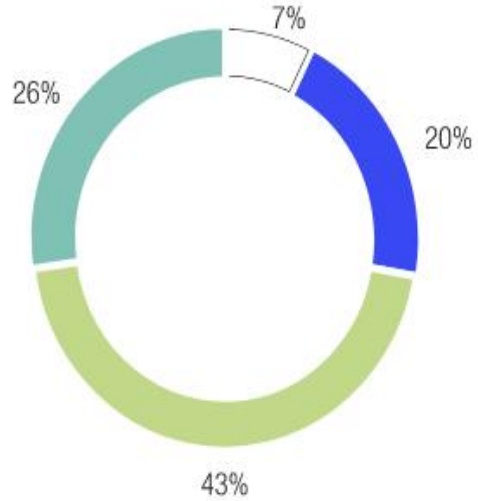



# PARKING | TOTAL ZONES 1, 2, 4, AND 5\*

\*Lot 3 (20 spaces) was excluded due to gated/employee lot

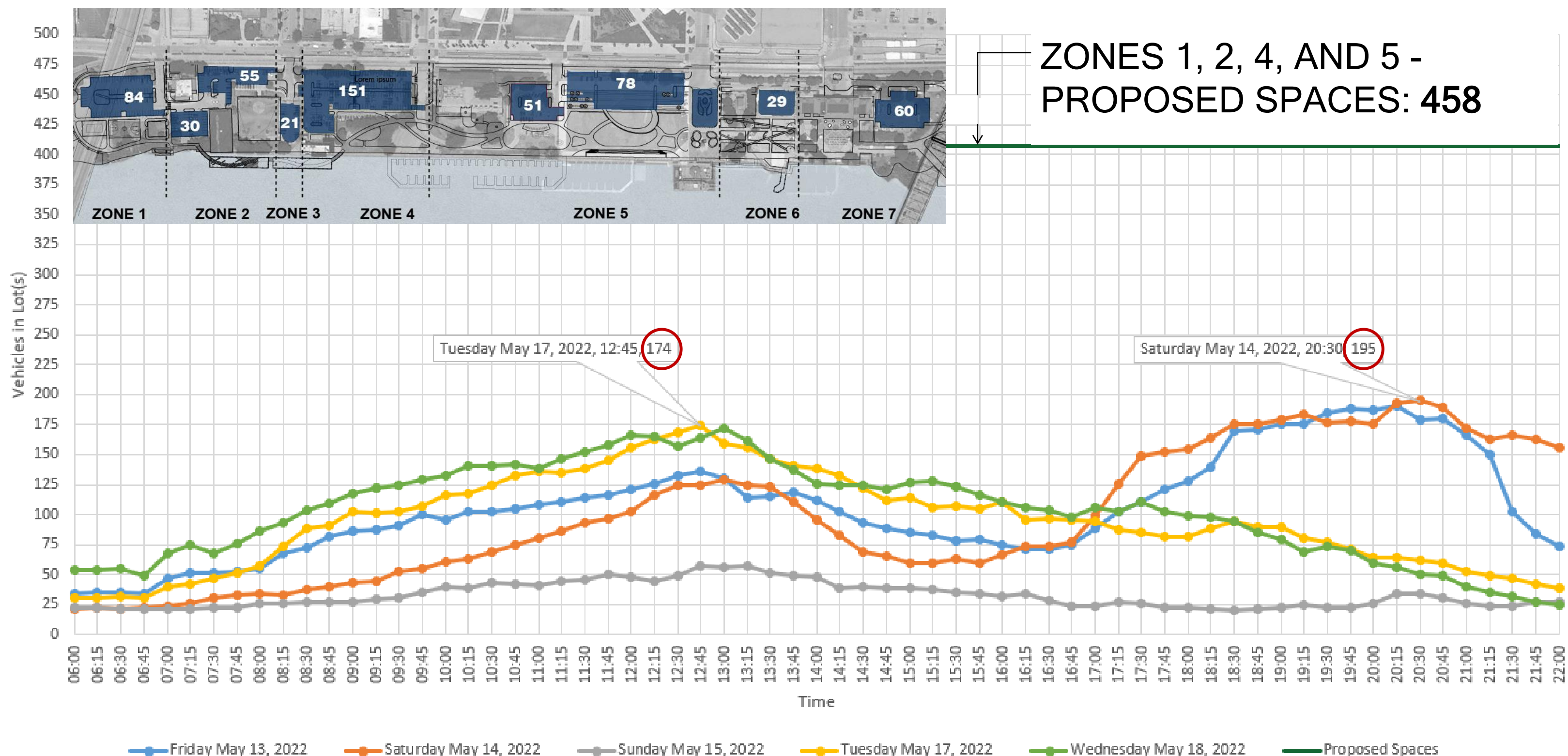



# PARKING | ZONE 1 AND 2

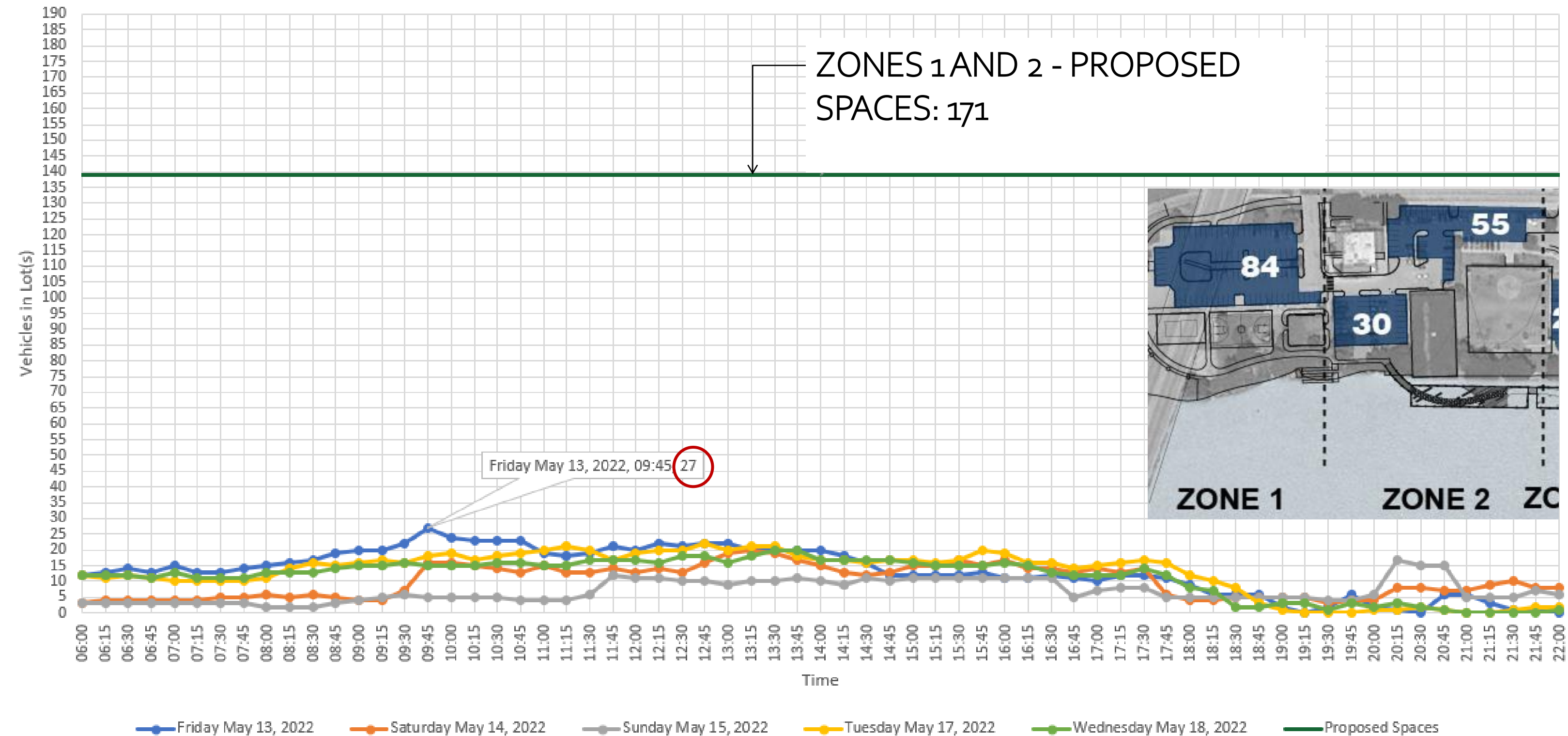



# PARKING | ZONE 4

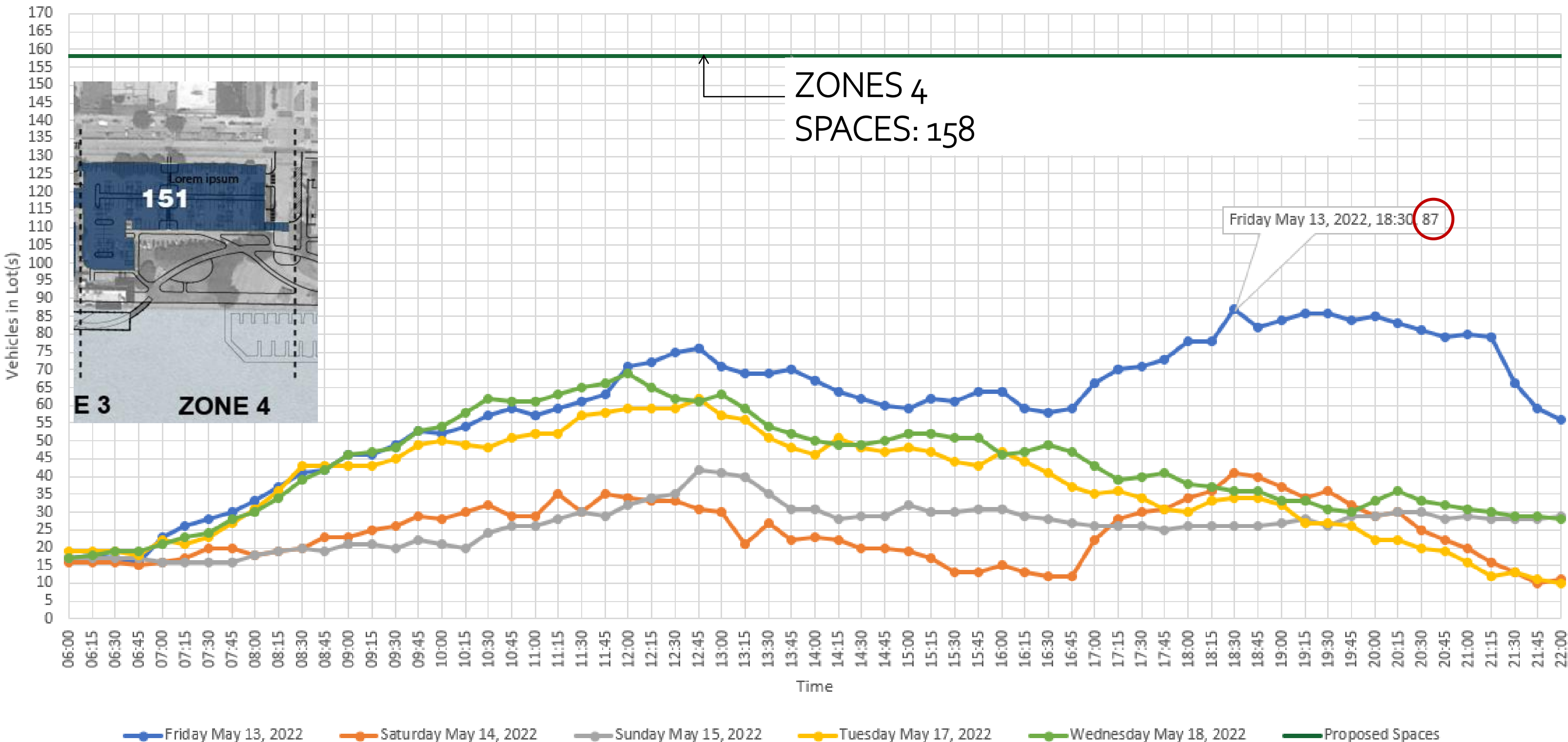



# PARKING | ZONE 5

